

SERVICE ELECTRIC CABLE TV INC.

JOHN G. & SOPHIA M. LAZAR

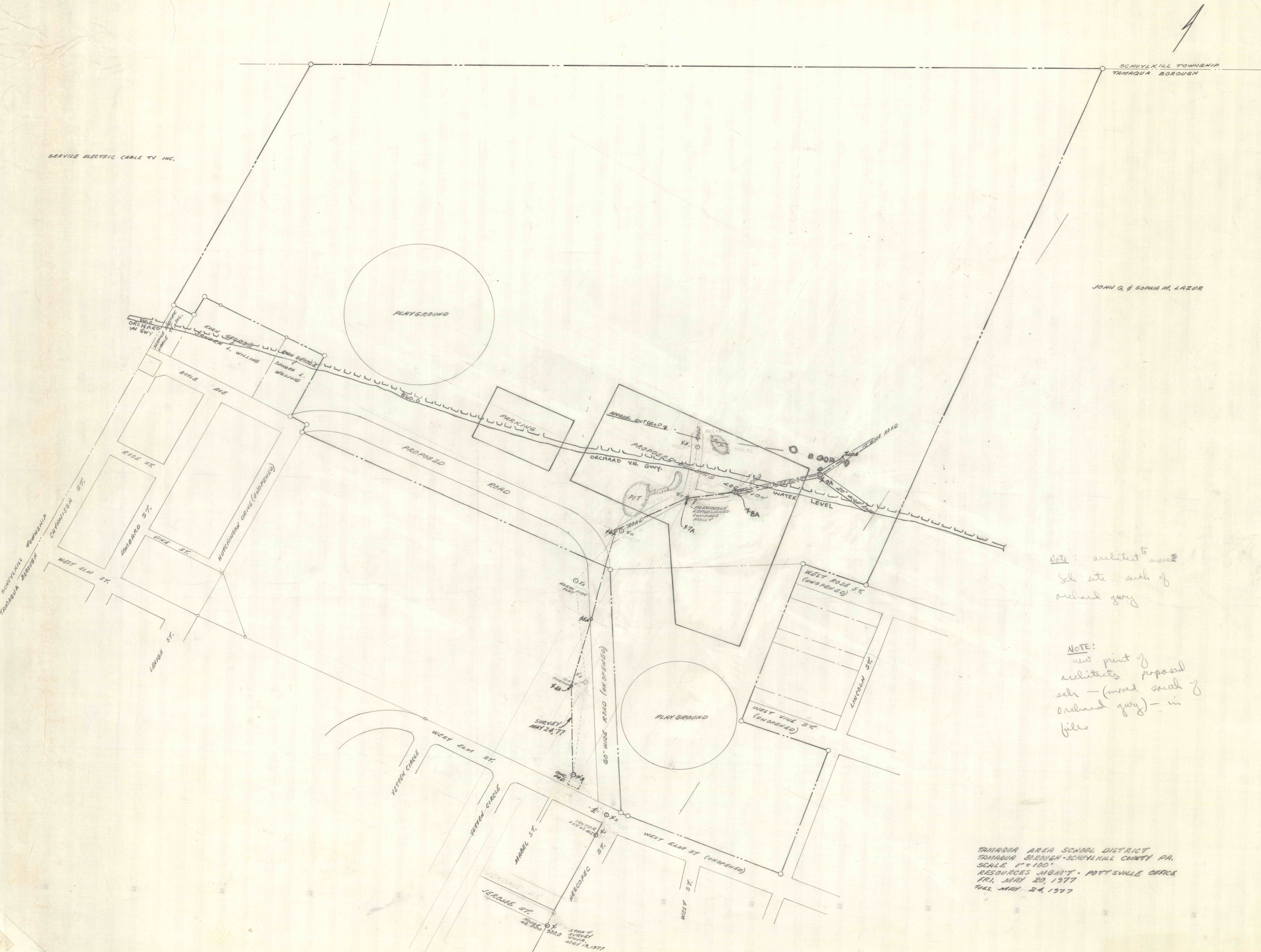

Note: architect to move  
site south of  
orchard gwy

NOTE:  
new print of  
architects proposed  
site - (moved south of  
orchard gwy) - in  
files

TAMAQUA AREA SCHOOL DISTRICT  
TAMAQUA BOROUGH - SCHUYLKILL COUNTY PA.  
SCALE 1" = 100'  
RESOURCES MGMT - POTTSVILLE OFFICE  
FRI, MAY 20, 1977  
TUES, MAY 24, 1977