

CROSS SECTION "I"  
ON COORDINATE LINE... EAST 1000

GIRARD COLLIERY..  
HAZLE BROOK COAL Co.

SCALE: 1"=100'... ENG. DEPARTMENT... OCT. 21, 1926.

HAZLETON, PA., TRACED BY: ALEX. DROZDA, JR.  
7 SEPT. 1972.

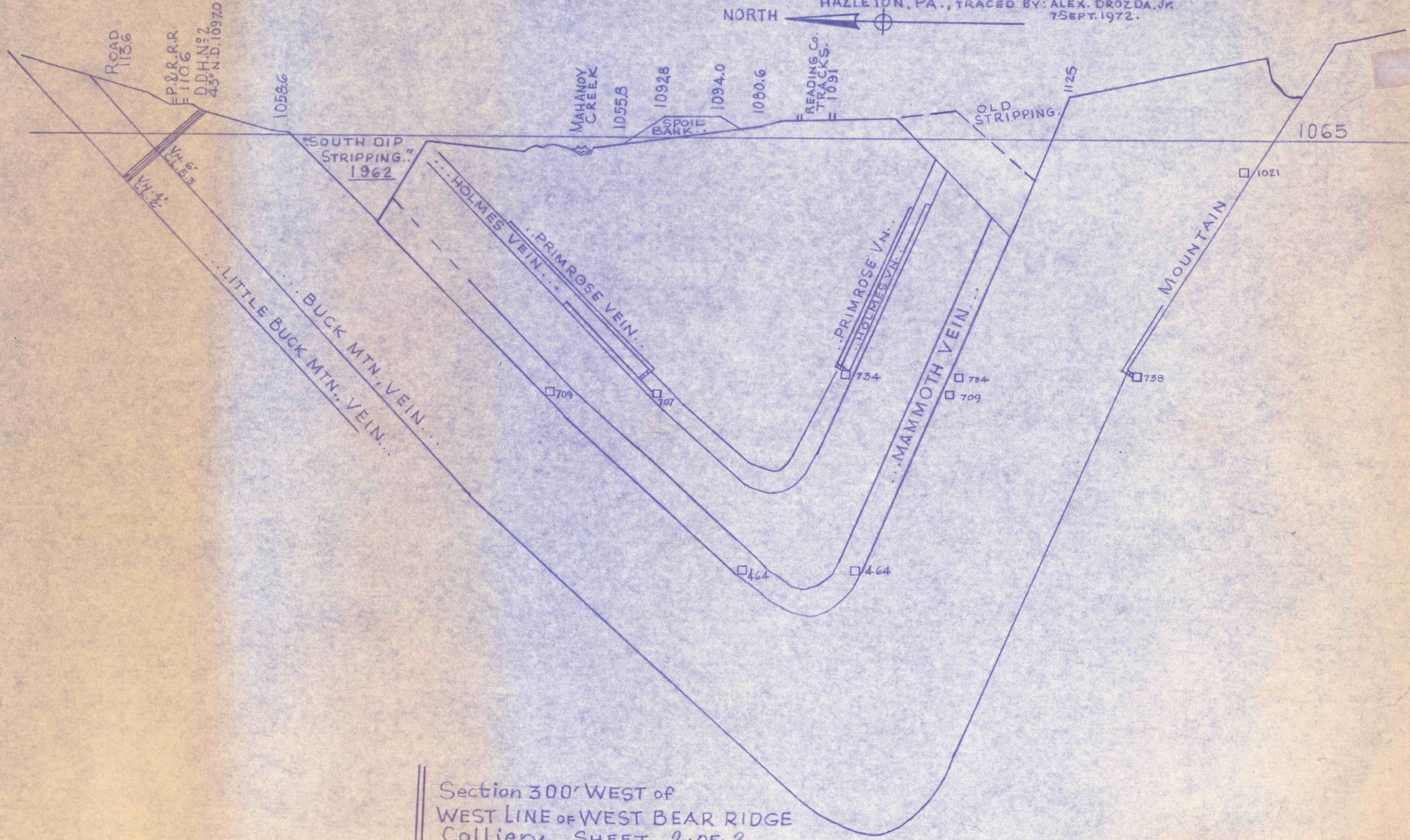

Section 300' WEST of  
WEST LINE OF WEST BEAR RIDGE  
Colliery... SHEET... 2 OF 2.