

SEE SHEET NO. 7

SEE SHEET NO. 9

Reference BH 7
N 59° 02' 10" E

1700
1000
85000

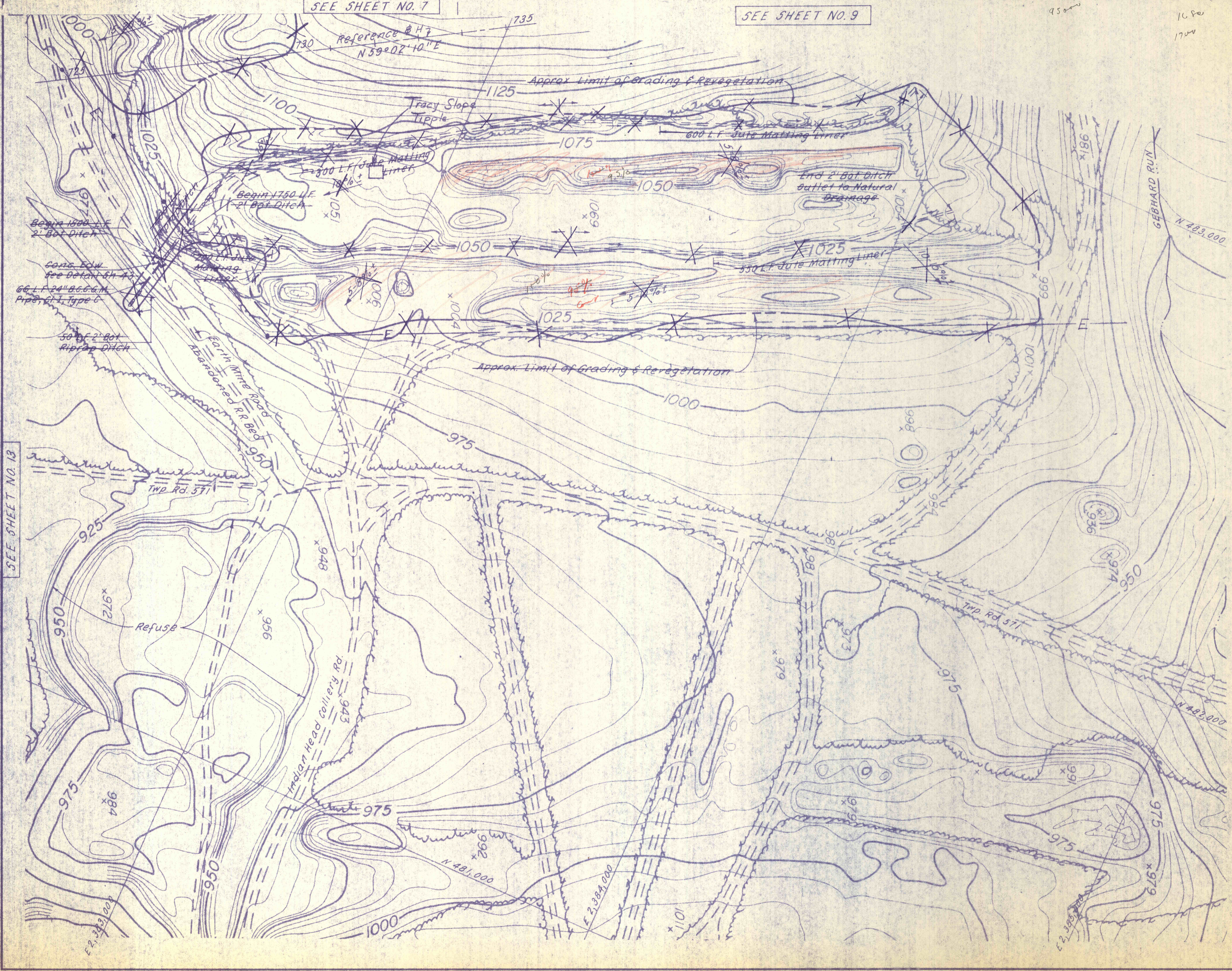
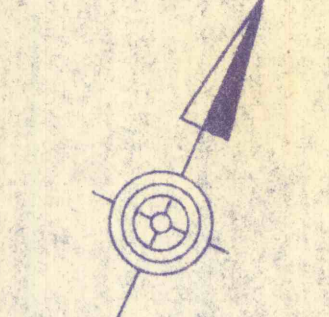

SEE SHEET NO. 13

For Grading Sections
See Sheet No. 37

NO.	DATE	REVISION	APPR.
SUBMITTED	Norman E. Mutchler		
APPROVED	Alfred A. Roman		
APPROVED	M. P. ...		



COMMONWEALTH OF PENNSYLVANIA
DEPARTMENT OF ENVIRONMENTAL RESOURCES
OFFICE OF ENGINEERING AND CONSTRUCTION

PROJECT NO. SL-126-2-7

MINE DRAINAGE
POLLUTION ABATEMENT
SWATARA CREEK WATERSHED
SCHUYLKILL COUNTY

BERGER ASSOCIATES, INC.
Consulting Engineers

P.O. Box 1943 Harrisburg, Penna.

PLAN
STRIP MINE RECLAMATION

DRAWN BY W.G.	DATE APR. 17, 1973	DRAWING NO. 14 of 43
CHECKED BY T.T.	SCALE 1" = 100'	

Rev. 7/15/74