

TYPICAL SECTION
LOWER GEBHARD RUN CHANNEL RELOCATION
Scale: 1" = 5'
Sta. 900+00 to Sta. 906+08.39

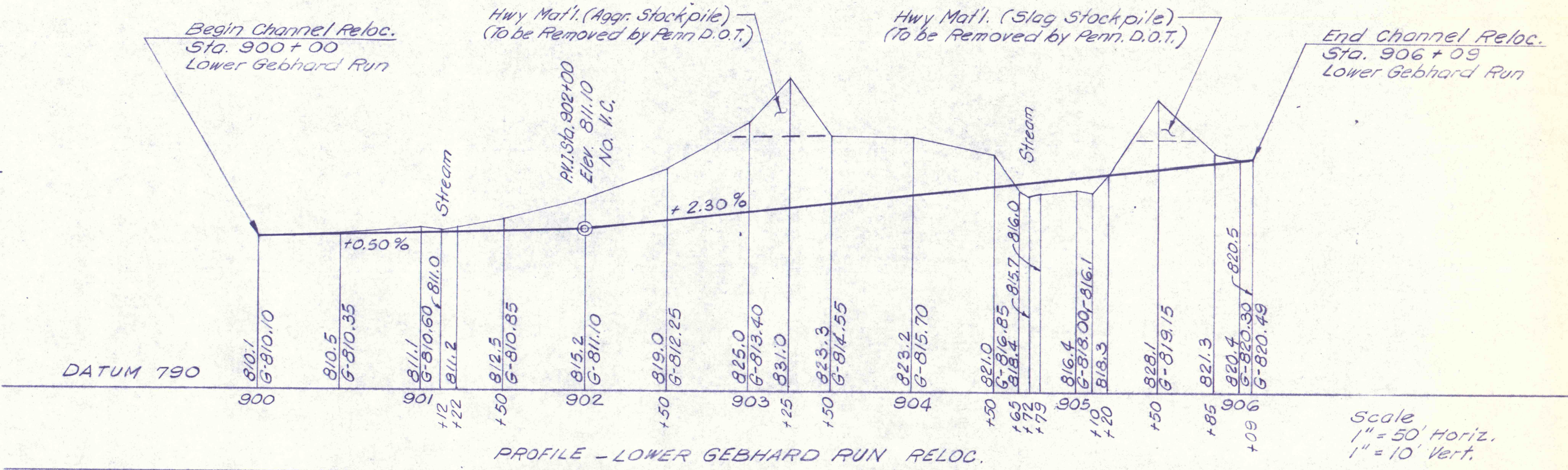

PROFILE - LOWER GEBHARD RUN RELOC.
Scale: 1" = 50' Horiz., 1" = 10' Vert.

Constr. Δ
P.I. Sta. 901+34.89
 $\Delta = 30^\circ 11' 41''$ Lt.
 $D = 11^\circ 27' 33''$
 $T = 134.89'$
 $L = 263.50'$
 $R = 500.00'$
 $E = 17.86'$
P.C. Sta. 900+00.00
P.T. Sta. 902+63.50

Constr. Δ
P.I. Sta. 905+01.79
 $\Delta = 24^\circ 49' 37''$ Rt.
 $D = 11^\circ 27' 33''$
 $T = 110.06'$
 $L = 216.66'$
 $R = 500.00'$
 $E = 11.97'$
P.C. Sta. 903+91.73
P.T. Sta. 906+08.39

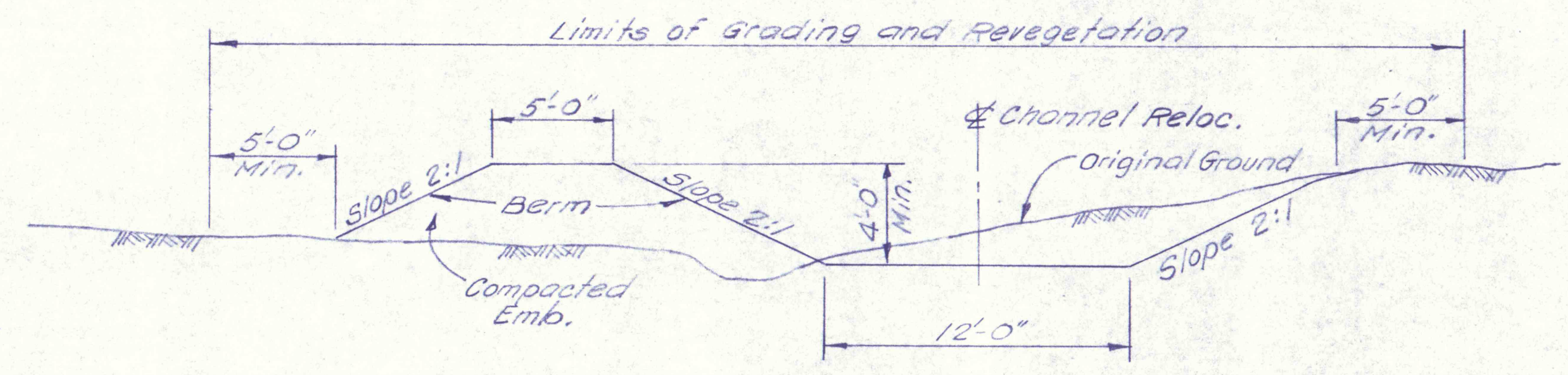

TYPICAL SECTION
GEBHARD RUN CHANNEL RELOCATION
Scale: 1" = 5'
Sta. 910+00 to Sta. 914+00

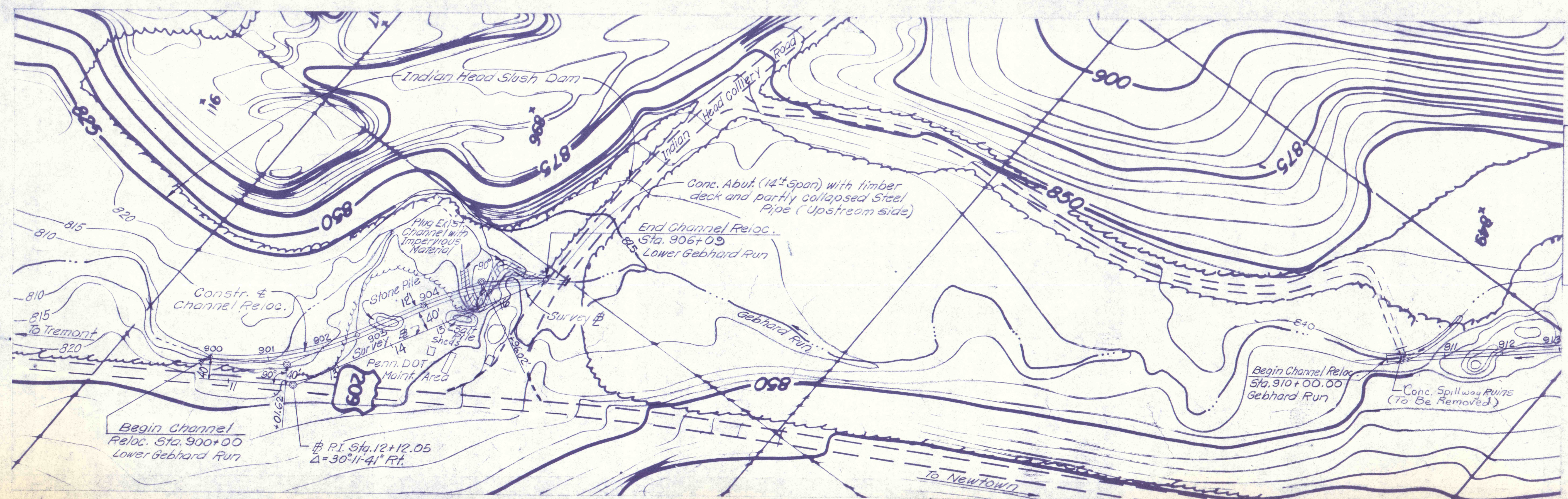

Scale: 1" = 100'

NO.	DATE	REVISION	APPR.
SUBMITTED			
PROFESSIONAL			
APPROVED			
CHIEF - DIVISION OF MINE REHABILITATION			
APPROVED			
DIRECTOR - BUREAU OF CONSULTING SERVICES			
SEE SHEET NO. 18			
COMMONWEALTH OF PENNSYLVANIA DEPARTMENT OF ENVIRONMENTAL RESOURCES OFFICE OF ENGINEERING AND CONSTRUCTION			
PROJECT NO. SL-126-2-7			
MINE DRAINAGE POLLUTION ABATEMENT SWATARA CREEK WATERSHED SCHUYLKILL COUNTY			
BERGER ASSOCIATES, INC. Consulting Engineers P.O. Box 1943 Harrisburg, Penna.			
PLAN AND PROFILE LOWER GEBHARD RUN RELOC.			
DRAWN BY	DATE	DRAWING NO.	
J. S.	Mar. 13, 1973		
CHECKED BY	SCALE		
M. W.	As Shown		17 of 40