

CROSS SECTION 5 ST

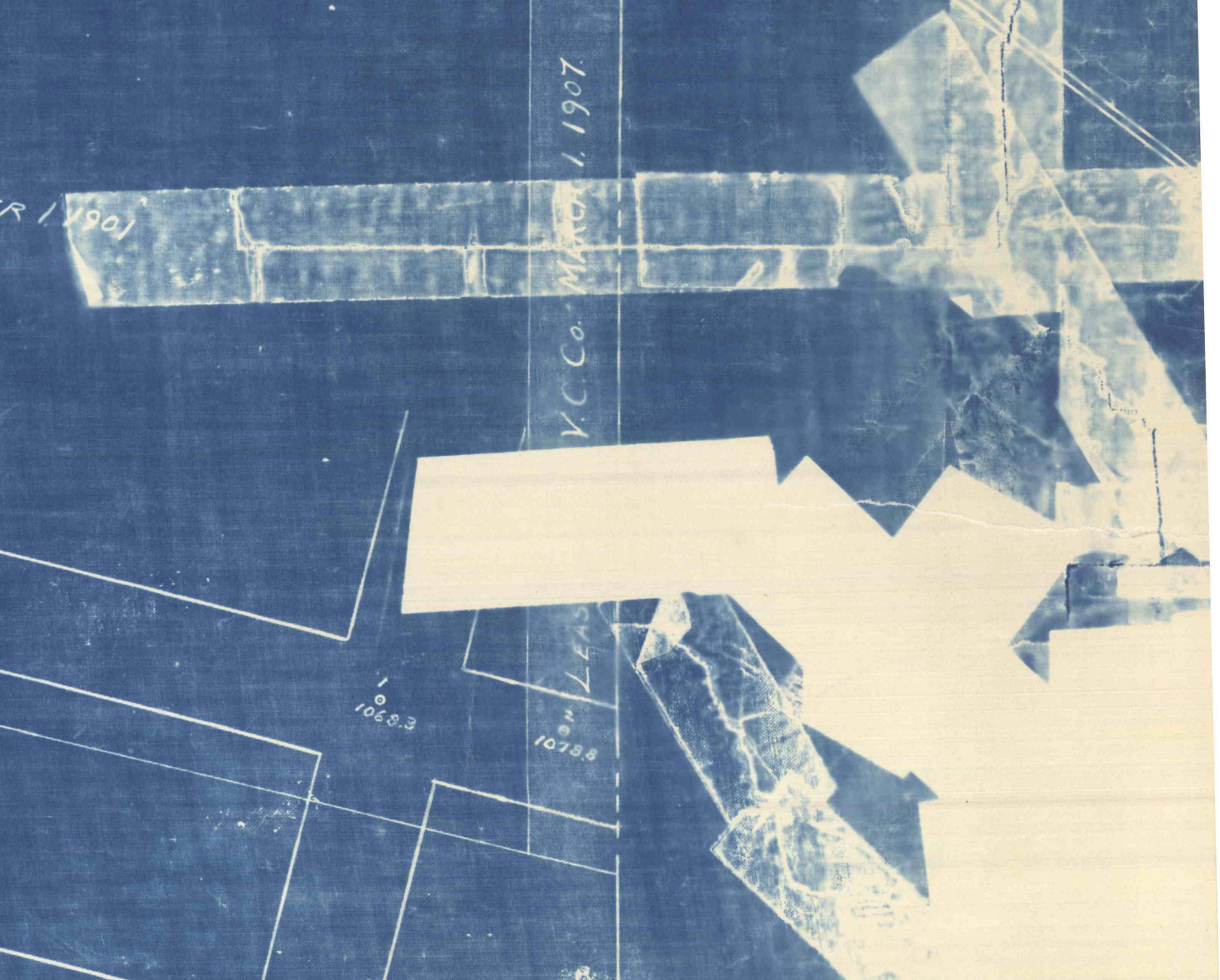
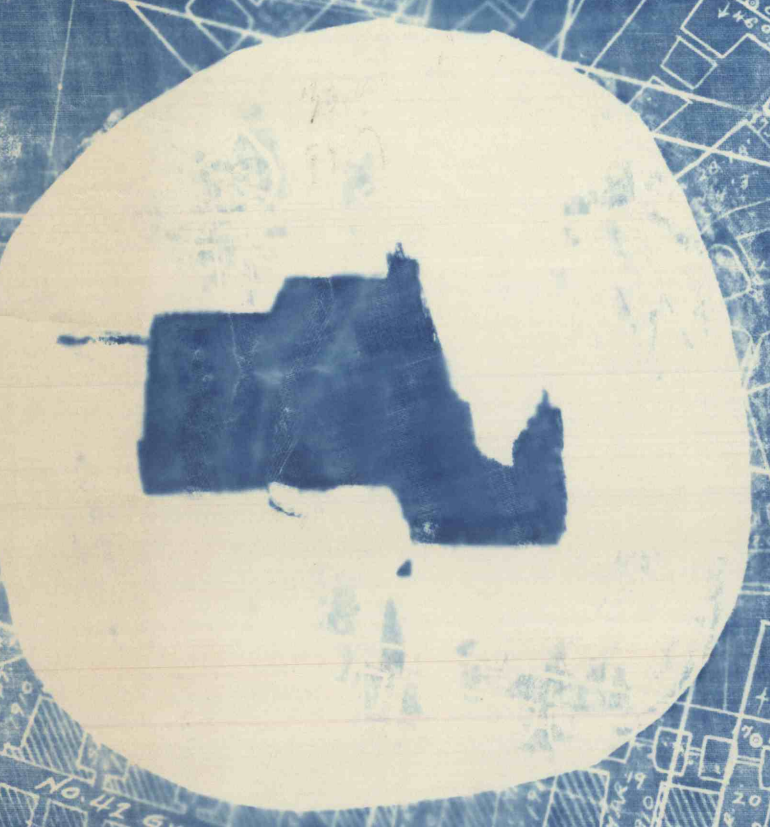

SOUTH LINE

MT. CARMEL COAL AND IRON CO. TRACT

PRIMROSE VEIN STRIPPING NO. 4-32

LEASE TO LYCCO DECEMBER 1, 1901

LEASE TO LYCCO DECEMBER 1, 1907

LEASE TO LYCCO DECEMBER 1, 1926

WATER

150 FT. PILLAR

125 FT. PILLAR

WATER COMPANY

SEVENTH ST

SIXTH ST

FIFTH ST

FOURTH ST

THIRD ST

SECOND ST

CHERRY ST

POPULAR ST

BEECH ST

WILLOW ST

MT. CARMEL COAL AND IRON CO. TRACT

MT. CARMEL COAL AND IRON CO. TRACT

MT. CARMEL COAL AND IRON CO. TRACT

MT. CARMEL COAL AND IRON CO. TRACT

MT. CARMEL COAL AND IRON CO. TRACT

MT. CARMEL COAL AND IRON CO. TRACT

MT. CARMEL COAL AND IRON CO. TRACT

MT. CARMEL COAL AND IRON CO. TRACT

MT. CARMEL COAL AND IRON CO. TRACT

MT. CARMEL COAL AND IRON CO. TRACT

MT. CARMEL COAL AND IRON CO. TRACT

MT. CARMEL COAL AND IRON CO. TRACT

MT. CARMEL COAL AND IRON CO. TRACT

MT. CARMEL COAL AND IRON CO. TRACT

MT. CARMEL COAL AND IRON CO. TRACT

MT. CARMEL COAL AND IRON CO. TRACT