

B.M. TOP OF S.E. CORNER OF NORTHERN PARAPET WALL, ASSUMED ELEV. 100.00'

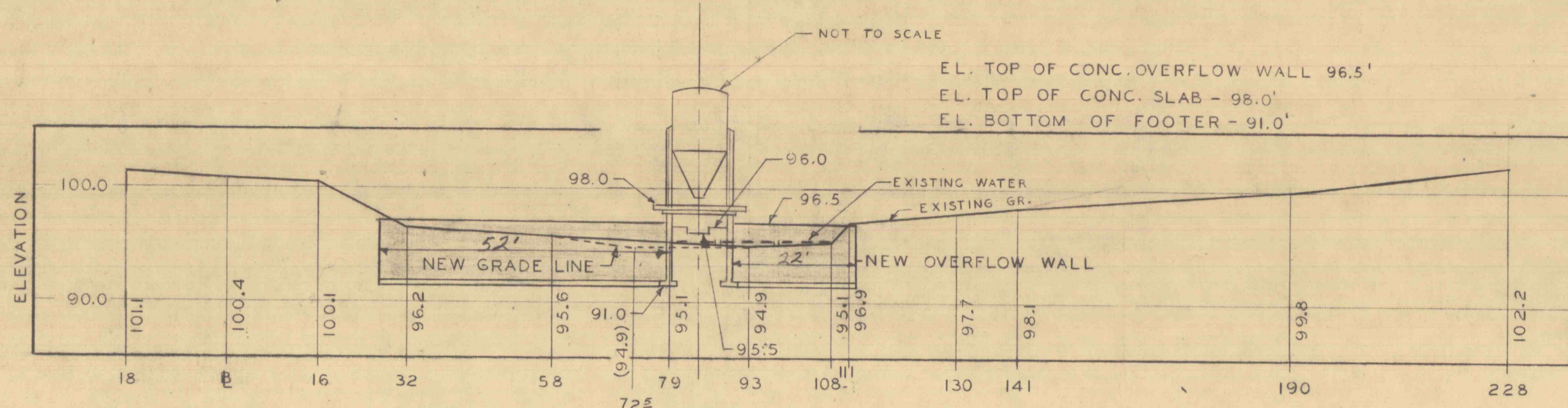

TYPICAL STREAM SECTION A-A

SCALE HOR. 1" = 20'  
 VERT. 1" = 10'

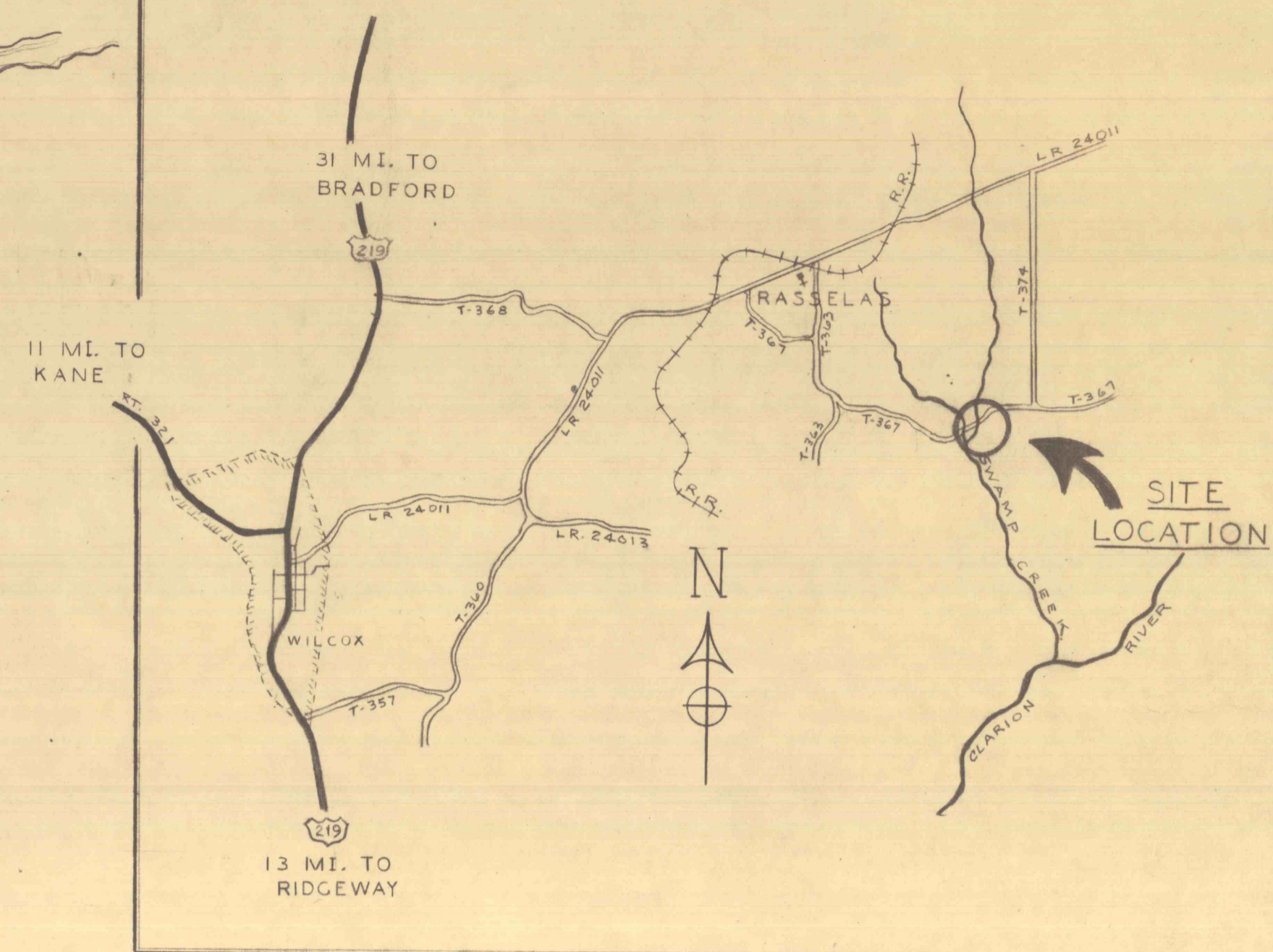
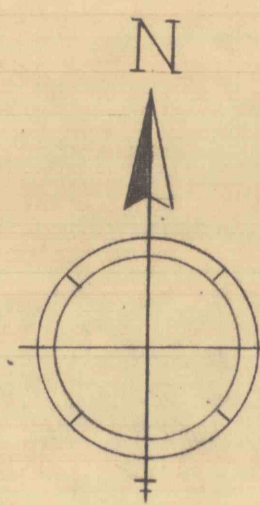

LOCATION PLAN

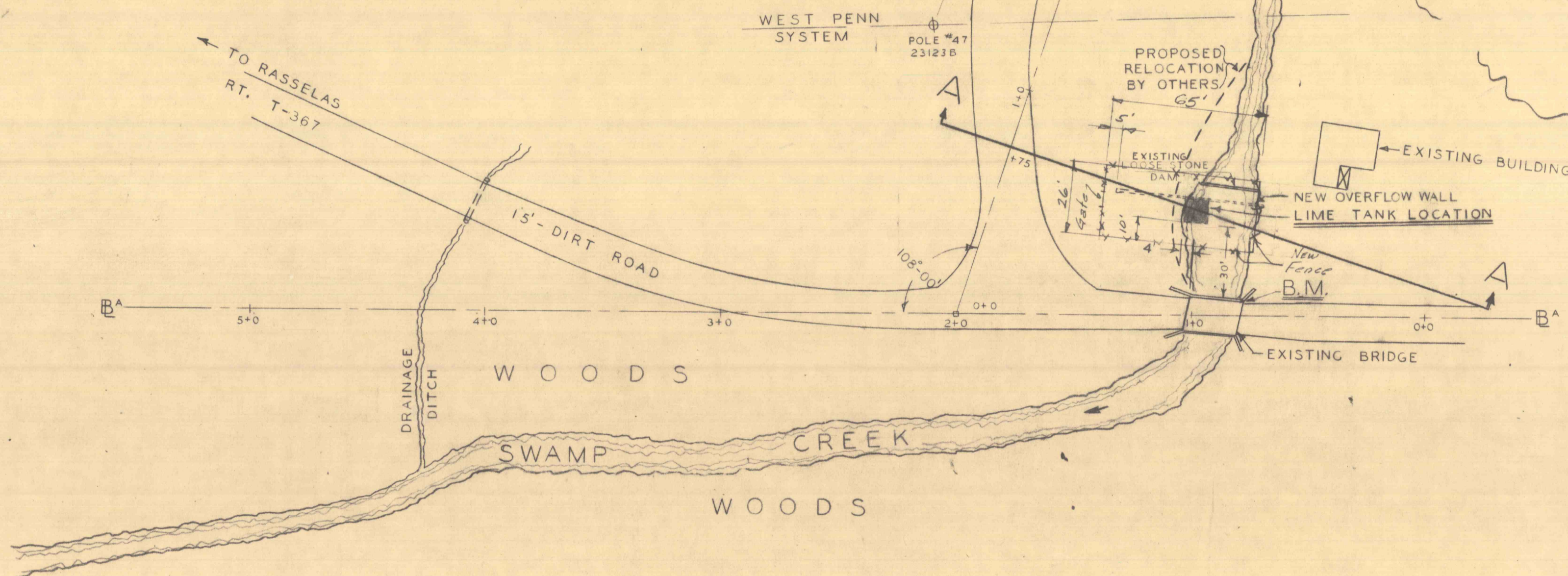

PLAN

SCALE 1" = 40'

NOTE  
 00.0 - STREAM BED ELEV.  
 (00.0) - WATER SURFACE ELEV.

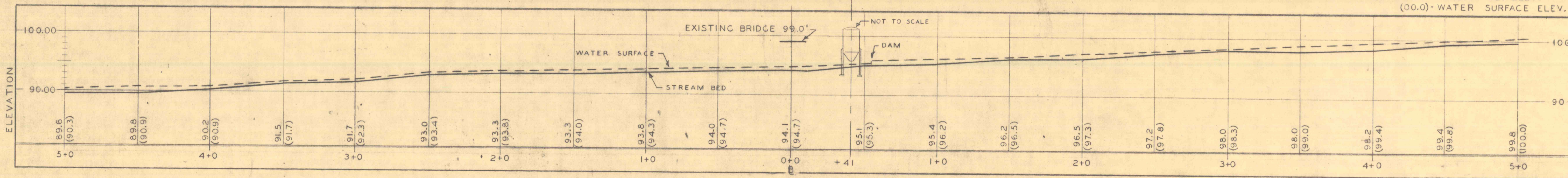

STREAM PROFILE

SCALE: HOR. 1" = 40'  
 VERT. 1" = 10'

SURVEYED 8-22-67 by D.C.SPANGLER R.S.

REVISIONS	
SYMBOL	CORRECTIONS

APPROVALS	
APPROVED	<i>[Signature]</i> DIRECTOR-BUREAU OF ENGINEERING & CONSTRUCTION
APPROVED	<i>[Signature]</i> SUPERVISING ENGINEER-BUREAU OF ENGINEERING & CONSTRUCTION
APPROVED	<i>[Signature]</i> FOR DEPT. OF MINES & MINERALS SEC'Y.
SUBMITTED BY	<i>[Signature]</i> ENG'R.

CHECKED BY			
ARCH.	CIVIL & STRUCT.	MECH.	ELECT.
	<i>[Signature]</i>		

PROJECT NO. MM-6184-5

SITE DRAINAGE - SWAMP CREEK

MINE DRAINAGE TREATMENT  
 SANDY RUN LUZERNE CO., PENNSYLVANIA  
 BUCK MT CARBON CO., PENNSYLVANIA  
 SWAMP CREEK ELK CO., PENNSYLVANIA

BUREAU OF ENGINEERING & CONSTRUCTION  
 DEPARTMENT OF PROPERTY & SUPPLIES

DATE SEPT. 19 1967	COMMONWEALTH OF PENNSYLVANIA DEPT. OF PROPERTY & SUPPLIES	GOVERNOR PERRIN C. HAMILTON HARRISBURG, PENNSYLVANIA	SHEET NO. 1 OF 7
-----------------------	--	--	---------------------

ALL DIMENSIONS AND MEASUREMENTS SHALL BE CHECKED AND VERIFIED BY THE CONTRACTOR AT THE SITE



DRAWN