

ANDREW RUSSELL TRACT

WM. MARSHALL TRACT

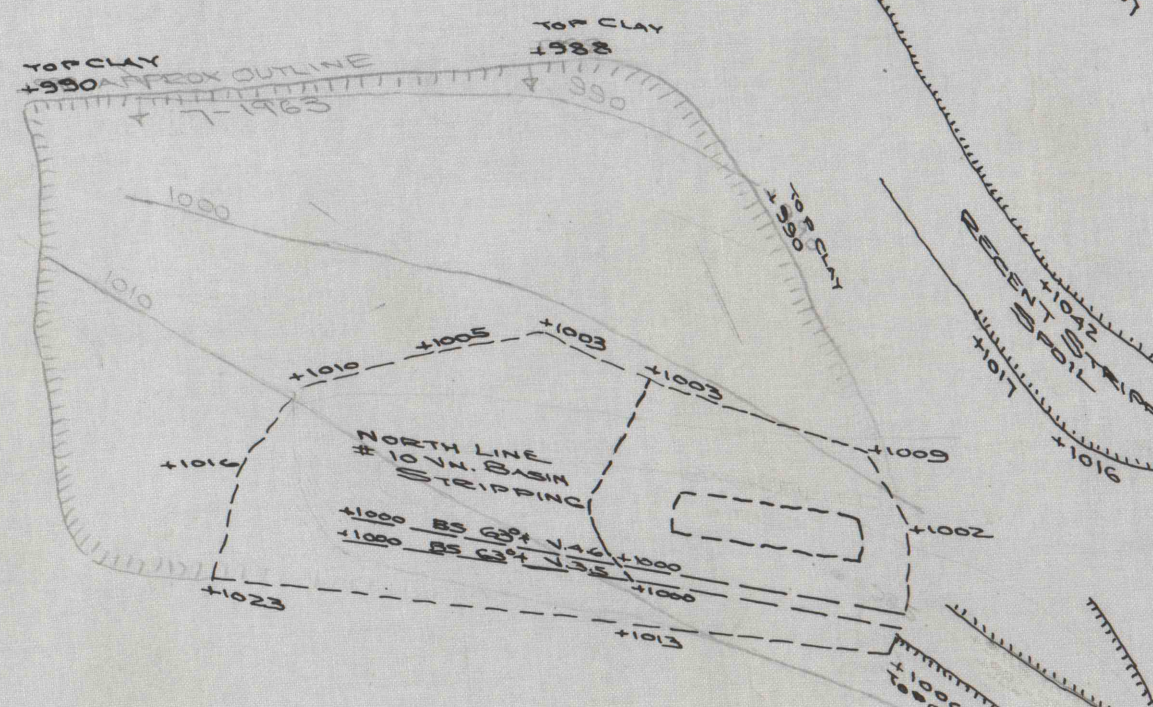

TOP CLAY
+990
TOP CLAY
+992
TOP CLAY
+996
RECENT STRIPPING
+1012
TOP CLAY
+1012
NORTH LINE
#10 V.M. BASIN
STRIPPING
+1000 BS
+998 BS
+996 BS
+994 BS
+992 BS
+990 BS
+988 BS
+986 BS
+984 BS
+982 BS
+980 BS
+978 BS
+976 BS
+974 BS
+972 BS
+970 BS
+968 BS
+966 BS
+964 BS
+962 BS
+960 BS
+958 BS
+956 BS
+954 BS
+952 BS
+950 BS
+948 BS
+946 BS
+944 BS
+942 BS
+940 BS
+938 BS
+936 BS
+934 BS
+932 BS
+930 BS
+928 BS
+926 BS
+924 BS
+922 BS
+920 BS
+918 BS
+916 BS
+914 BS
+912 BS
+910 BS
+908 BS
+906 BS
+904 BS
+902 BS
+900 BS
+898 BS
+896 BS
+894 BS
+892 BS
+890 BS
+888 BS
+886 BS
+884 BS
+882 BS
+880 BS
+878 BS
+876 BS
+874 BS
+872 BS
+870 BS
+868 BS
+866 BS
+864 BS
+862 BS
+860 BS
+858 BS
+856 BS
+854 BS
+852 BS
+850 BS
+848 BS
+846 BS
+844 BS
+842 BS
+840 BS
+838 BS
+836 BS
+834 BS
+832 BS
+830 BS
+828 BS
+826 BS
+824 BS
+822 BS
+820 BS
+818 BS
+816 BS
+814 BS
+812 BS
+810 BS
+808 BS
+806 BS
+804 BS
+802 BS
+800 BS
+798 BS
+796 BS
+794 BS
+792 BS
+790 BS
+788 BS
+786 BS
+784 BS
+782 BS
+780 BS
+778 BS
+776 BS
+774 BS
+772 BS
+770 BS
+768 BS
+766 BS
+764 BS
+762 BS
+760 BS
+758 BS
+756 BS
+754 BS
+752 BS
+750 BS
+748 BS
+746 BS
+744 BS
+742 BS
+740 BS
+738 BS
+736 BS
+734 BS
+732 BS
+730 BS
+728 BS
+726 BS
+724 BS
+722 BS
+720 BS
+718 BS
+716 BS
+714 BS
+712 BS
+710 BS
+708 BS
+706 BS
+704 BS
+702 BS
+700 BS
+698 BS
+696 BS
+694 BS
+692 BS
+690 BS
+688 BS
+686 BS
+684 BS
+682 BS
+680 BS
+678 BS
+676 BS
+674 BS
+672 BS
+670 BS
+668 BS
+666 BS
+664 BS
+662 BS
+660 BS
+658 BS
+656 BS
+654 BS
+652 BS
+650 BS
+648 BS
+646 BS
+644 BS
+642 BS
+640 BS
+638 BS
+636 BS
+634 BS
+632 BS
+630 BS
+628 BS
+626 BS
+624 BS
+622 BS
+620 BS
+618 BS
+616 BS
+614 BS
+612 BS
+610 BS
+608 BS
+606 BS
+604 BS
+602 BS
+600 BS
+598 BS
+596 BS
+594 BS
+592 BS
+590 BS
+588 BS
+586 BS
+584 BS
+582 BS
+580 BS
+578 BS
+576 BS
+574 BS
+572 BS
+570 BS
+568 BS
+566 BS
+564 BS
+562 BS
+560 BS
+558 BS
+556 BS
+554 BS
+552 BS
+550 BS
+548 BS
+546 BS
+544 BS
+542 BS
+540 BS
+538 BS
+536 BS
+534 BS
+532 BS
+530 BS
+528 BS
+526 BS
+524 BS
+522 BS
+520 BS
+518 BS
+516 BS
+514 BS
+512 BS
+510 BS
+508 BS
+506 BS
+504 BS
+502 BS
+500 BS
+498 BS
+496 BS
+494 BS
+492 BS
+490 BS
+488 BS
+486 BS
+484 BS
+482 BS
+480 BS
+478 BS
+476 BS
+474 BS
+472 BS
+470 BS
+468 BS
+466 BS
+464 BS
+462 BS
+460 BS
+458 BS
+456 BS
+454 BS
+452 BS
+450 BS
+448 BS
+446 BS
+444 BS
+442 BS
+440 BS
+438 BS
+436 BS
+434 BS
+432 BS
+430 BS
+428 BS
+426 BS
+424 BS
+422 BS
+420 BS
+418 BS
+416 BS
+414 BS
+412 BS
+410 BS
+408 BS
+406 BS
+404 BS
+402 BS
+400 BS
+398 BS
+396 BS
+394 BS
+392 BS
+390 BS
+388 BS
+386 BS
+384 BS
+382 BS
+380 BS
+378 BS
+376 BS
+374 BS
+372 BS
+370 BS
+368 BS
+366 BS
+364 BS
+362 BS
+360 BS
+358 BS
+356 BS
+354 BS
+352 BS
+350 BS
+348 BS
+346 BS
+344 BS
+342 BS
+340 BS
+338 BS
+336 BS
+334 BS
+332 BS
+330 BS
+328 BS
+326 BS
+324 BS
+322 BS
+320 BS
+318 BS
+316 BS
+314 BS
+312 BS
+310 BS
+308 BS
+306 BS
+304 BS
+302 BS
+300 BS
+298 BS
+296 BS
+294 BS
+292 BS
+290 BS
+288 BS
+286 BS
+284 BS
+282 BS
+280 BS
+278 BS
+276 BS
+274 BS
+272 BS
+270 BS
+268 BS
+266 BS
+264 BS
+262 BS
+260 BS
+258 BS
+256 BS
+254 BS
+252 BS
+250 BS
+248 BS
+246 BS
+244 BS
+242 BS
+240 BS
+238 BS
+236 BS
+234 BS
+232 BS
+230 BS
+228 BS
+226 BS
+224 BS
+222 BS
+220 BS
+218 BS
+216 BS
+214 BS
+212 BS
+210 BS
+208 BS
+206 BS
+204 BS
+202 BS
+200 BS
+198 BS
+196 BS
+194 BS
+192 BS
+190 BS
+188 BS
+186 BS
+184 BS
+182 BS
+180 BS
+178 BS
+176 BS
+174 BS
+172 BS
+170 BS
+168 BS
+166 BS
+164 BS
+162 BS
+160 BS
+158 BS
+156 BS
+154 BS
+152 BS
+150 BS
+148 BS
+146 BS
+144 BS
+142 BS
+140 BS
+138 BS
+136 BS
+134 BS
+132 BS
+130 BS
+128 BS
+126 BS
+124 BS
+122 BS
+120 BS
+118 BS
+116 BS
+114 BS
+112 BS
+110 BS
+108 BS
+106 BS
+104 BS
+102 BS
+100 BS
+98 BS
+96 BS
+94 BS
+92 BS
+90 BS
+88 BS
+86 BS
+84 BS
+82 BS
+80 BS
+78 BS
+76 BS
+74 BS
+72 BS
+70 BS
+68 BS
+66 BS
+64 BS
+62 BS
+60 BS
+58 BS
+56 BS
+54 BS
+52 BS
+50 BS
+48 BS
+46 BS
+44 BS
+42 BS
+40 BS
+38 BS
+36 BS
+34 BS
+32 BS
+30 BS
+28 BS
+26 BS
+24 BS
+22 BS
+20 BS
+18 BS
+16 BS
+14 BS
+12 BS
+10 BS
+8 BS
+6 BS
+4 BS
+2 BS
0 BS
-2 BS
-4 BS
-6 BS
-8 BS
-10 BS
-12 BS
-14 BS
-16 BS
-18 BS
-20 BS
-22 BS
-24 BS
-26 BS
-28 BS
-30 BS
-32 BS
-34 BS
-36 BS
-38 BS
-40 BS
-42 BS
-44 BS
-46 BS
-48 BS
-50 BS
-52 BS
-54 BS
-56 BS
-58 BS
-60 BS
-62 BS
-64 BS
-66 BS
-68 BS
-70 BS
-72 BS
-74 BS
-76 BS
-78 BS
-80 BS
-82 BS
-84 BS
-86 BS
-88 BS
-90 BS
-92 BS
-94 BS
-96 BS
-98 BS
-100 BS.

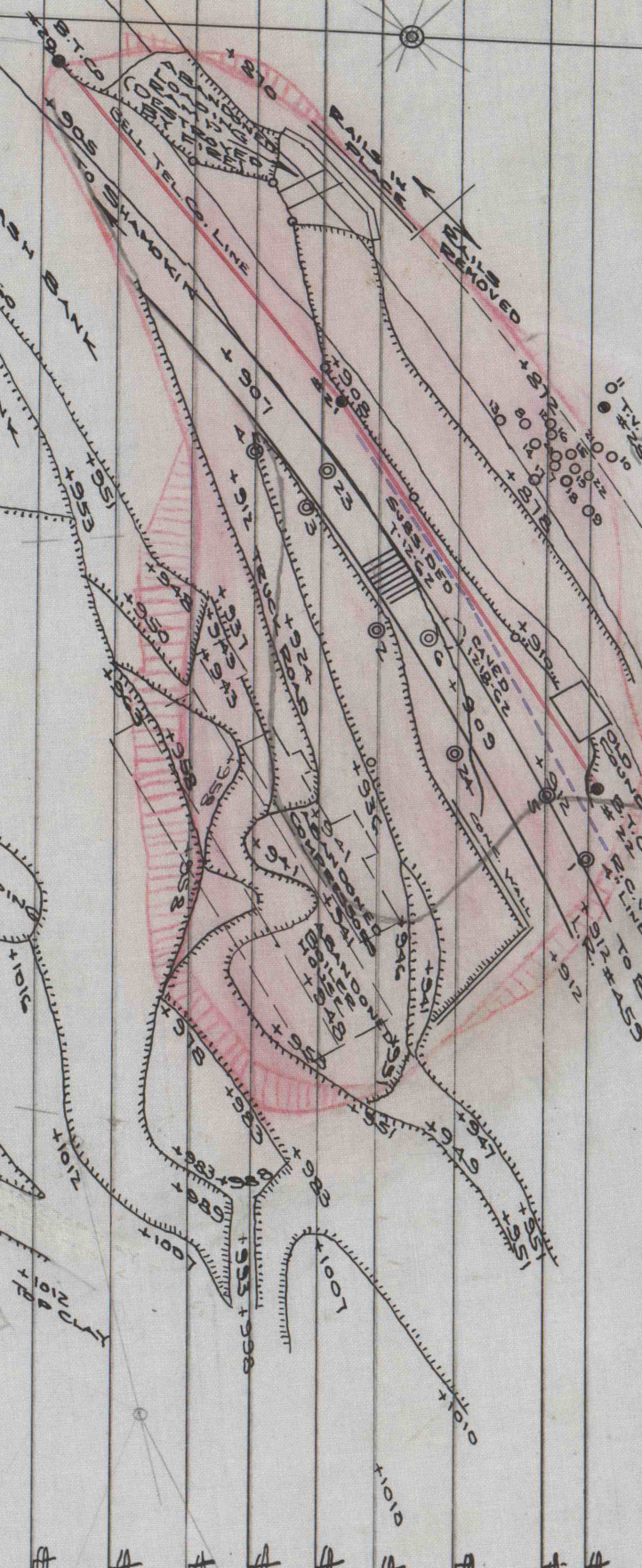

BURNSIDE COLLIERY
SURFACE FEATURES
ADJOINING FIRE IN HIGHWAY FILL
L.R. No. 459 NORTHWEST OF BURNSIDE
1" = 100'