

31)
 $\frac{25}{17.5} = 1.43$
 $\frac{15}{17.5} = 0.86$
 $\frac{3.6}{17.5} = 0.21$
 17.5 ft

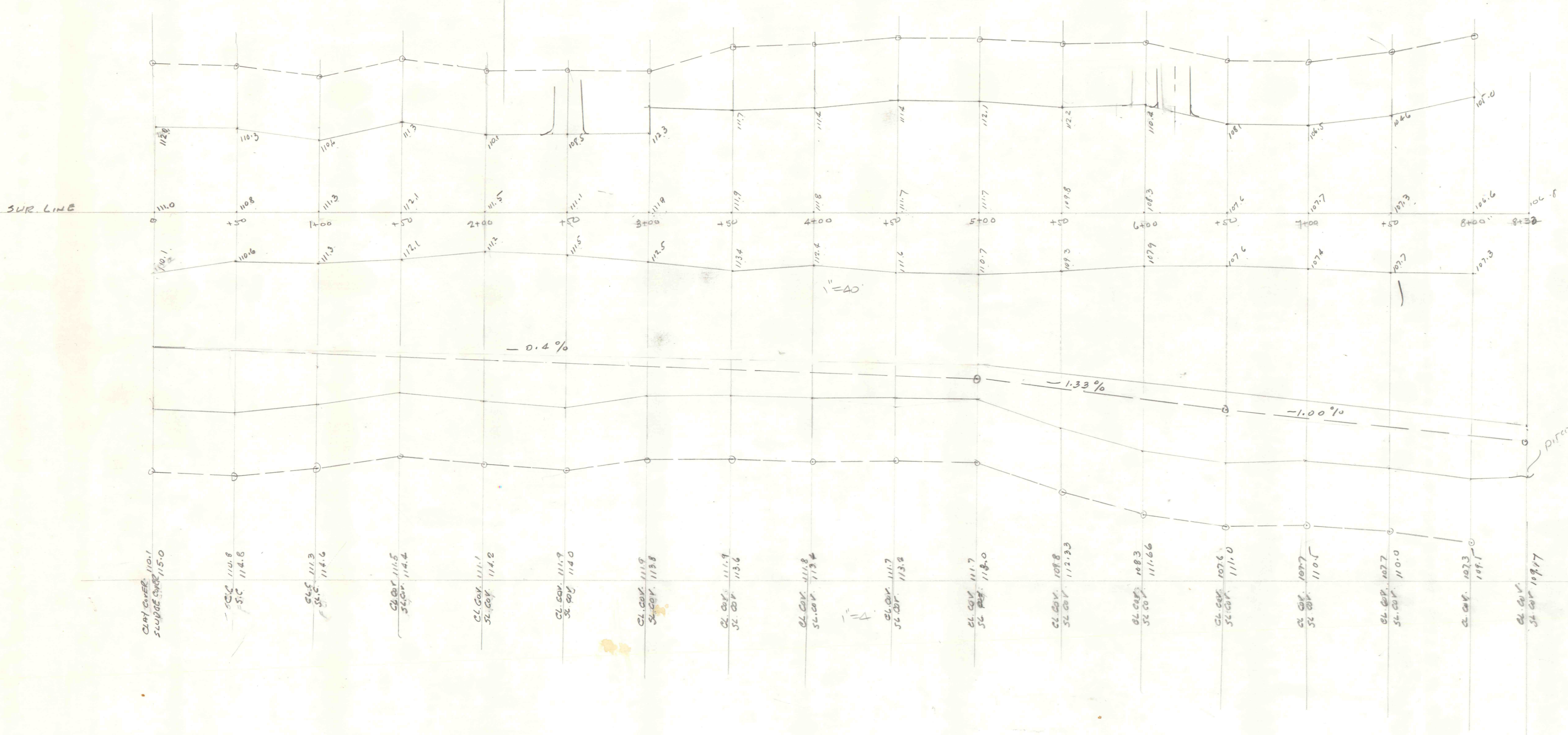
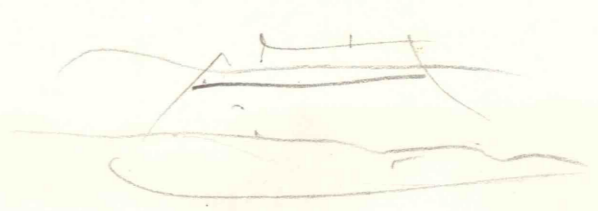

300+50 = 15000
 52500
 27) 202500
 131

15000
 52500
 27) 202500
 131

7500 cu. yds.
 + 2000 cu. yds.
 9500 cu. yds.

7500 cu. yds.
 90 cu. yds. per ft.
 18 ft. approx. width

82
 70
 16000
 16000

Additional storage due to
 Removal of impervious material.

82
 70
 27) 60000
 116
 105

7500 cu. yds.
 2430 cu. yds. additional
 9930 cu. yds.