

NOTE:
BOLD CONTOURS INDICATE
REVISIONS TO ORIGINAL
MAPPING TO REFLECT
EXISTING TOPOGRAPHY

B.M. # 6 Elevation 959.17
□ - Cut on Southeast Corner of
South Parapet of Concrete Bridge

B.M. # 7 Elevation 980.46
□ - Drill hole in top of Southeast
Corner of Concrete Foundation

CURVE D-1
P.C. Sta. D-0+00 C.L. =
Sta. 0+60 along Back
Tangent, 35° Rt.
P.T. Sta. D-2+00 C.L. =
Sta. 14+55 E., 10' Lt.
T = 101'
Δ = 25°
R = 458'

CURVE D-2
P.C. Sta. D-4+58 C.L. =
Sta. 4+08 E., 30' Lt.
P.T. Sta. D-11+80 C.L. =
Sta. 12+21 E., 24' Lt.
T = 458'
Δ = 90°
R = 458'

CURVE D-3
P.C. Sta. D-15+00 C.L. =
P.T. Sta. D-16+65 C.L. =
T = 84'
Δ = 33°
R = 286'

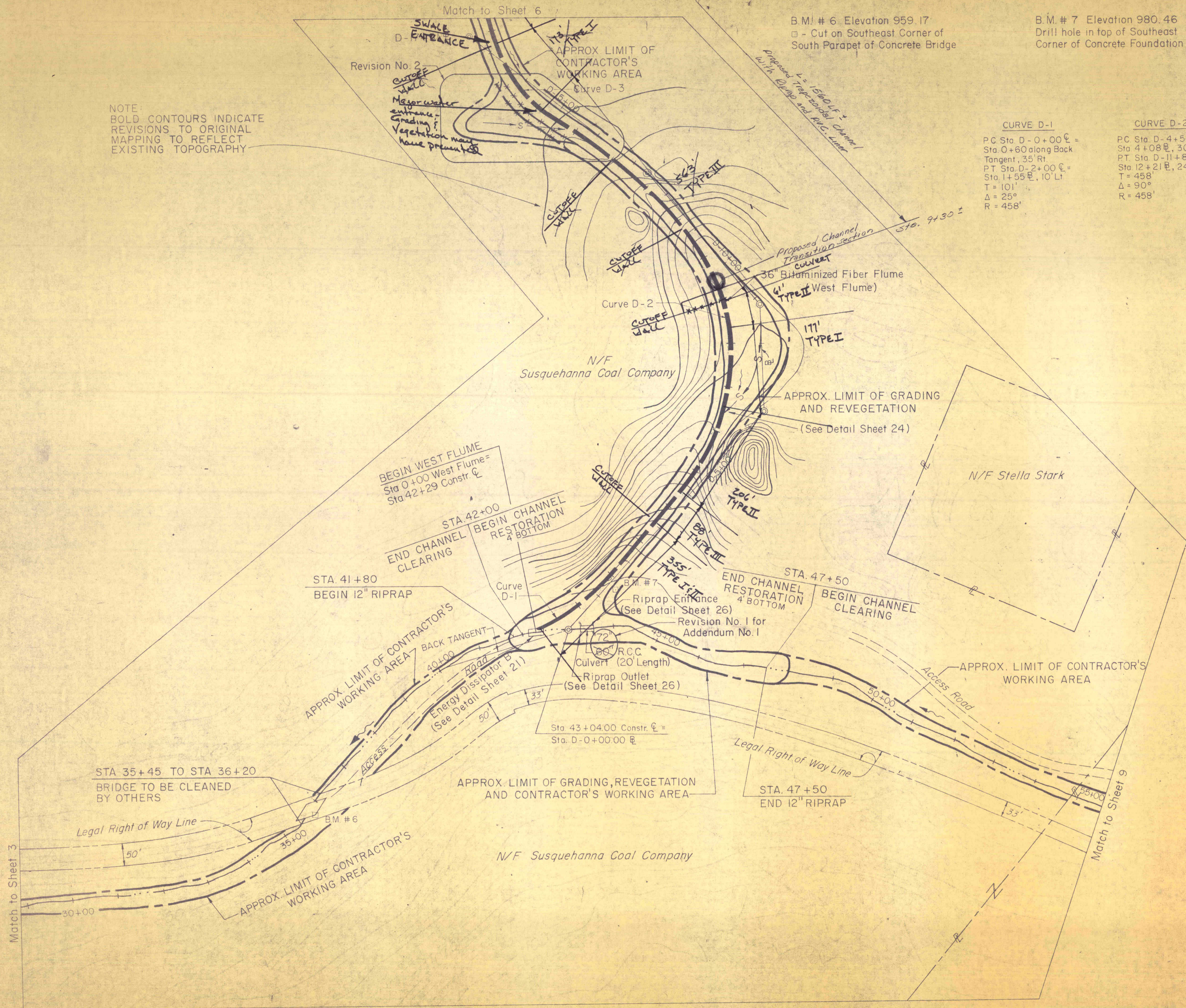

1	5-23-75	Changed 60" R.C.C. Culvert to 72"	RFZ
2	12-5-75	Added Concrete Paved Swale Flume Entrance	
NO	DATE	REVISION	APPR

SUBMITTED: *Richard B. Ulf*
PROFESSIONAL
APPROVED: *Alfred A. Roman*
CHIEF, DIVISION OF MINE RECLAMATION
APPROVED: *Stefano*
DIRECTOR, BUREAU OF DESIGN

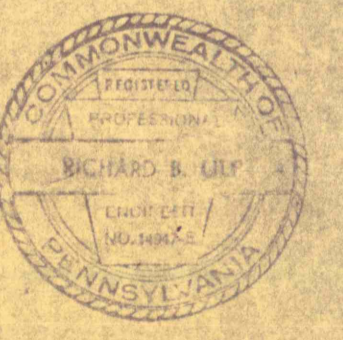

COMMONWEALTH OF PENNSYLVANIA
DEPARTMENT OF ENVIRONMENTAL RESOURCES
OFFICE OF RESOURCES MANAGEMENT
PROJECT NO. SL 113-5-1
MINE DRAINAGE POLLUTION ABATEMENT
COAL RUN
SHAMOKIN CREEK WATERSHED
NORTHUMBERLAND COUNTY, PA.

ERDMAN, ANTHONY, ASSOCIATES
Consulting Engineers
Camp Hill, Pa. Rochester, N.Y.

PLAN
DRAWN BY: GMS
CHECKED BY: DHC
DATE: 5-9-75
SCALE: 1" = 100'
DRAWING NO: 4 of 28