

REQUIRED LIST

3840' F. Type IA, 2A, 3A or 4A Guard fence
 Type 1, 2, 3 or 4 End Anchors
 (See sheet 2 of drawing for tabulated list)

2560' Lin Ft Subgrade Drains
 To be placed as directed by the Engineer.

1500' Lin Ft 6" Tile Under drain
 150' Lin Ft 6" Tile Outlets

B.M. Elev. 1096.474
 Cut on Conc. Step at entrance to
 Slovak Pres. Church, Cor. Ave. & Market St.

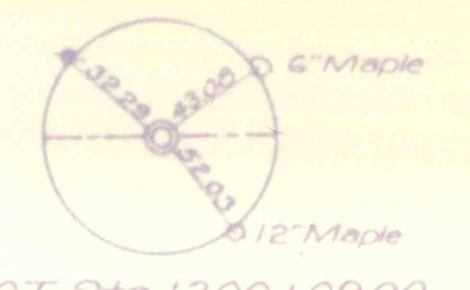

POT Sta 1300+09.00
 Angle 180°00'

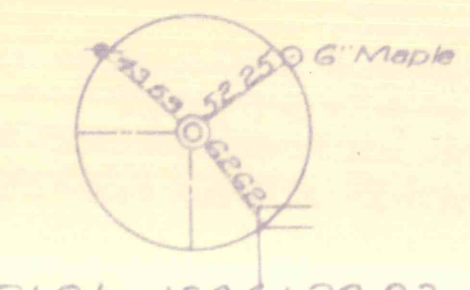

PI Sta 1304+20.83
 Angle 269°56'

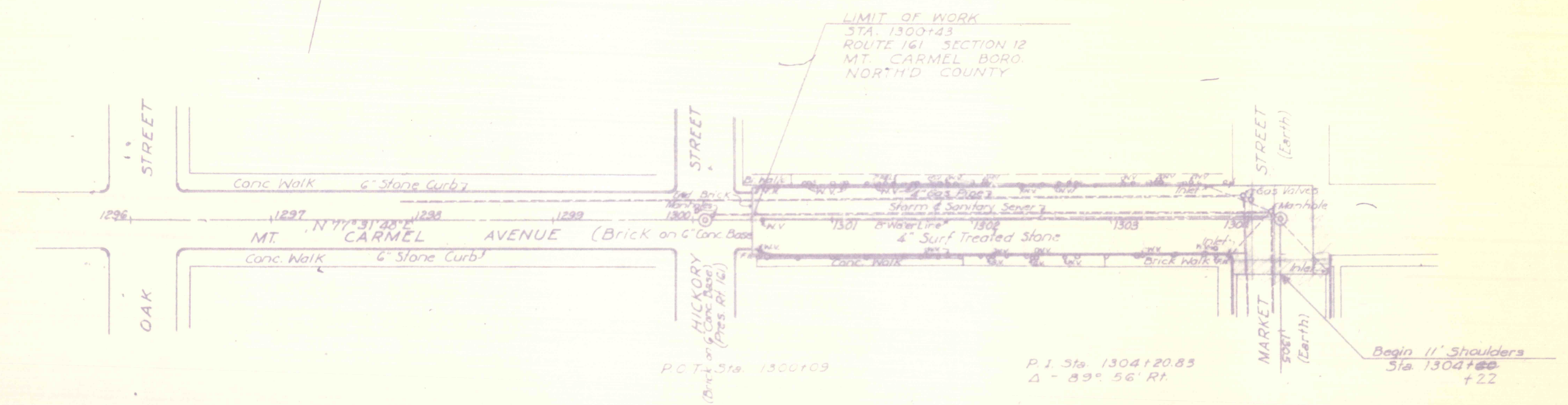

LIMIT OF WORK
 STA. 1300+43
 ROUTE 161 SECTION 12
 MT. CARMEL BORO.
 NORTH'D. COUNTY

P.I. Sta. 1304+20.83
 Δ - 89° 56' Rt.

Begin 11' Shoulders
 Sta. 1304+00
 +22

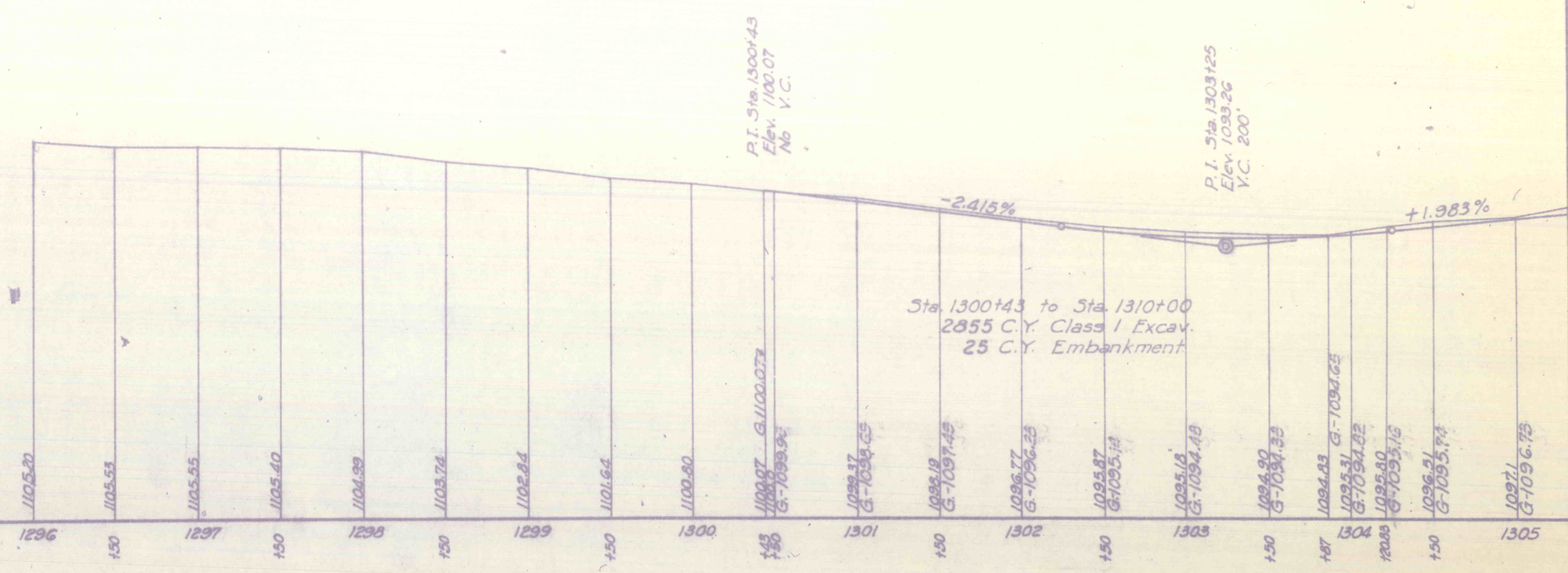

DATUM 1060