

REQUIRED LIST

- 3640 F. Type 1A, 2A, 3A or 4A Guard Fence
24 Type 1, 2, 3 or 4 End Anchors
(See sheet 2 of drawing for tabulated list.)
- 2560 Lin Ft Subgrade Drains
To be placed as directed by the Engineer.
- 1500 Lin Ft 6" Tile Under drain
150 Lin Ft 6" Tile Outlets

BM Elev. 1093.474
 D Cut on Conc. Step at entrance to
 Slovak Pres. Church, Cor. Ave. & Market St.

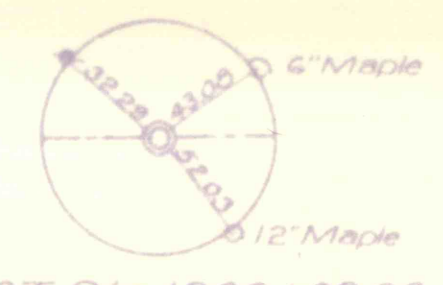

P.O.T. Sta 1300+09.00
 Angle 180°00'

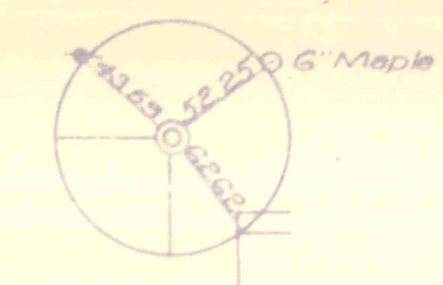

P.I. Sta 1304+20.83
 Angle 269°56'

LIMIT OF WORK
 STA. 1300+43
 ROUTE 161 SECTION 12
 MT. CARMEL BORO.
 NORTH'D. COUNTY

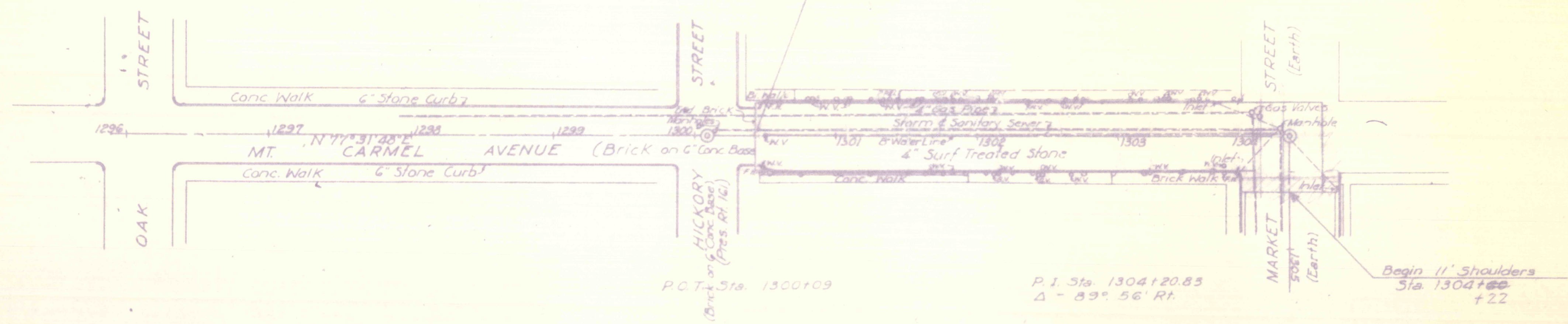

P.O.T. Sta. 1300+09

P.I. Sta. 1304+20.83
 $\Delta = 89^\circ 56' R.$

Begin 11' Shoulders
 Sta 1304+00
 +22

DATUM 1060

