

ABOLITION OF CHANGES BY RELOCATION
Route 161 Section 12
Mt. Carmel Boro. Mt. Carmel Twp. North'd Co. & Conyngham Twp. Col. Co.

Relocation	Imp. Unimp. Total		Abandonment		
	Imp.	Unimp.	Total		
Sta. 1300+09 to Sta. 1320+20.82	201182		201182		Mt. Carmel Boro. North'd. Co.
Sta. 1300+09 to Sta. 1320+35				2026	
Sta. 1351+00 to Sta. 1373+231	22231		22231		Mt. Carmel Twp. "
Sta. 1348+00 to Sta. 1370+31				2231	
Sta. 0+00 to Sta. 23+41.5	234115		234115		Conyngham Twp. Col. Co.
Sta. 0+00 to Sta. 24+26.43				242643	

COMMONWEALTH OF PENNSYLVANIA

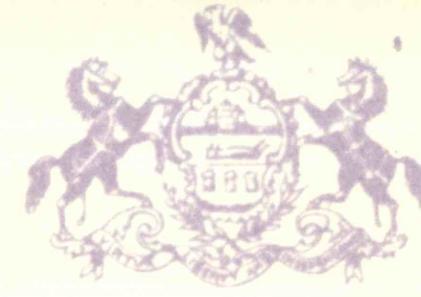

DEPARTMENT OF HIGHWAYS

DRAWINGS FOR CONSTRUCTION

AND CONDEMNATION OF RIGHT OF WAY ROUTE NO. 161 SECTION NO. 12 IN NORTHUMBERLAND COUNTY & COLUMBIA COUNTY

From Sta. 1300+43 To Sta. 1319+84 = 1941 L.F. NORTH'D CO.
1340+08 To Sta. 1373+231 = 3315 L.F. NORTH'D CO.
0+00 To Sta. 28+15 = 2727.85 L.F. COLUMBIA CO.

TOTAL Length 7983.95 Ft. 1.512 Mi.

SCALE PLAN 1 IN. = 20 FT. PROFILE 1 IN. = 20 FEET VERT. 1 IN. = 10 FT.

PENNSYLVANIA

SCALE IN MILES 0 5 10 15 20 25 30 35 40

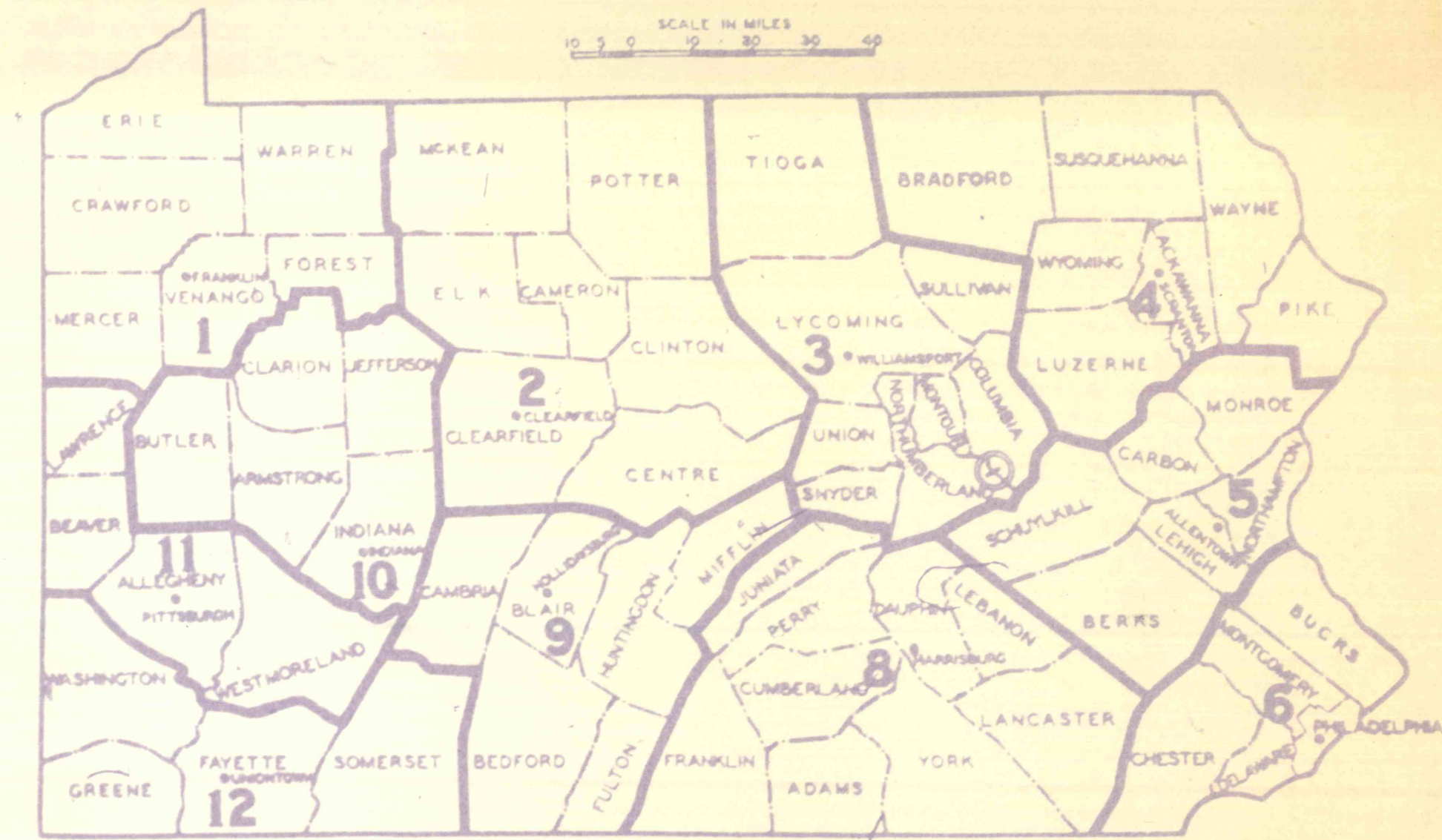

S	DISTRICT	COUNTY	TOWNSHIP	BOROUGH	ROUTE	SECT.	APPL.	TOTAL SHEETS
	3	NORTHUMBERLAND	COLUMBIA	MT. CARMEL	MT. CARMEL	161	12	

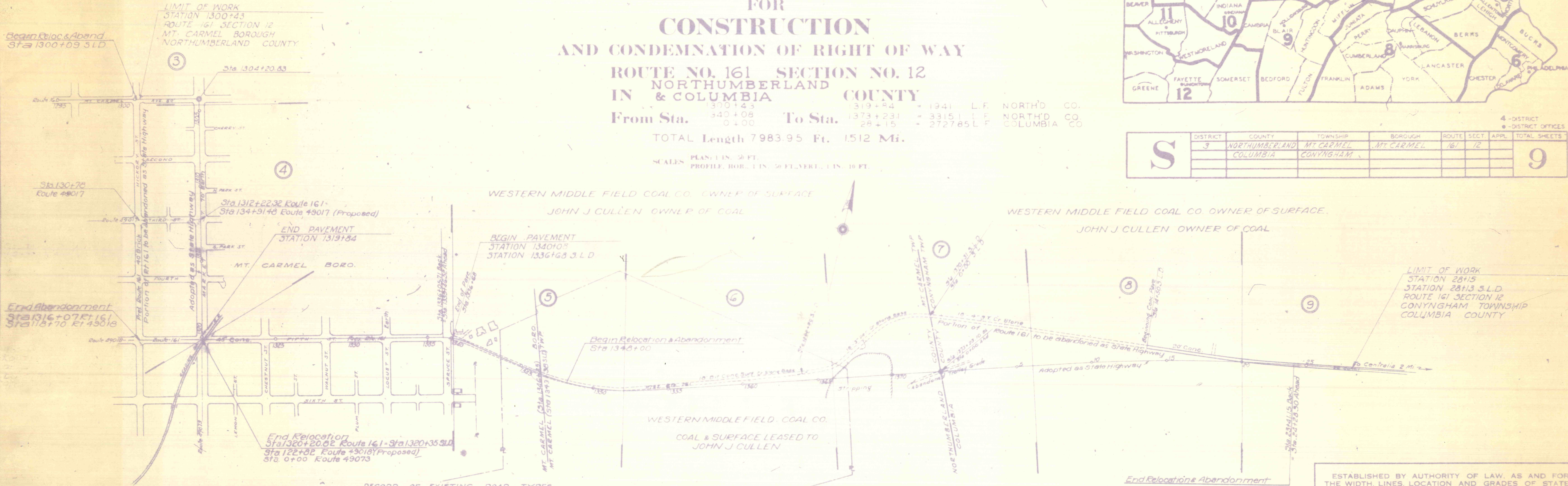

RECORD OF EXISTING ROAD TYPES

NORTHUMBERLAND COUNTY	
Adjacent to Sta. 1300+43	40' Brick on Conc. Base
Sta. 1300+43 to Sta. 1307+71	40' Brick on Conc. Base
Sta. 1307+71 to Sta. 1316+07	40' B.S.C.H.E-6 on Brick & Conc. Base
Sta. 1316+07 to Sta. 1320+28	28' B.S.C.H.E-6 on 8" N.S.B. & 40' Brick & Conc. Base
Sta. 1320+28 to Sta. 1320+68	8' B.S.C.H.E-1 on N.S.B. & 40' Brick on Conc. Base
Sta. 1320+68 to Sta. 1336+68	44' Uniform Reinf. Conc. Pav't
Sta. 1336+68 to Sta. 1360+90	18' Bit Conc. Surf. on Crushed Stone Base
Sta. 1360+90 to Sta. 1370+31	18' Penetration on Crushed Stone Base
COLUMBIA COUNTY	
Sta. 0+00 to Sta. 13+54	18' Surface Treated Crushed Stone
Sta. 13+54 to Sta. 14+50	20' DP-1 - Modified Crushed Stone Base
Sta. 14+50 to Sta. 28+13	20' Reinf. Conc. Pav't

CONVENTIONAL SIGNS

County Line	— — — — —	Bridge	
City or Borough Line	— — — — —	Present Culvert	
Township Line	— — — — —	Proposed "	
Property, Right of Way Line	— — — — —	Telegraph Pole	
Reservation	— — — — —	Electric Railway Pole	
Power Line	— — — — —	Fence	
Proposed Road	— — — — —	Hedge	
Traveled "	— — — — —	Stone Wall	
Rail Road	— — — — —	Tree	
Electric Railway	— — — — —	Side Stake	

INDEX MAP
SCALE 1" = 300'

APPROVING AND ESTABLISHING BY ORDINANCE THE LINES GRADES, DRAINAGE STRUCTURES AND ALL OTHER STRUCTURES ON ROUTE 161 IN NORTHUMBERLAND COUNTY BETWEEN STATION 1300+43 AND STATION 1319+84 AND BETWEEN STATION 1340+08 AND STATION 1346+35 IN MT. CARMEL BORO.

APPROVED FEBRUARY 17, 1942
SECRETARY OF COUNCIL

APPROVED FEBRUARY 17, 1942
PRESIDENT OF COUNCIL

APPROVED FEBRUARY 17, 1942
BURGESS

ESTABLISHED BY AUTHORITY OF LAW, AS AND FOR THE WIDTH, LINES, LOCATION AND GRADES OF STATE HIGHWAY ROUTE NUMBER 161 SECTION 12 FROM STATION 1300+43 TO STATION 1319+84 AND FROM STATION 1340+08 TO STATION 1373+23.10 IN MT. CARMEL BORO AND MT. CARMEL TOWNSHIP NORTHUMBERLAND COUNTY, AND FROM STATION 0+00 TO STATION 28+15 IN CONYNGHAM TOWNSHIP COLUMBIA COUNTY, EXCEPT AS TO THE PORTION WITHIN THE LIMITS OF THE BORO OF MTCARMEL.

RECOMMENDED
DISTRICT ENGINEER

RECOMMENDED
CHIEF ENGINEER

APPROVED
SECRETARY OF HIGHWAYS