

NOTE:
BOLD CONTOURS INDICATE
REVISIONS TO ORIGINAL
MAPPING TO REFLECT
EXISTING TOPOGRAPHY

B.M. # 6 Elevation 959.17
□ - Cut on Southeast Corner of
South Parapet of Concrete Bridge

B.M. # 7 Elevation 980.46
□ - Drill Holog of Southeast
Corner Concrete Foundation

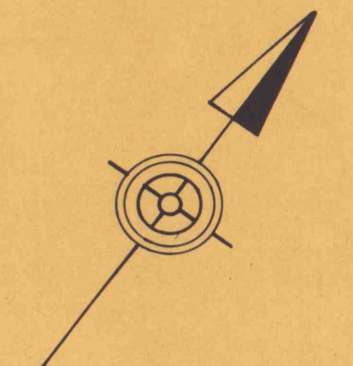

CURVE D-1
P.C. Sta. D-0+00 C.L. =
Sta. 0+60 along Back
Tangent, 35' Lt.
P.T. Sta. D-2+00 C.L. =
Sta. 1+55 E., 10' Lt.
T = 101'
Δ = 25°
R = 458'

CURVE D-2
P.C. Sta. D-4+58 C.L. =
Sta. 4+08 E., 30' Lt.
P.T. Sta. D-11+80 C.L. =
Sta. 12+21 E., 24' Lt.
T = 458'
Δ = 90°
R = 458'

CURVE D-3
P.C. Sta. D-15+00 C.L. =
P.T. Sta. D-16+65 C.L. =
T = 84'
Δ = 33°
R = 286'

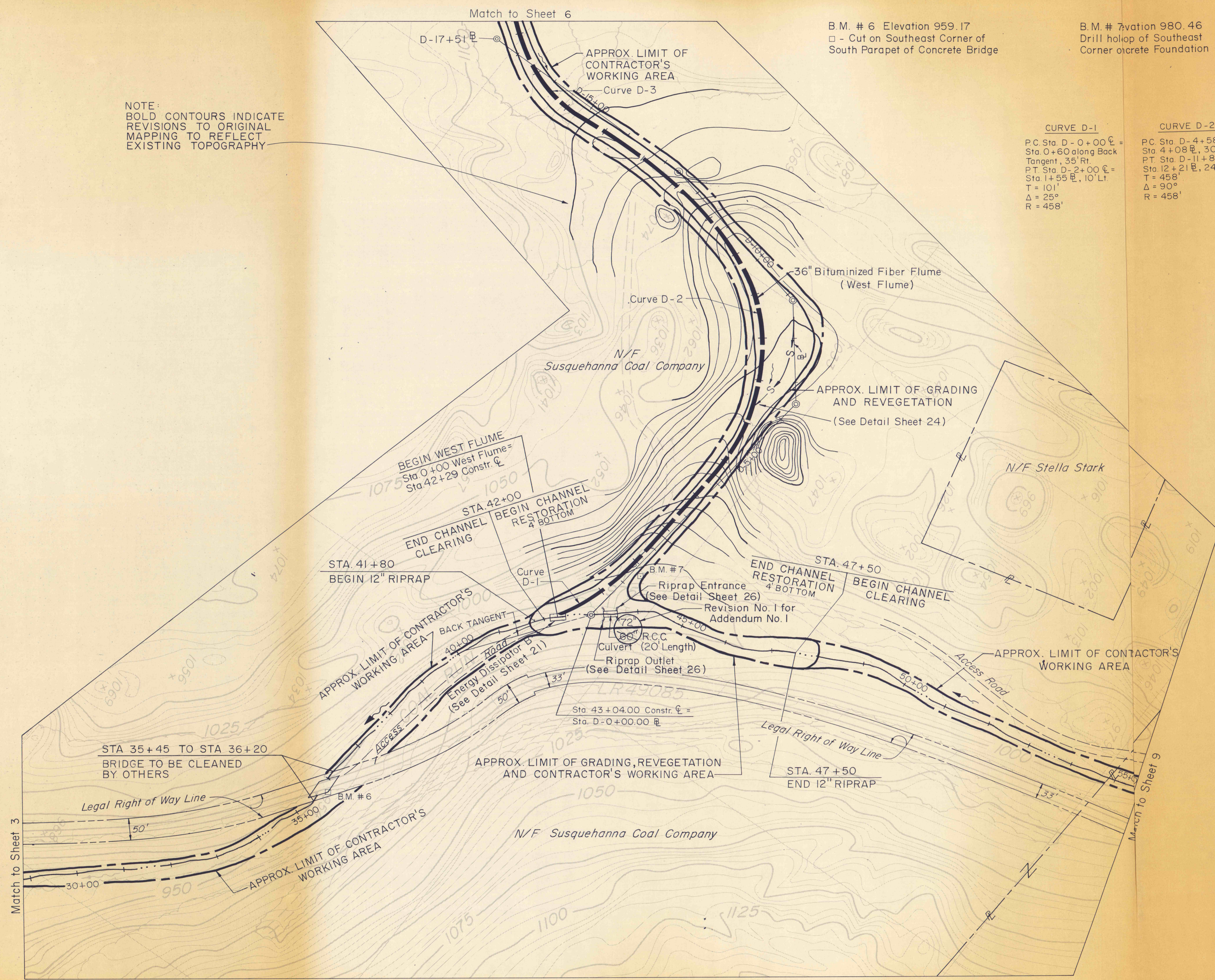

NO.	DATE	REVISION	APPR.
1	5-29-75	Changed 60" R.C.C. Culvert to 72"	TRC
SUBMITTED <i>Richard B. Ulf</i> PROFESSIONAL			
APPROVED <i>Richard B. Ulf</i> CHIEF, DIVISION OF MINE RECLAMATION			
APPROVED <i>Anthony Erdman</i> DIRECTOR - BUREAU OF DESIGN			
COMMONWEALTH OF PENNSYLVANIA DEPARTMENT OF ENVIRONMENTAL RESOURCES OFFICE OF RESOURCES MANAGEMENT PROJECT NO. SL 113-5-1 MINE DRAINAGE POLLUTION ABATEMENT COAL RUN SHAMOKIN CREEK WATERSHED NORTHUMBERLAND COUNTY, PA.			
ERDMAN, ANTHONY, ASSOCIATES Consulting Engineers Camp Hill, Pa. Rochester, N.Y.			
PLAN			

DRAWN BY GMS	DATE 5-9-75	DRAWING NO. 4 of 28
CHECKED BY DHC	SCALE 1" = 100'	