

STA. 9+95 E =
STA. 9+95 C

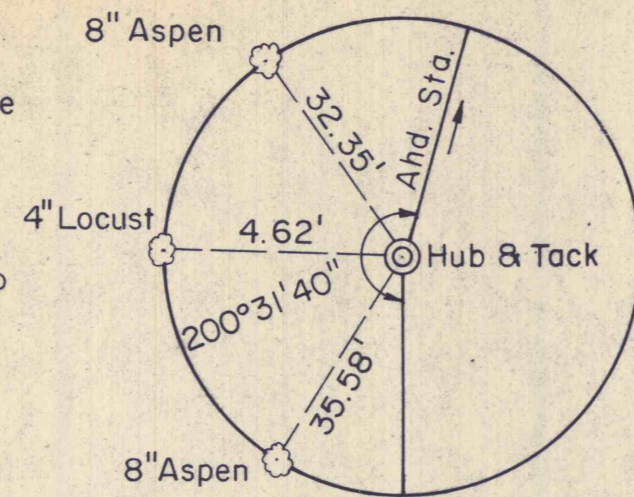

STA. 12+13 E

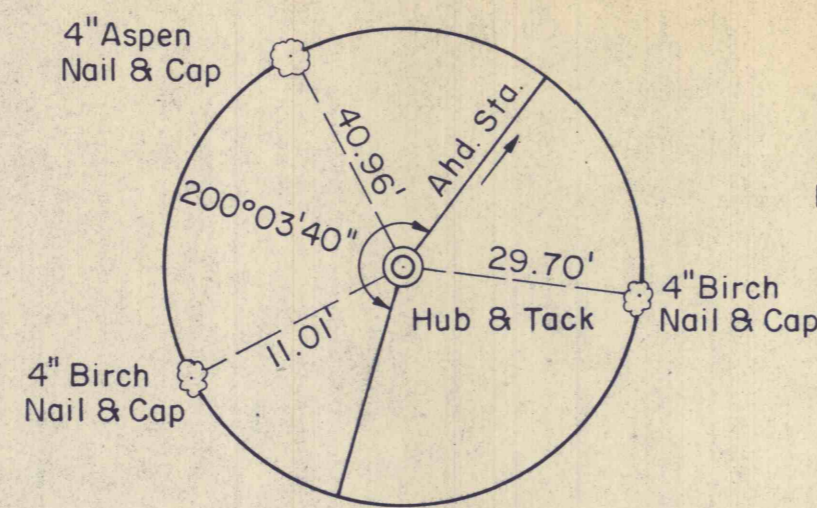

STA. 13+20 E

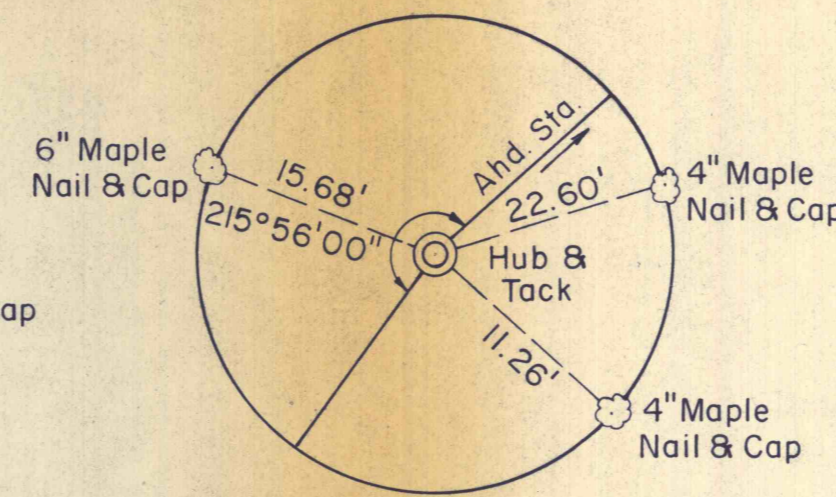

STA. 14+65 E =
STA. 14+80 C

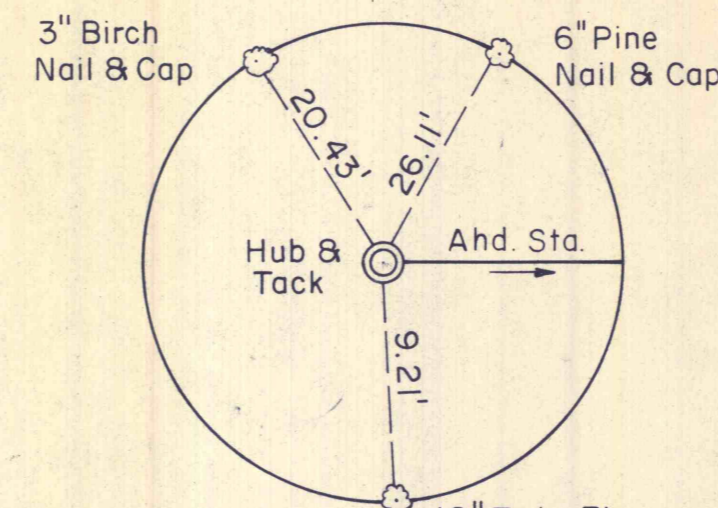

STA. 57+80 E =
STA. 58+00 C

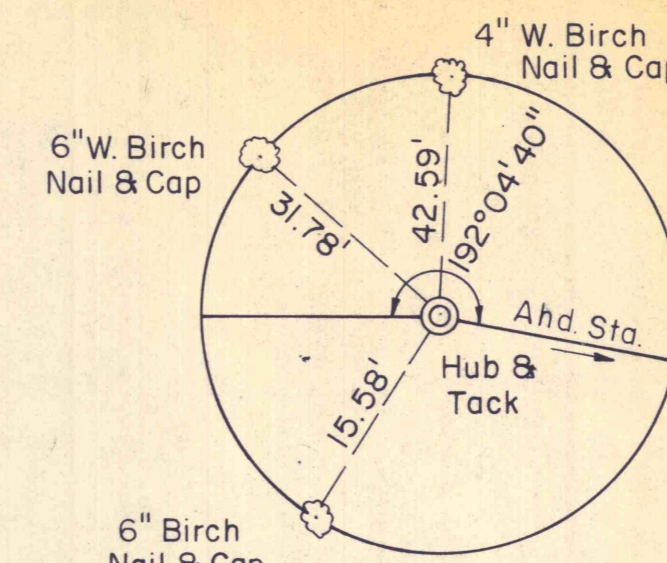

STA. 61+60 E

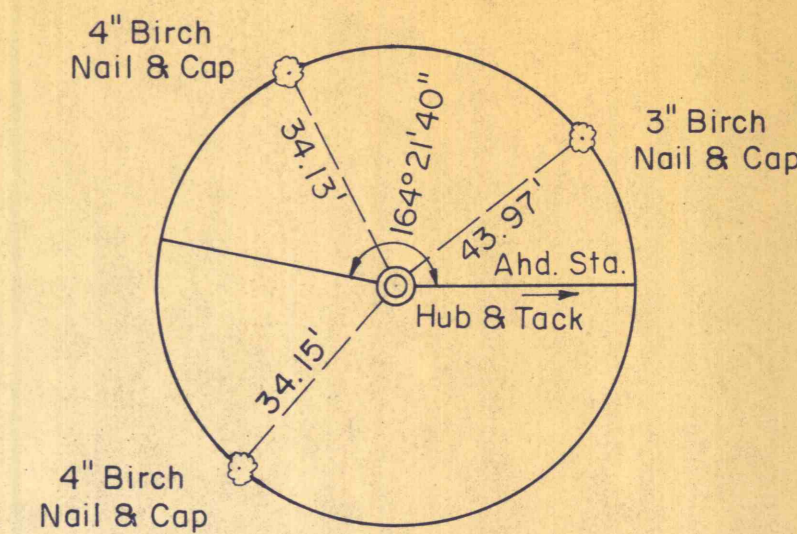

STA. 63+18 E

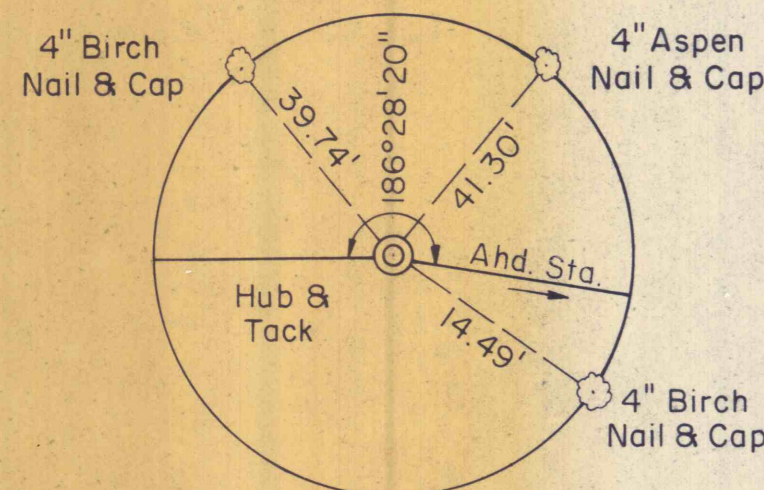

STA. 66+63 E

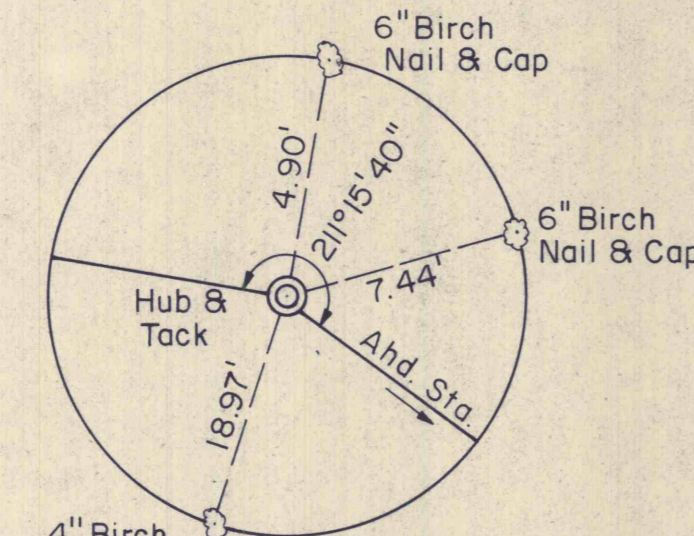

STA. 71+80 E

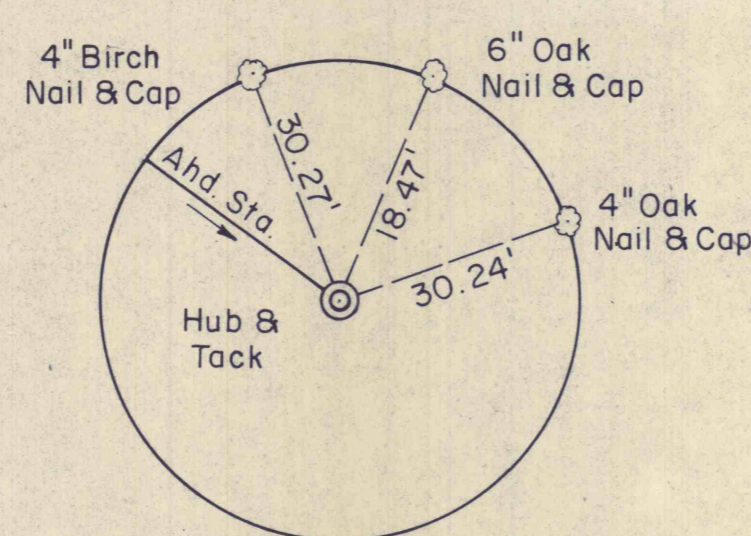

STA. 72+69 E

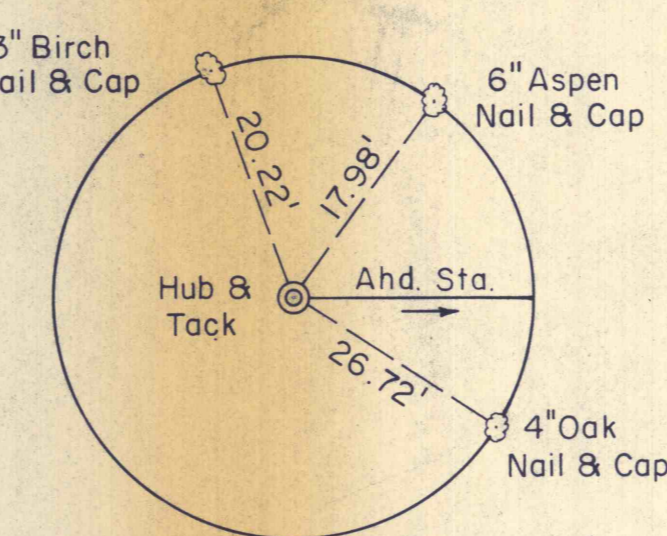

STA. 132+55 E =
STA. 132+62 C

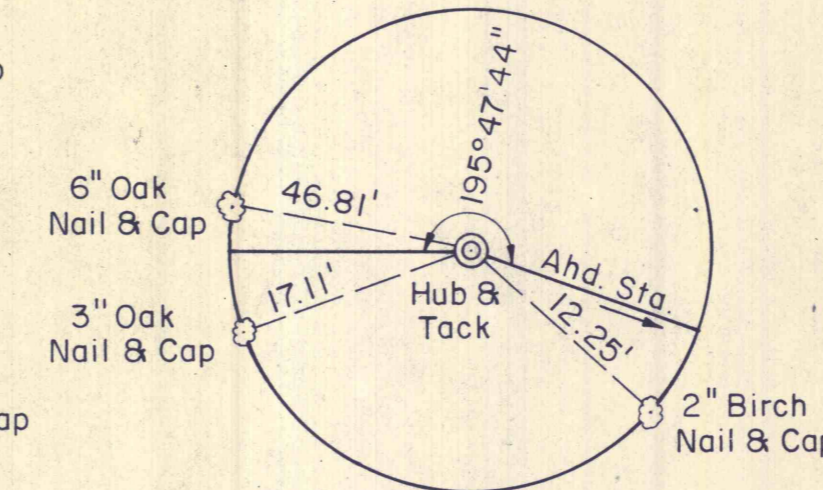

STA. 137+00 E =
STA. C-0+00 C

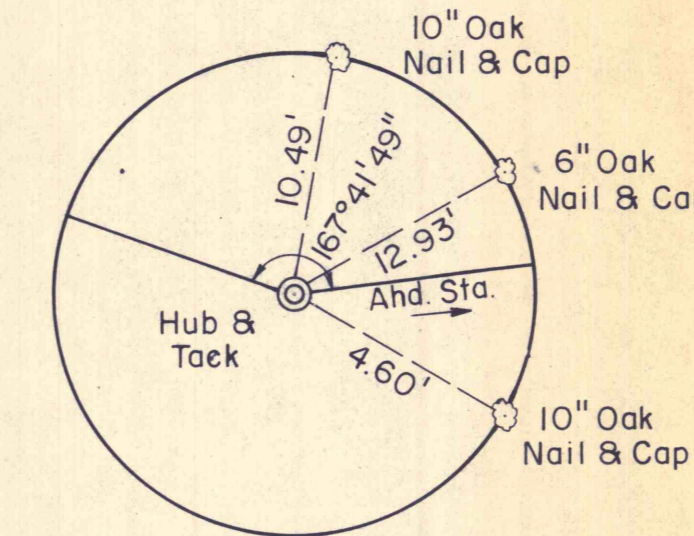

STA. 142+48 E

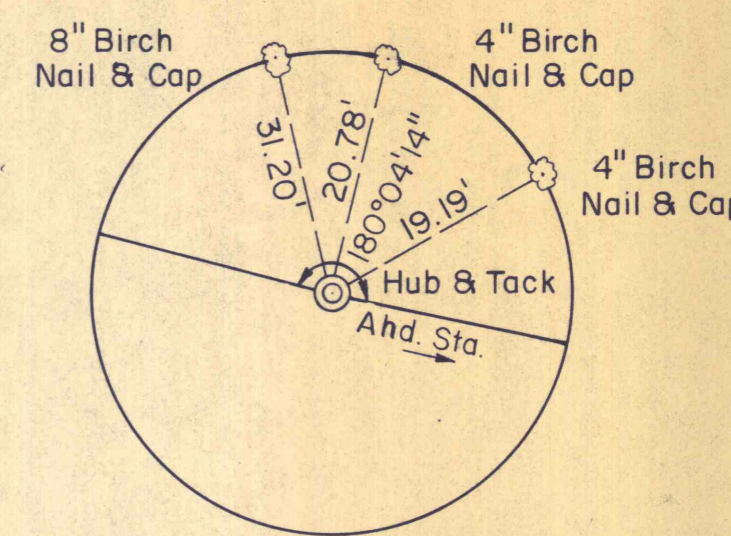

STA. 147+48 E

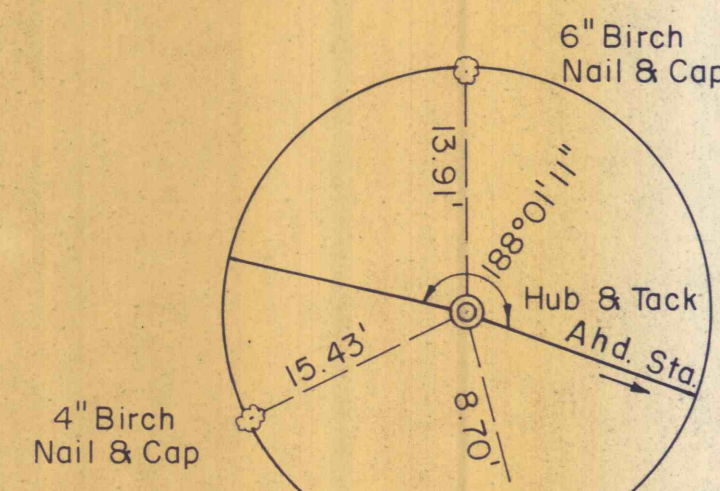

STA. 149+82 E

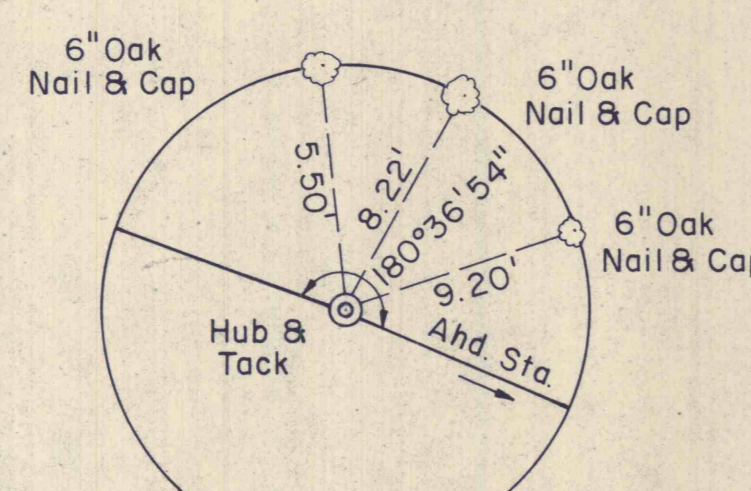

STA. 158+22 E

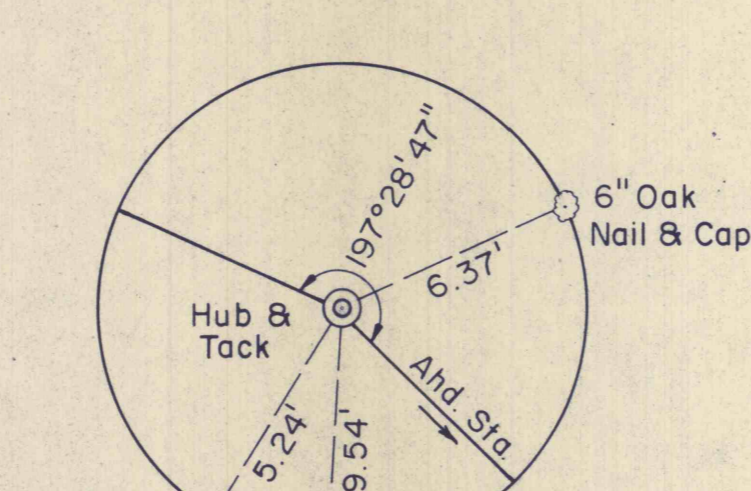

STA. 164+50 E

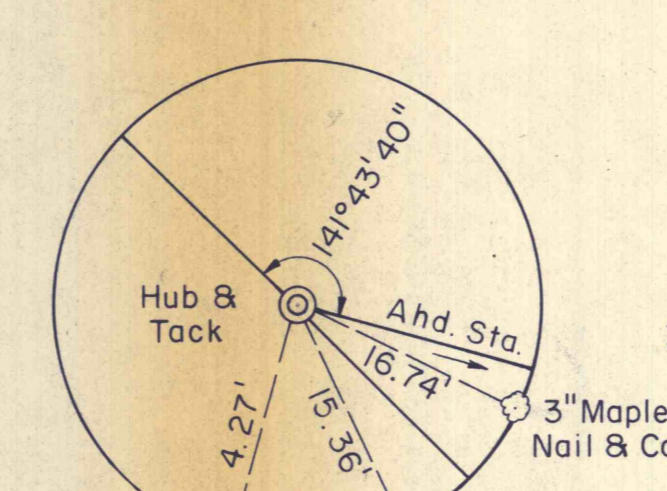

STA. 167+32 E =
STA. E-0+00 C

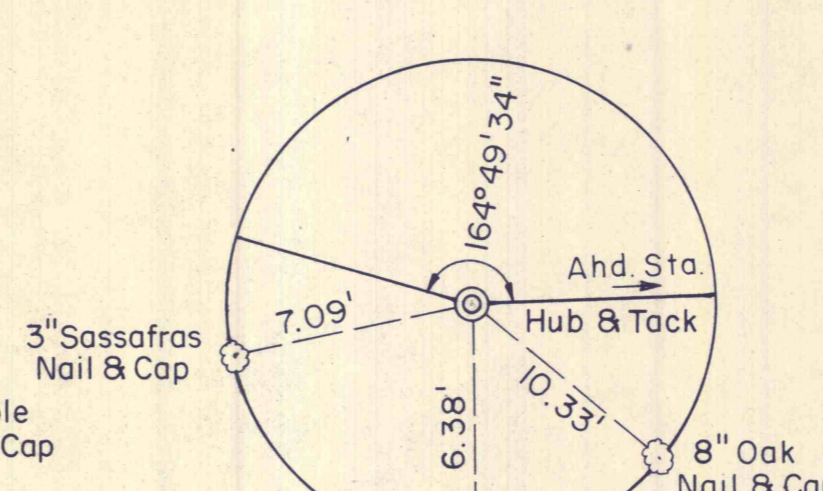

STA. 170+84 E

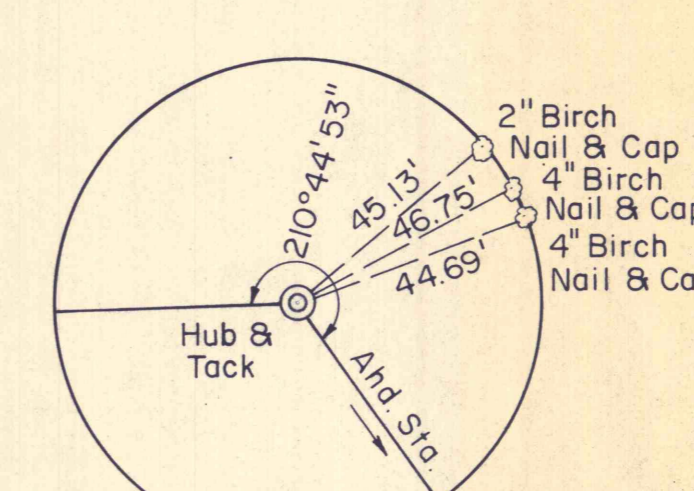

STA. 175+36 E

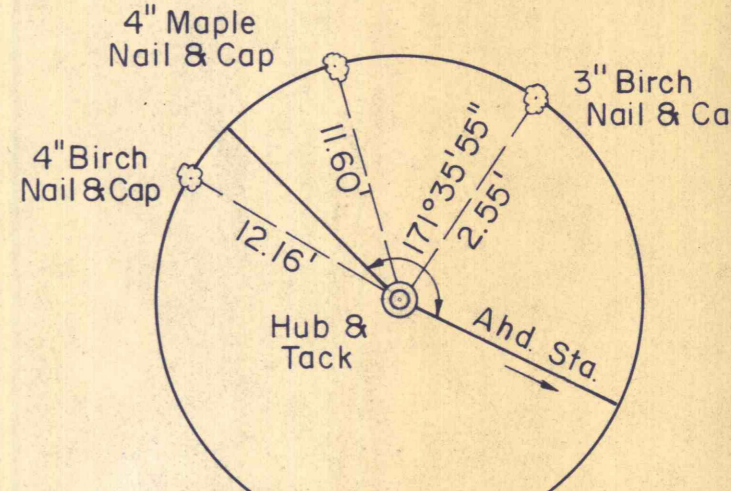

STA. E-3+18 E

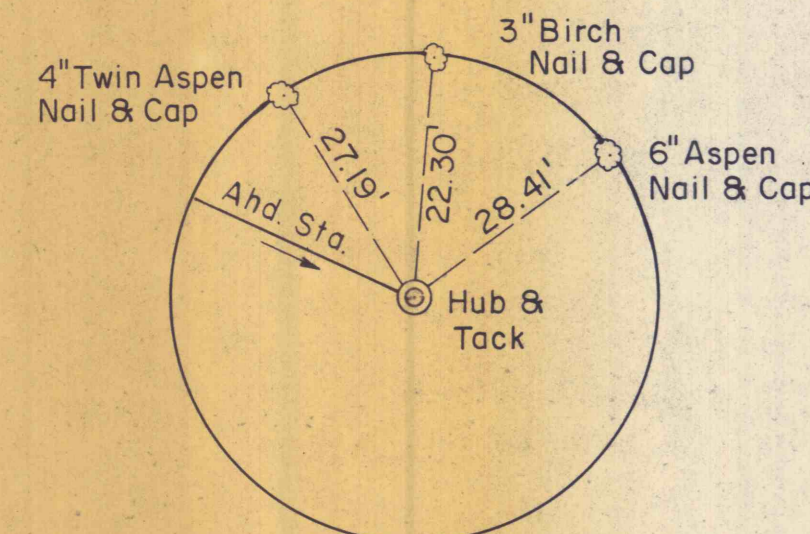

STA. E-7+00 E

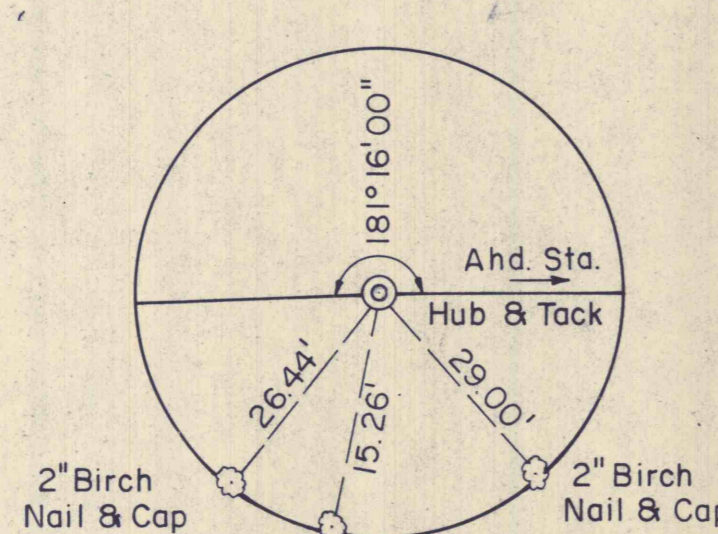

STA. 182+61 E

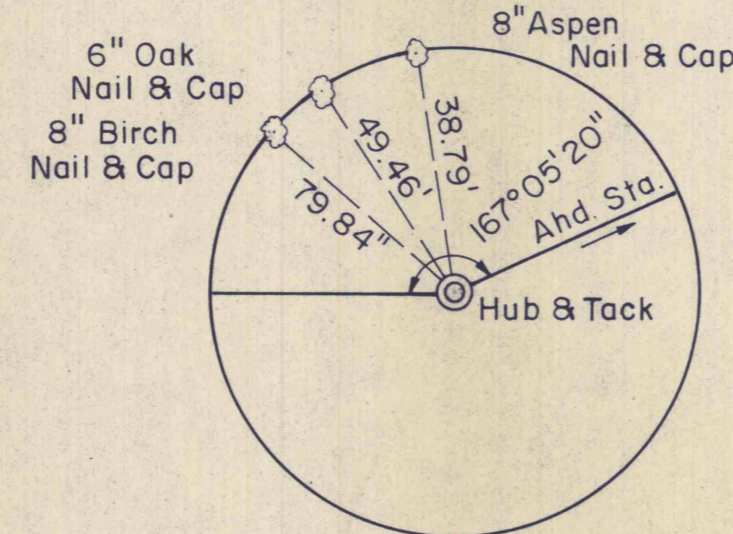

STA. 190+68 E

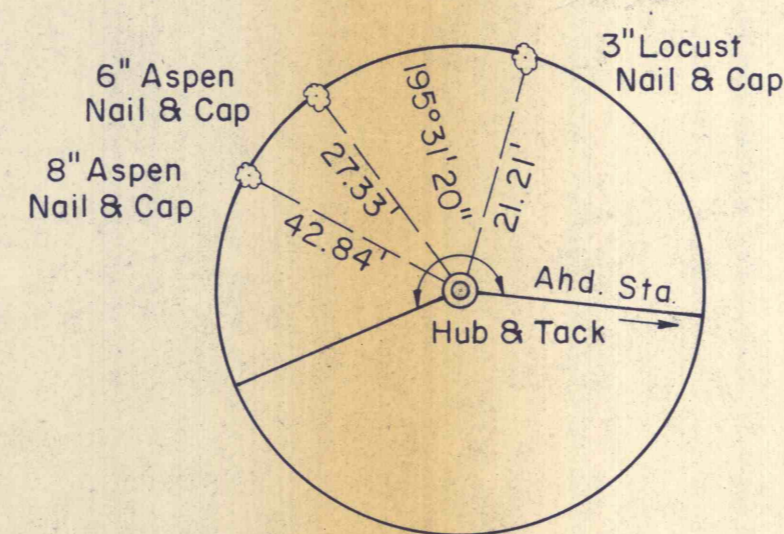

STA. 198+17 E

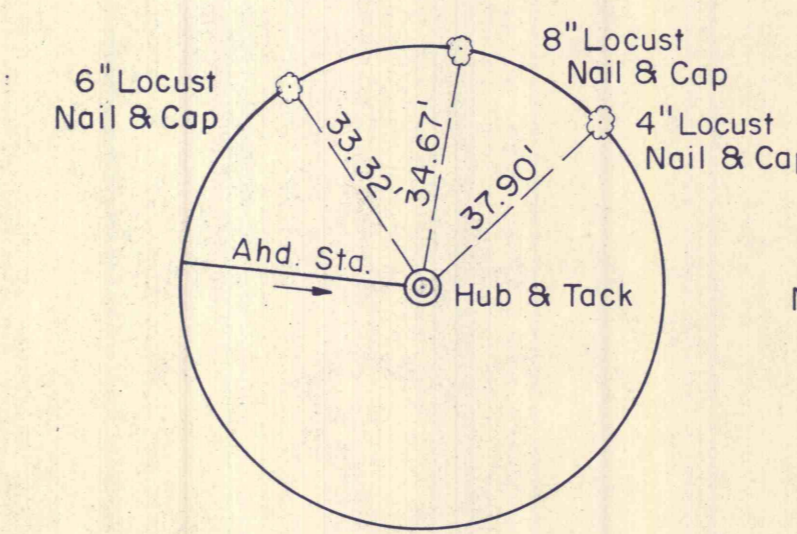

STA. 202+29 E

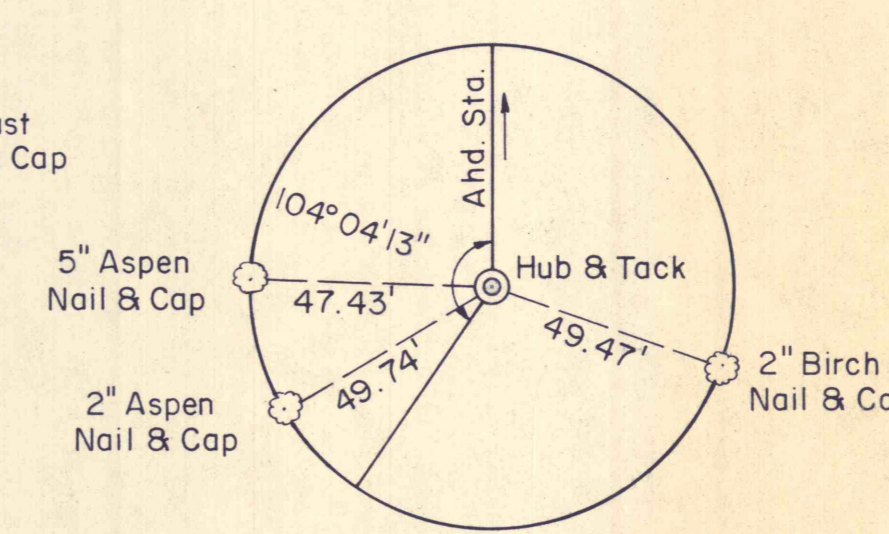

STA. C-4+34 E

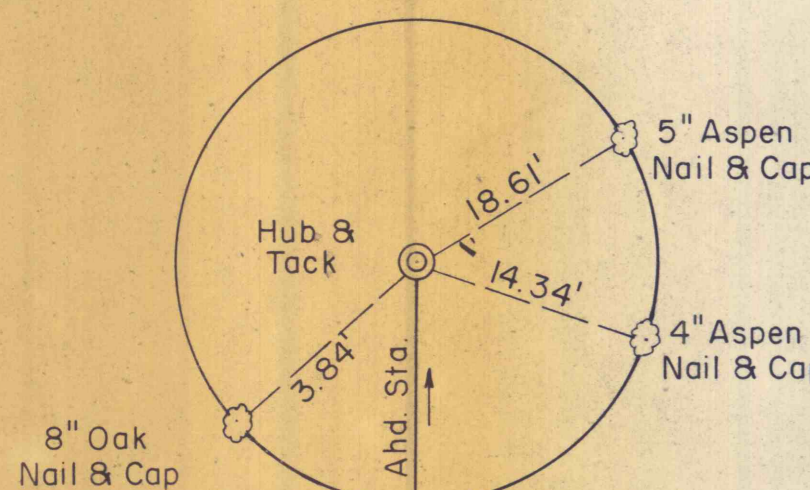

STA. C-8+31 E

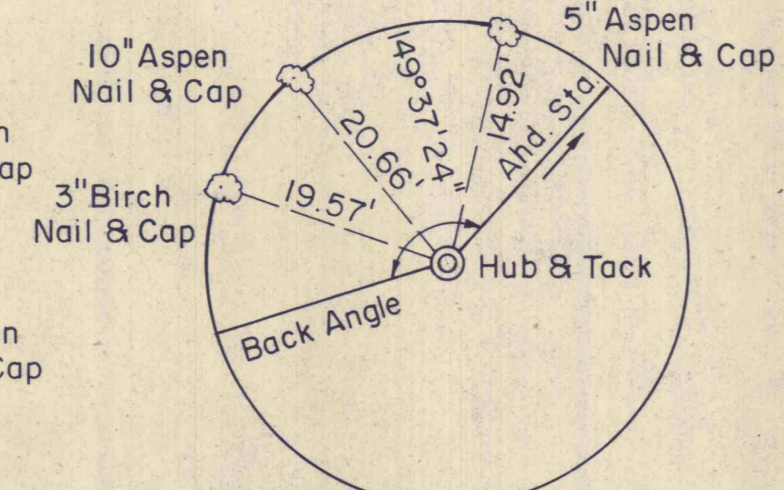

STA. D-0+00 E =
STA. 43+00 C

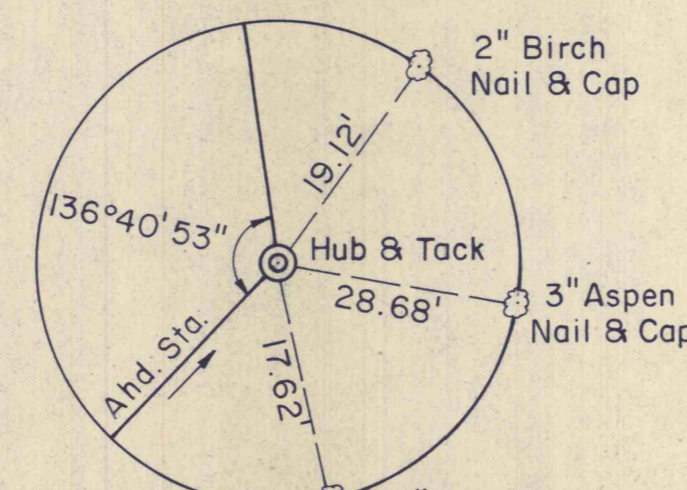

STA. D-6+53 E

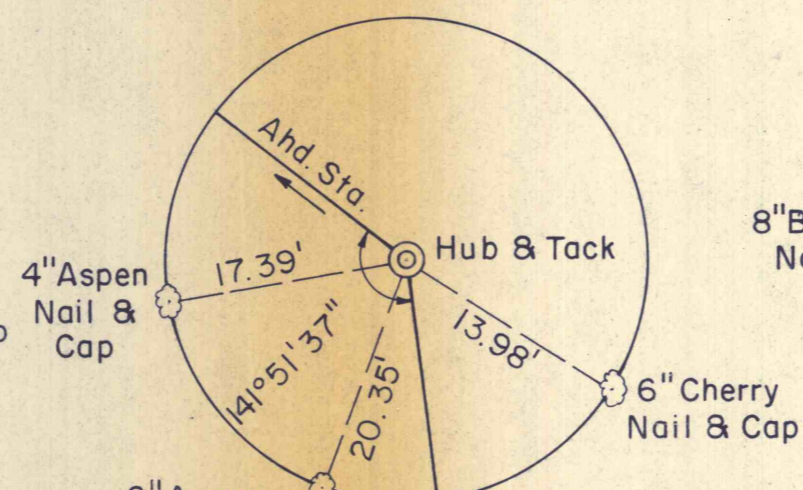

STA. D-8+83 E

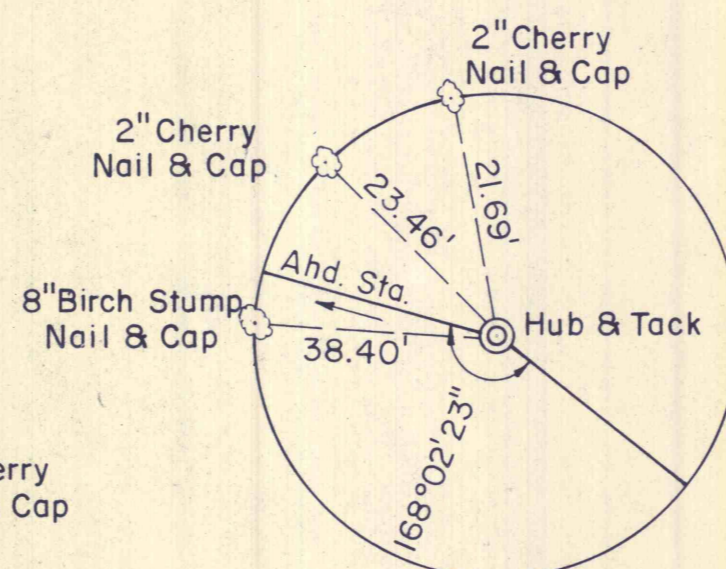

STA. D-12+67 E

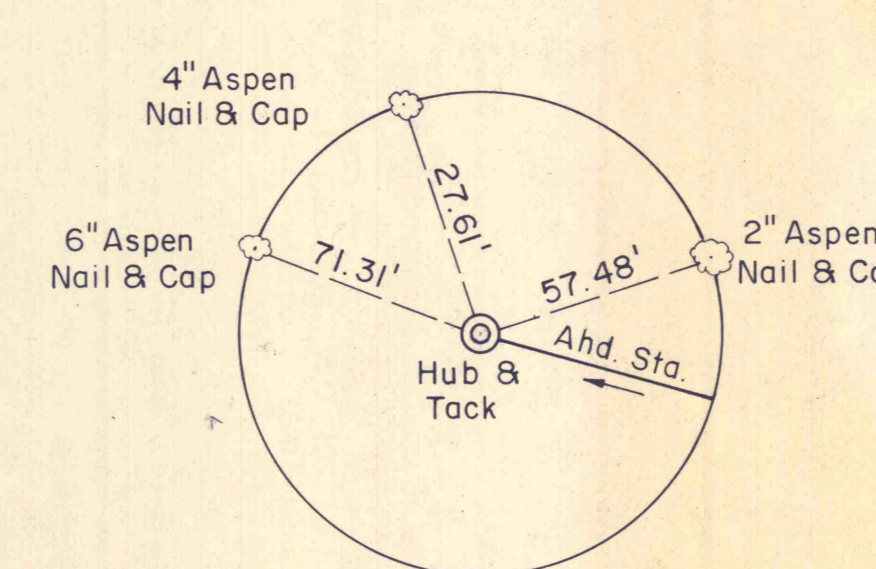

STA. D-17+51 E

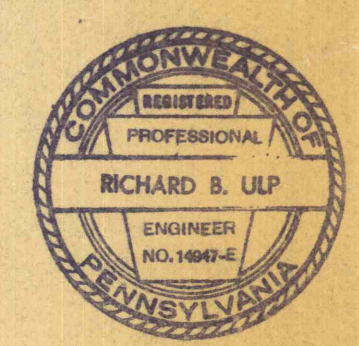
NO	DATE	REVISION	APPR
SUBMITTED			
<i>Richard B. Ulp</i>			
PROFESSIONAL			
APPROVED			
<i>Robert A. Raman</i>			
CHIEF - DIVISION OF MINE RECLAMATION			
APPROVED			
<i>Anthony Erdman</i>			
DIRECTOR - BUREAU OF DESIGN			
			
COMMONWEALTH OF PENNSYLVANIA DEPARTMENT OF ENVIRONMENTAL RESOURCES OFFICE OF RESOURCES MANAGEMENT			
PROJECT NO. SL 113-5-1			
MINE DRAINAGE POLLUTION ABATEMENT COAL RUN SHAMOKIN CREEK WATERSHED NORTHUMBERLAND COUNTY, PA.			
ERDMAN, ANTHONY, ASSOCIATES Consulting Engineers Camp Hill, Pa. Rochester, N.Y.			
REFERENCE TIES			
DRAWN BY	DATE	DRAWING NO.	
GMS	5-9-75	28 of 28	
CHECKED BY	SCALE		
DHC	NO SCALE		

BRUNING 44-142 25788