

N/F Robert J. Rosini

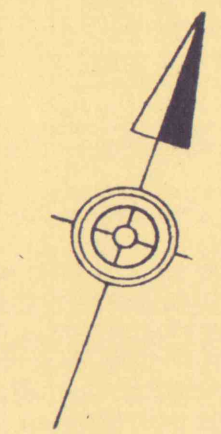

B.M. # 21 Elevation 1319.07  
Spike & Washers in top of 5" Birch Stump

B.M. # 22 Elevation 1345.99  
Spike & Washers in top of 3" Birch Stump

B.M. # 23 Elevation 1361.71  
Spike & Washers in top of 6" Aspen Stump

B.M. # 24 Elevation 1365.99  
X-Cut in top of bolt in Concrete Post

B.M. # 25 Elevation 1379.88  
X-Cut on Metal Bar in Concrete Foundation

Match to Sheet 19

Match to Sheet 16

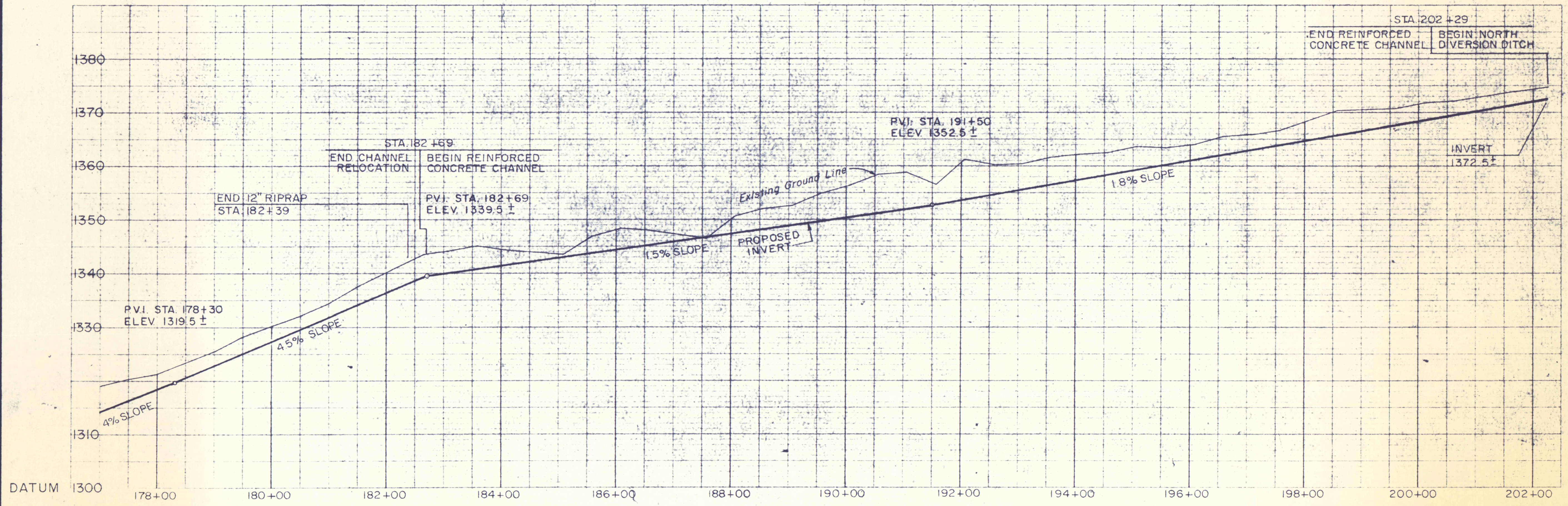
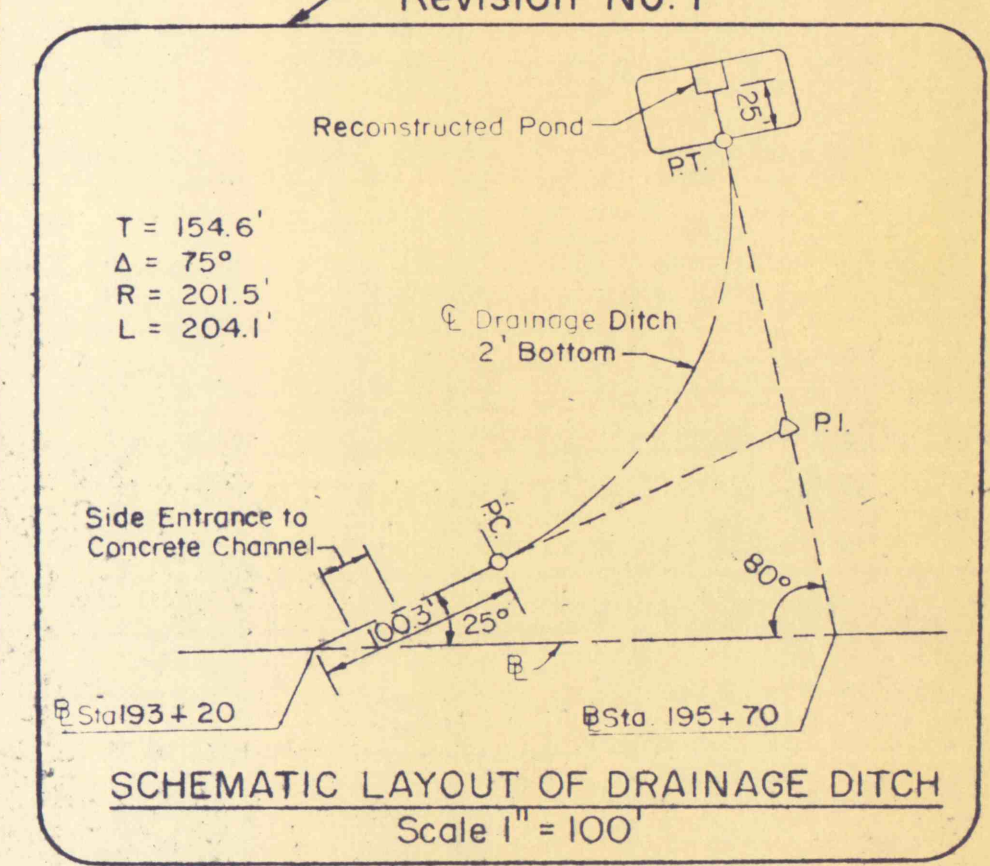
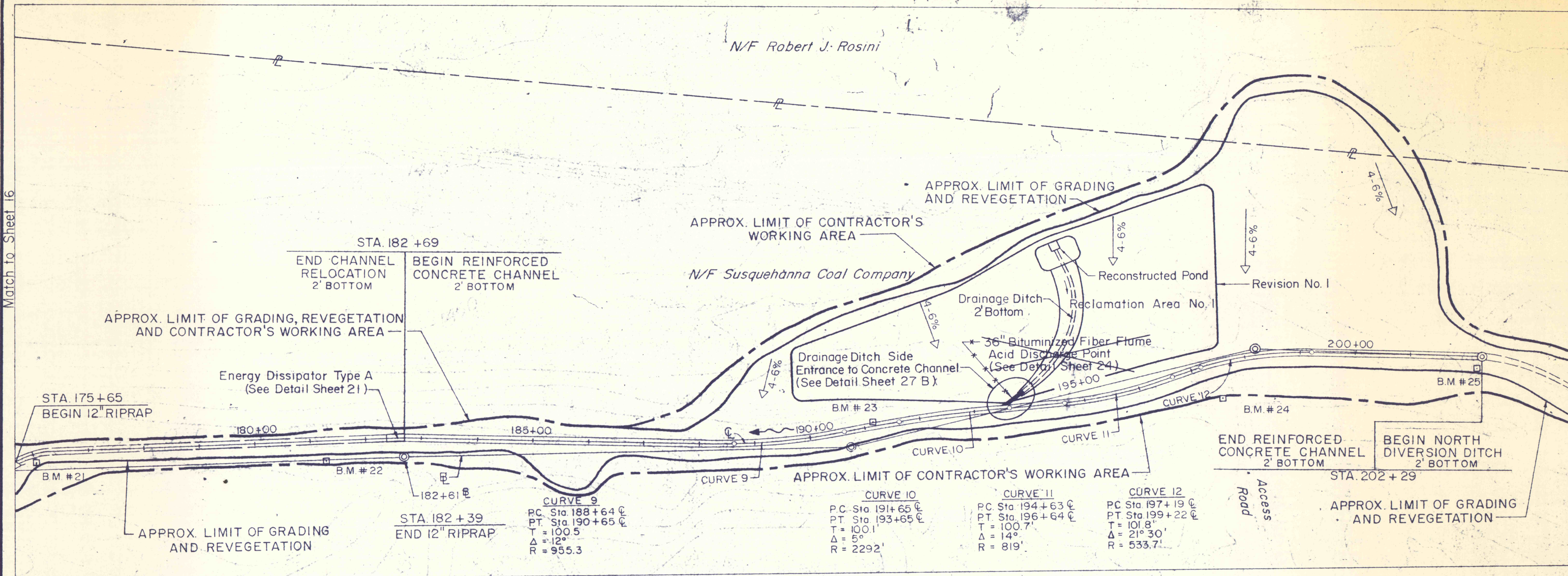

### MAIN CHANNEL

NO.	DATE	REVISION	APPR.
1	8-25-76	Added Reconstructed Pond & Diversion Ditch with Curve Data to Concrete Channel	WLC

SUBMITTED: *Richard B. Ulp*  
PROFESSIONAL

APPROVED: *Robert A. Roman*  
CHIEF, DIVISION OF MINE RECLAMATION

APPROVED: *Dr. [Signature]*  
DIRECTOR - BUREAU OF DESIGN

COMMONWEALTH OF PENNSYLVANIA  
DEPARTMENT OF ENVIRONMENTAL RESOURCES  
OFFICE OF RESOURCES MANAGEMENT

PROJECT NO. SL 113-5-1

MINE DRAINAGE POLLUTION ABATEMENT  
COAL RUN  
SHAMOKIN CREEK WATERSHED  
NORTHUMBERLAND COUNTY, PA.

ERDMAN, ANTHONY, ASSOCIATES  
Consulting Engineers  
Comp. H-11, Pa. Rochester, NY

**PLAN & PROFILE**

DRAWN BY: GMS	DATE: 5-9-75	DRAWING NO:
CHECKED BY: DHC	SCALE: 1" = 10' VERT 1" = 100' HOR	18 of 28