

- B.M. # 12 Elevation 1113.53
□ - Cut on Northwest Corner of Stone Masonry Backwall of Inlet
- B.M. # 13 Elevation 1108.80
Spike & Washers in notch of 8" Birch
- B.M. # 14 Elevation 1124.36
Spike & Washers in top of 6" Aspen Stump
- B.M. # 15 Elevation 1158.99
Spike & Washers in top of 8" Aspen Stump

Match to Sheet 9

Match to Sheet 13

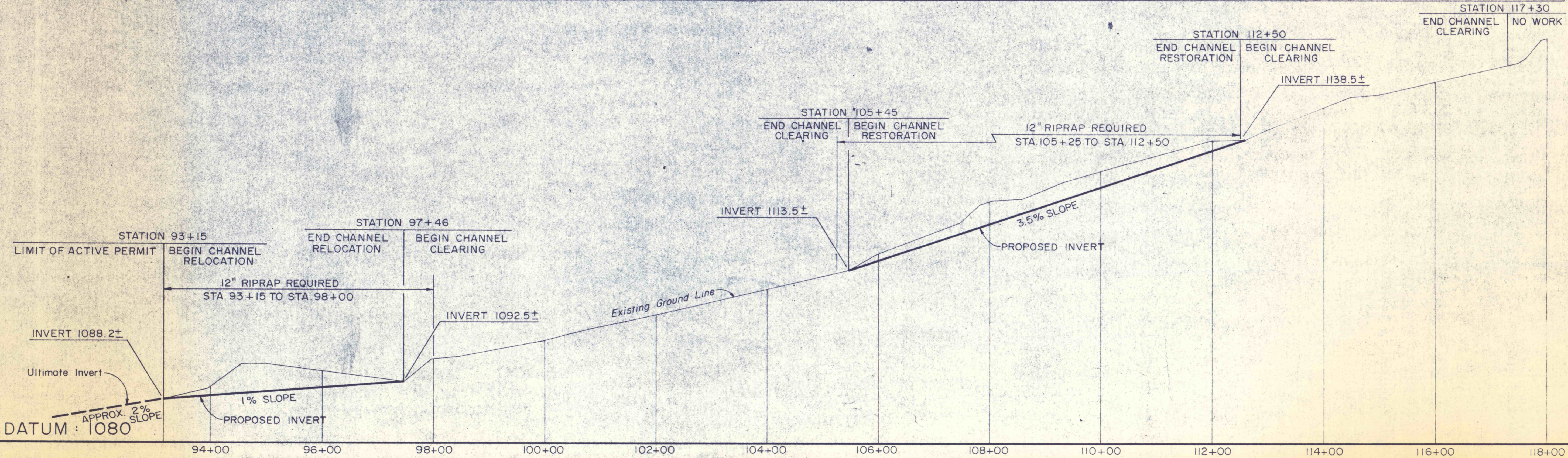
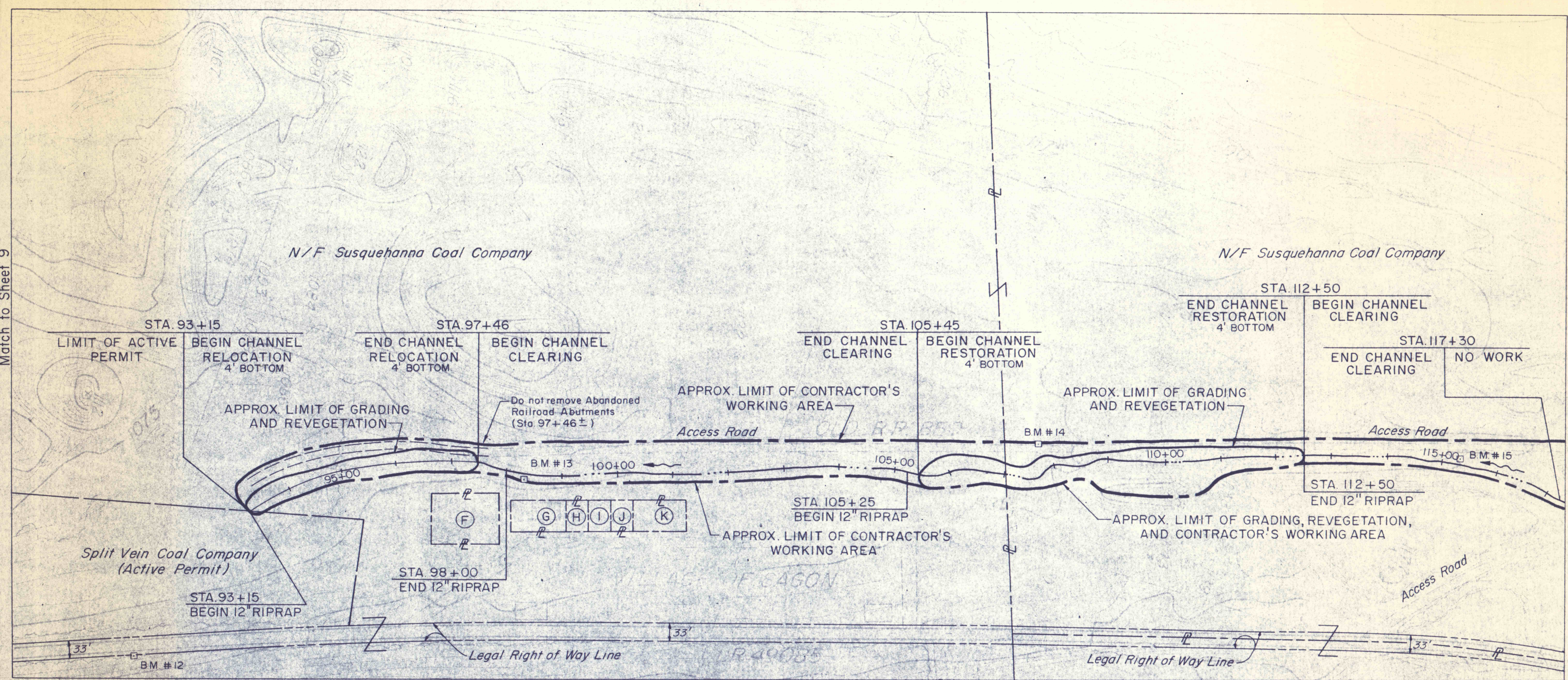

MAIN CHANNEL

- (F) N/F Sagon United Church
- (G) N/F Sagon Community Church
- (H) N/F Hayden & Evelyn Price
- (I) N/F John Zushin
- (J) N/F Wilbur & Dorothy Kerstetter
- (K) N/F Hayden & Evelyn Price

NO	DATE	REVISION	APPR.

SUBMITTED: *Richard B. Ulp*
PROFESSIONAL

APPROVED: *Oliver A. Ramer*
CHIEF - DIVISION OF MINE RECLAMATION

APPROVED: *Anthony Erdman*
DIRECTOR - BUREAU OF DESIGN

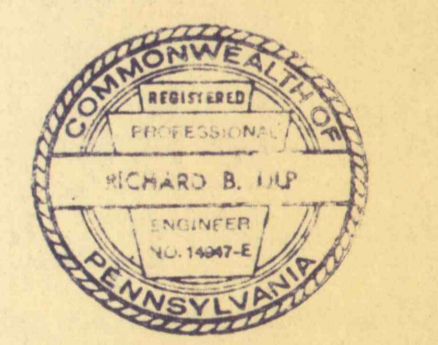

COMMONWEALTH OF PENNSYLVANIA
DEPARTMENT OF ENVIRONMENTAL RESOURCES
OFFICE OF RESOURCES MANAGEMENT

PROJECT NO. SL 113-5-1

**MINE DRAINAGE POLLUTION ABATEMENT
COAL RUN
SHAMOKIN CREEK WATERSHED
NORTHUMBERLAND COUNTY, PA.**

ERDMAN, ANTHONY, ASSOCIATES
Consulting Engineers
Camp Hill, Pa. Rochester, NY

PLAN & PROFILE

DRAWN BY GMS	DATE 5-9-75	DRAWING NO. 10 of 28
CHECKED BY DHC	SCALE 1" = 100' HOR 1" = 10' VERT	