

$$\begin{array}{r} 10.5 \\ 10.5 \\ \hline 21.0 \\ 21.0 \\ \hline 42.0 \\ 42.0 \\ \hline 84.0 \end{array}$$

 100 x 5 = 500
 500 / 10 = 50
 50 x 10 = 500

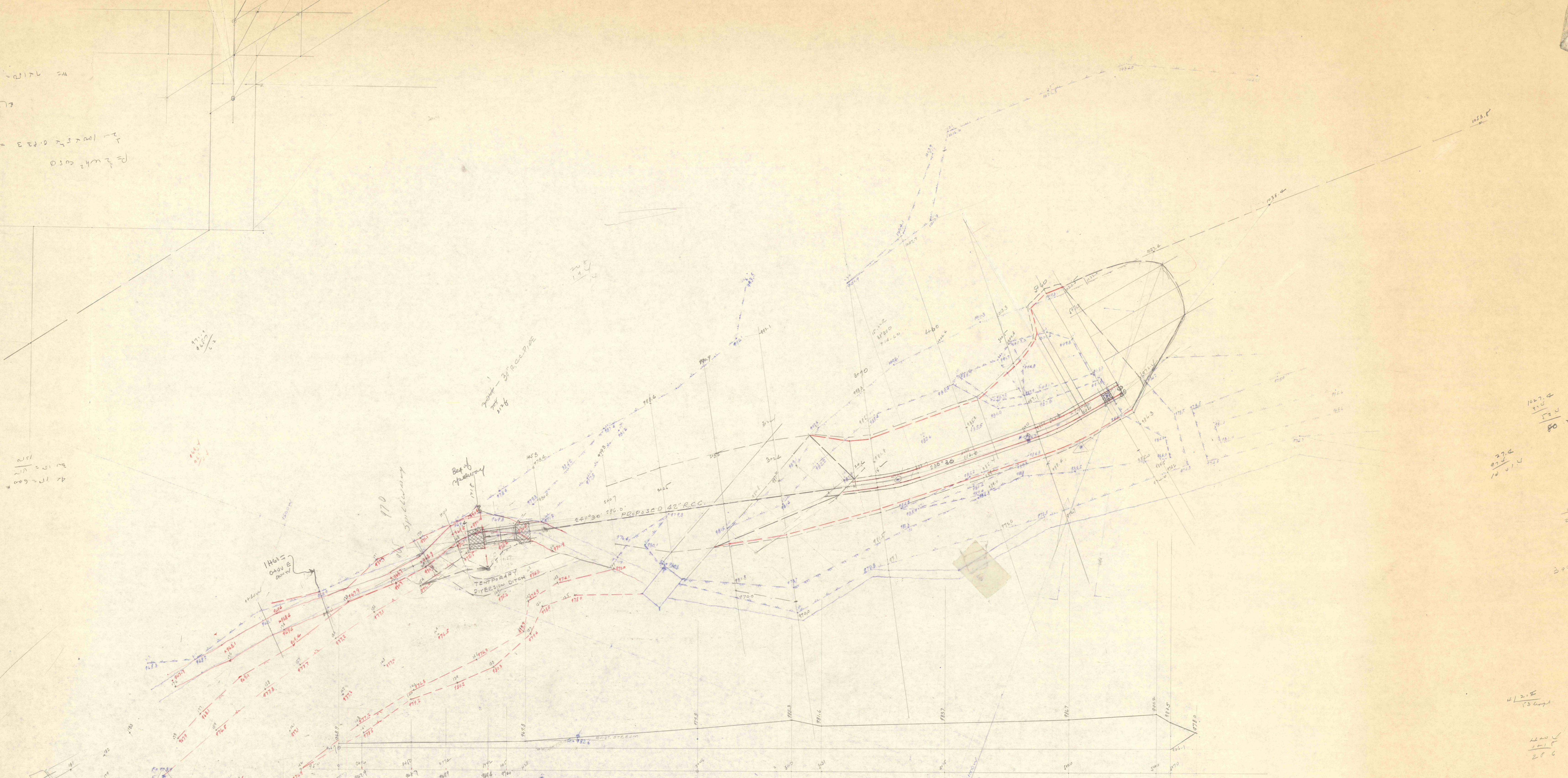

$$\begin{array}{r} 107.4 \\ 11.0 \\ \hline 96.4 \\ 96.4 \\ \hline 192.8 \end{array}$$

$$\frac{39.0 \times 30.0}{2} = 585.0$$

3000

$$\frac{41.5 \times 15.0}{2} = 311.25$$

$$\frac{14.0 \times 10.0}{2} = 70.0$$

1" = 20' vert & horiz.

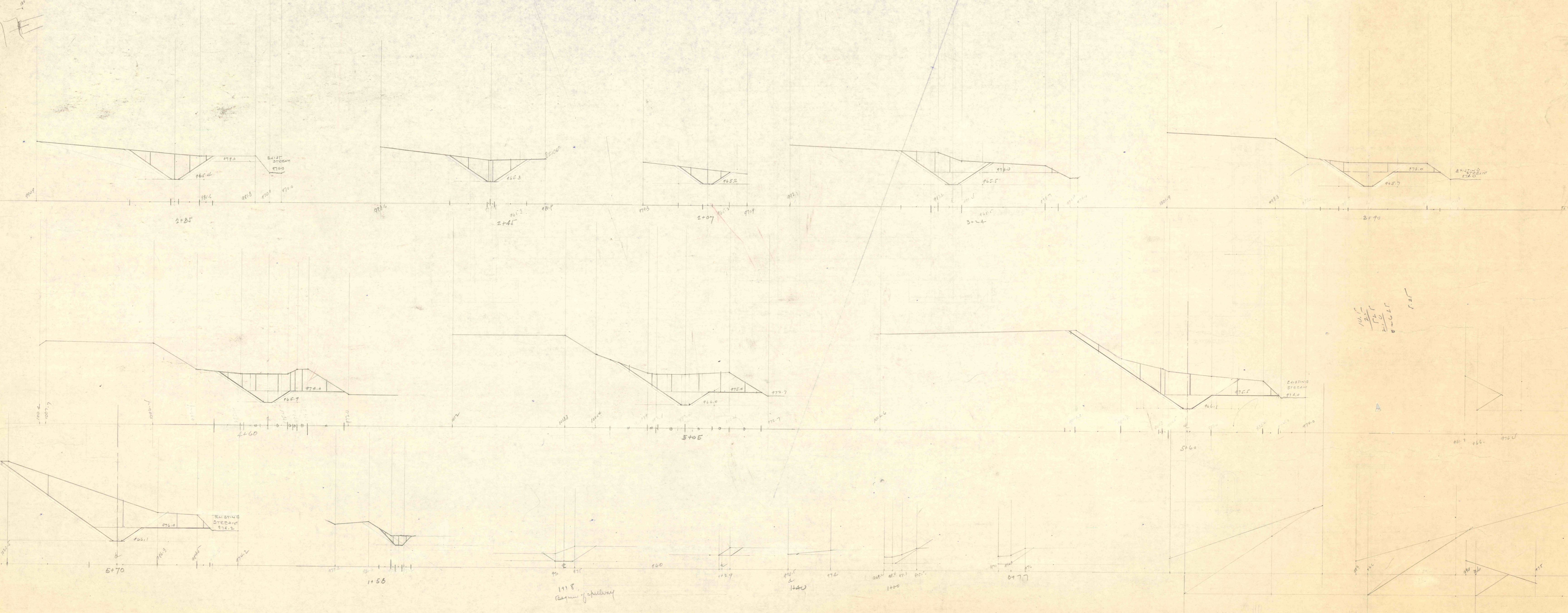

$$\frac{10.0 \times 10.0}{2} = 50.0$$

$$\frac{10.0 \times 10.0}{2} = 50.0$$