

E. 8. 6

20
11000
1000

WESTERN BITUMINOUS MIN CO
WILLIAM SHAIER TRACT

LEGAL COAL CO

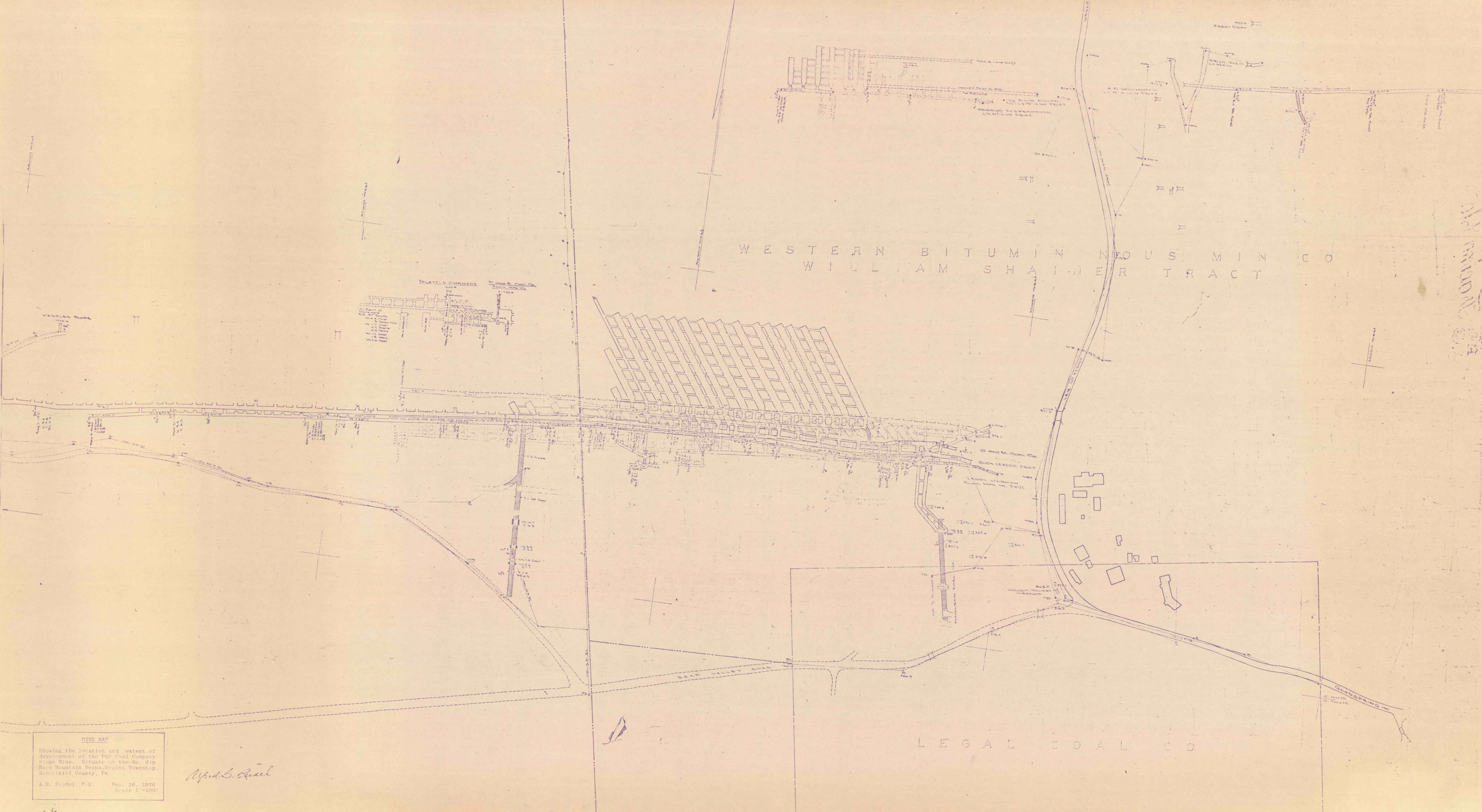

MINE MAP
Showing the location and extent of
development of the P&S Coal Company
Slope Mine. Situate on the So. dip
Buck Mountain Veins, Reigins Township,
Schuylkill County, Pa.
A.B. Riedel, P.E. Feb. 26, 1976
Scale 1"=100'

Alfred S. Riedel

E. 8. 6