

R.M. NO.	ROOM NAME	FLOOR	BASE	WALLS				CEILING	REMARKS
				WEST	EAST	NORTH	SOUTH		
01	CORRIDOR	V.A.T.	VINYL	BLK. PAINT	BLK. PAINT	BLK. PAINT	BLK. PAINT	ACROST 205/20	
02	BLOWER ROOM	CONC.	BLK. PAINT	BLK. PAINT	BLK. PAINT	BLK. PAINT	BLK. PAINT	OPEN	
03	OFFICE	V.A.T.	VINYL	BLK. PAINT	BLK. PAINT	BLK. PAINT	BLK. PAINT	ACROST 205/20	
04	CONTROL ROOM	V.A.T.	VINYL	BLK. PAINT	BLK. PAINT	BLK. PAINT	BLK. PAINT	OPEN	
05	TOILET	C.T.	C.T.	BLK. PAINT	BLK. PAINT	BLK. PAINT	BLK. PAINT	PLAST. SUSP. CLO.	KEENE'S SMOOTH EAST. CLG. PAINTED
06	JANITOR'S ROOM	CONC.	BLK. PAINT	BLK. PAINT	BLK. PAINT	BLK. PAINT	BLK. PAINT	SPEN	
07	SLAKER ROOM	CONC.	BLK. PAINT	BLK. PAINT	BLK. PAINT	BLK. PAINT	BLK. PAINT	OPEN	FLOOR W/ WOOD FLOAT FINISH.
08	MAIN STORAGE	CONC.	BLK. PAINT	BLK. PAINT	BLK. PAINT	BLK. PAINT	BLK. PAINT	OPEN	
09	STORAGE	CONC.	BLK. PAINT	BLK. PAINT	BLK. PAINT	BLK. PAINT	BLK. PAINT	OPEN	
10	LABORATORY	CONC.	BLK. PAINT	BLK. PAINT	BLK. PAINT	BLK. PAINT	BLK. PAINT	OPEN	ACID & ALKALI RESISTANT FLR.
SAMPLE BLDG. # 1, 2, 4, 3.			CONC.	BLK. PAINT	BLK. PAINT	BLK. PAINT	BLK. PAINT	OPEN	(SEE DWG. C-30 & C-31)

NOTE:
1. ALL EXPOSED CONG. FLOORS TO HAVE SEALANT & HARDENER.
2. PITCH ALL FLOORS TO FLOOR DRAINS.

DOOR NO.	TYPE	MAT.	SIZE		FRAME	WALL CONST.	REMARKS
			WIDE	HIGH			
1	E	H.M.	20'-0"	7'-0"	1 1/2"	BLK/BRK	
2	E	H.M.	3'-0"	7'-0"	1 1/2"	BLOCK	
3	E	H.M.	3'-0"	7'-0"	1 1/2"	BLOCK	LOUVER (2'-0" X 1'-0")
4	D	H.M.	3'-0"	7'-0"	1 1/2"	BLOCK	LOUVER (1'-0" X 1'-0")
5	D	H.M.	2'-6"	7'-0"	1 1/2"	BLOCK	
6	D	H.M.	3'-0"	7'-0"	1 1/2"	BLK/BRK	OPERABLE LOUVER (2'x3'x10')
7	A	H.M.	3'-0"	7'-0"	1 1/2"	BLOCK	
8	A	H.M.	3'-0"	7'-0"	1 1/2"	BLOCK	VV/LOUVER (2'x4' x 6" FREE)
9	C	ALUM.	10'-0"	11'-0"		BLOCK	ALUMINUM ROLLING DOOR MTR./MPP
10	D	H.M.	3'-0"	7'-0"	1 1/2"	BLOCK	
11	B	H.M.	3'-0"	7'-0"	1 1/2"	BLOCK	
12	E	H.M.	3'-0"	7'-0"	1 1/2"	BLK/BRK	
13	E	H.M.	3'-0"	7'-0"	1 1/2"	BLOCK	
14	F	H.M.	3'-0"	7'-0"	1 1/2"	BLOCK	LOUVER (2'-0" X 2'-0")
15	A	H.M.	3'-0"	7'-0"	1 1/2"	BLK/BRK	
16	A	H.M.	3'-0"	7'-0"	1 1/2"	BLK/BRK	
17	A	H.M.	3'-0"	7'-0"	1 1/2"	BLK/BRK	

NOTE:
1. ALL EXTERIOR DOORS TO BE WEATHER-TIGHT.
2. DOOR # 17, 16, 17 ARE LOCATED @ SAMPLE BUILDINGS # 1, 2, 4, 3. (SEE DWG. C-30 & C-31)

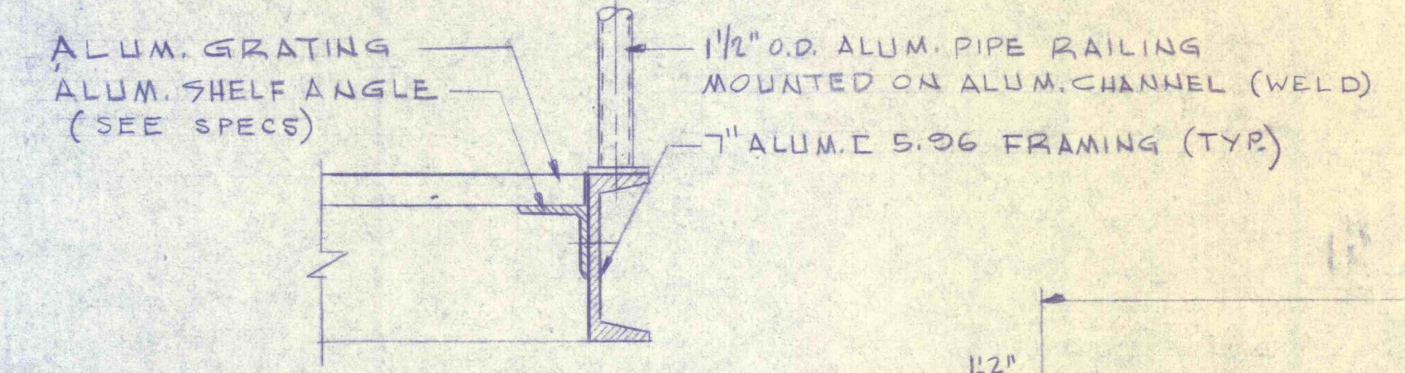
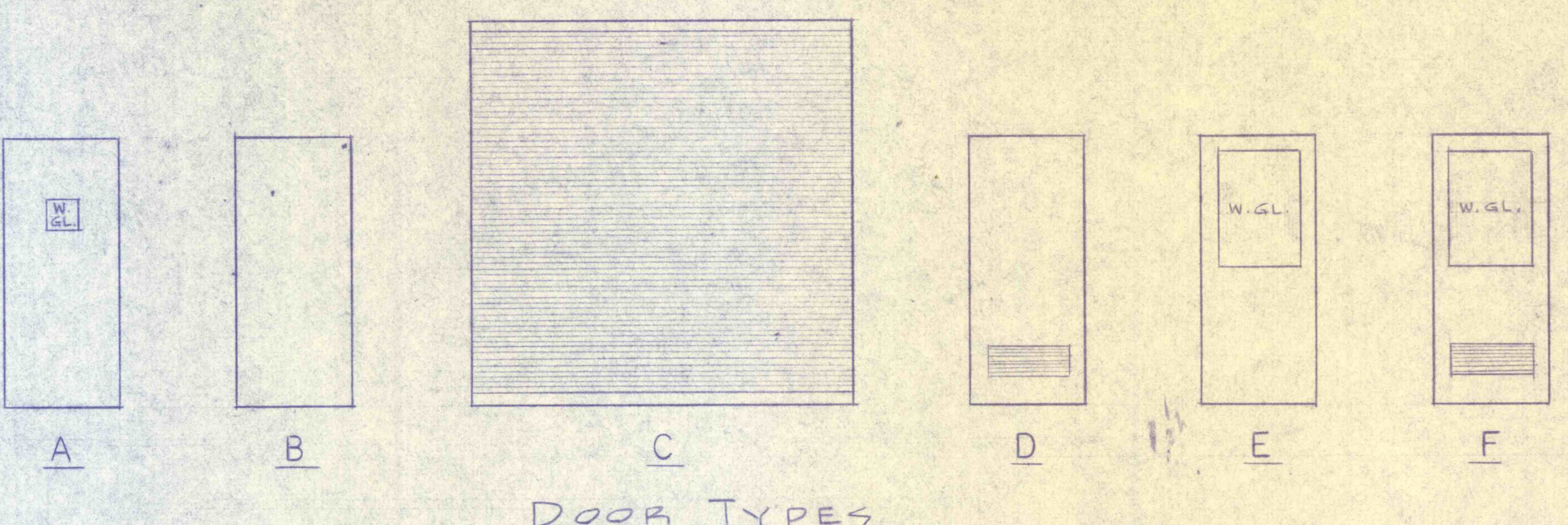

MARK	M.O. (SHA)	DESCRIPTION	SHAPE
L-1	4-5/8"	12 B 14 W 1/2" R (WELD TO BEAM)	I
L-2	6-4"	8 B 10 W 1/2" R (WELD TO BEAM)	I
L-3	6-4"	12 B 14 W 1/2" R (WELD TO BEAM)	I
L-4	4-5/8"	8 B 10 W 1/2" R (WELD TO BEAM)	I
L-5	10'-0"	1" x 3" x 6" BOTTOM-BENT UP 2" x 4" TOP BARS.	---
L-6	3'-0"	ST 5 WF 14.5	I
L-7	3'-4"	ST 5 WF 14.5	I
L-8	7'-3"	10 WF 21 W 1/2" x 1/2" PLATE (WELD TO BEAM 7'-0" FROM FIN. FLOOR.)	---
L-9	15'-5 7/8"	8 B 10 W 1/2" R (WELD TO BEAM)	I

NOTE: ALL LINTELS TO HAVE AN 8" MINIMUM WALL BEARING EA. SIDE.

NOTE: LINTEL - ST 5 WF 14.5 FOR OPENINGS @ 6" BLK. WALLS FOR MECH. EQUIP. IF REQ'D.

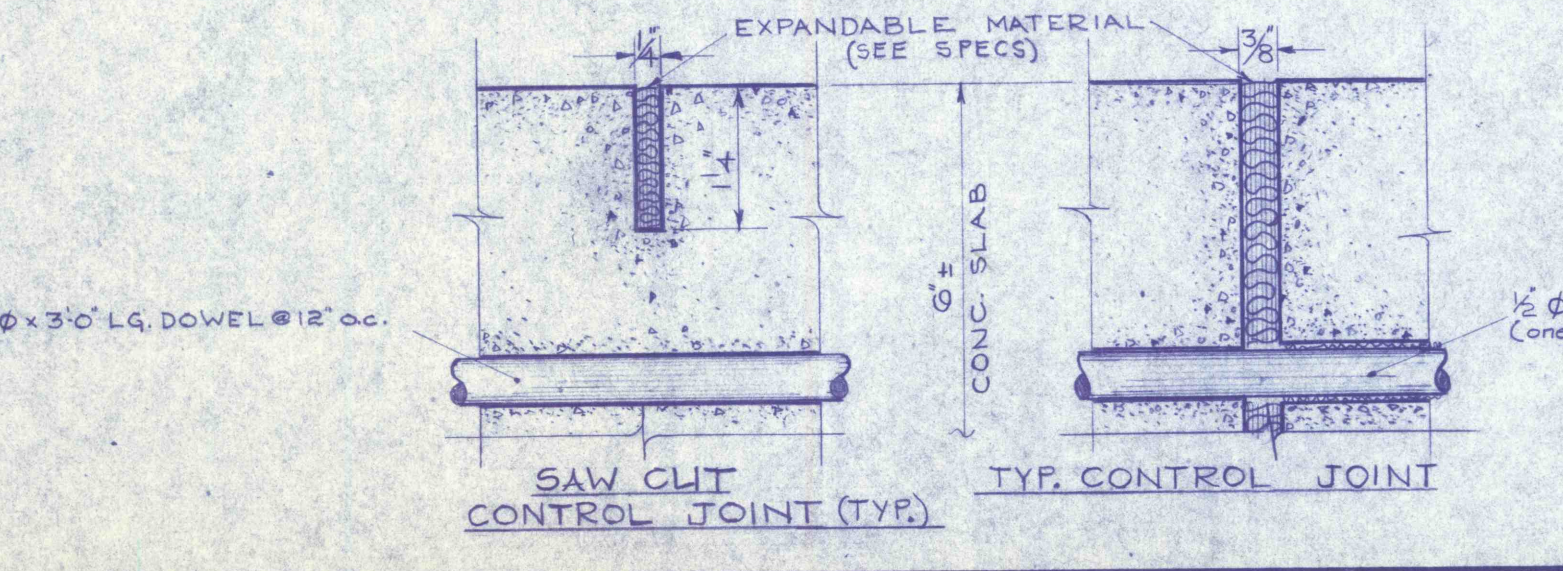
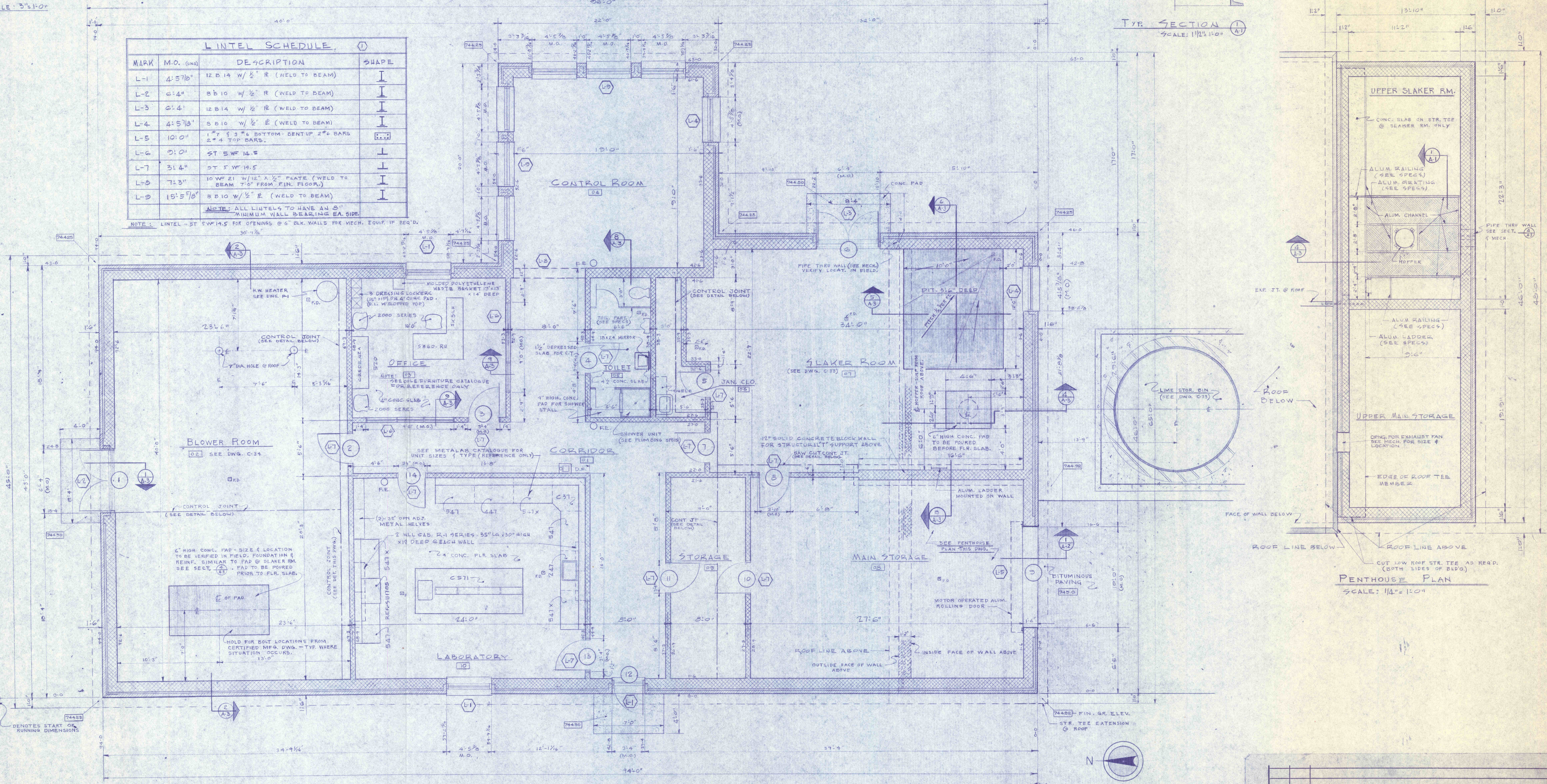

NOTE:
1. BUILD ALL INTERIOR PARTITIONS TO UNDERSIDE OF ROOF. (C.M.-O.)
2. GENERAL CONTRACTOR TO VERIFY ALL DIMENSIONS IN FIELD.
3. ALL INTERIOR PARTITIONS ARE 6" CONC. BLK. UNLESS NOTED OTHERWISE.
4. 2" x 6" x 0' L.G. ANCHOR BOLTS
6'-0" STR. - 2'-0" BENT
4 REQUIRED

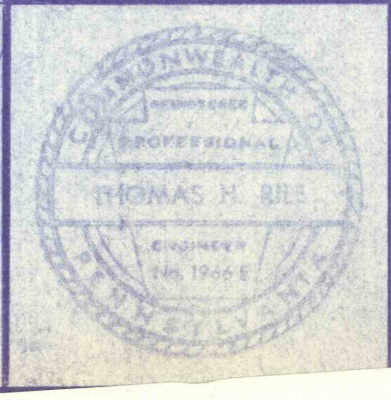

REVISIONS	

FLOOR PLAN - SCHEDULES - DETAILS

CONSTRUCTION OF TREATMENT FACILITIES FOR ACID MINE DRAINAGE
RAUSCH CREEK WATERSHED
SCHUYLKILL COUNTY PENNSYLVANIA

ANTRACITE RESEARCH & DEVELOPMENT CO. INC.
consulting engineers
POTTSVILLE PENNSYLVANIA

JOB NO: 6805
DATE: JAN. 1970
SCALE: AS NOTED
DRAWN: A.E. - W.J.F.
APPROVED: T.H.R. - J.J.L.

DRAWING NO: A-1