

Scale: 1" = 20' HORIZ.  
 1" = 5' VERT.  
 Drawn - R. Yeat  
 Survey - J. Bayer

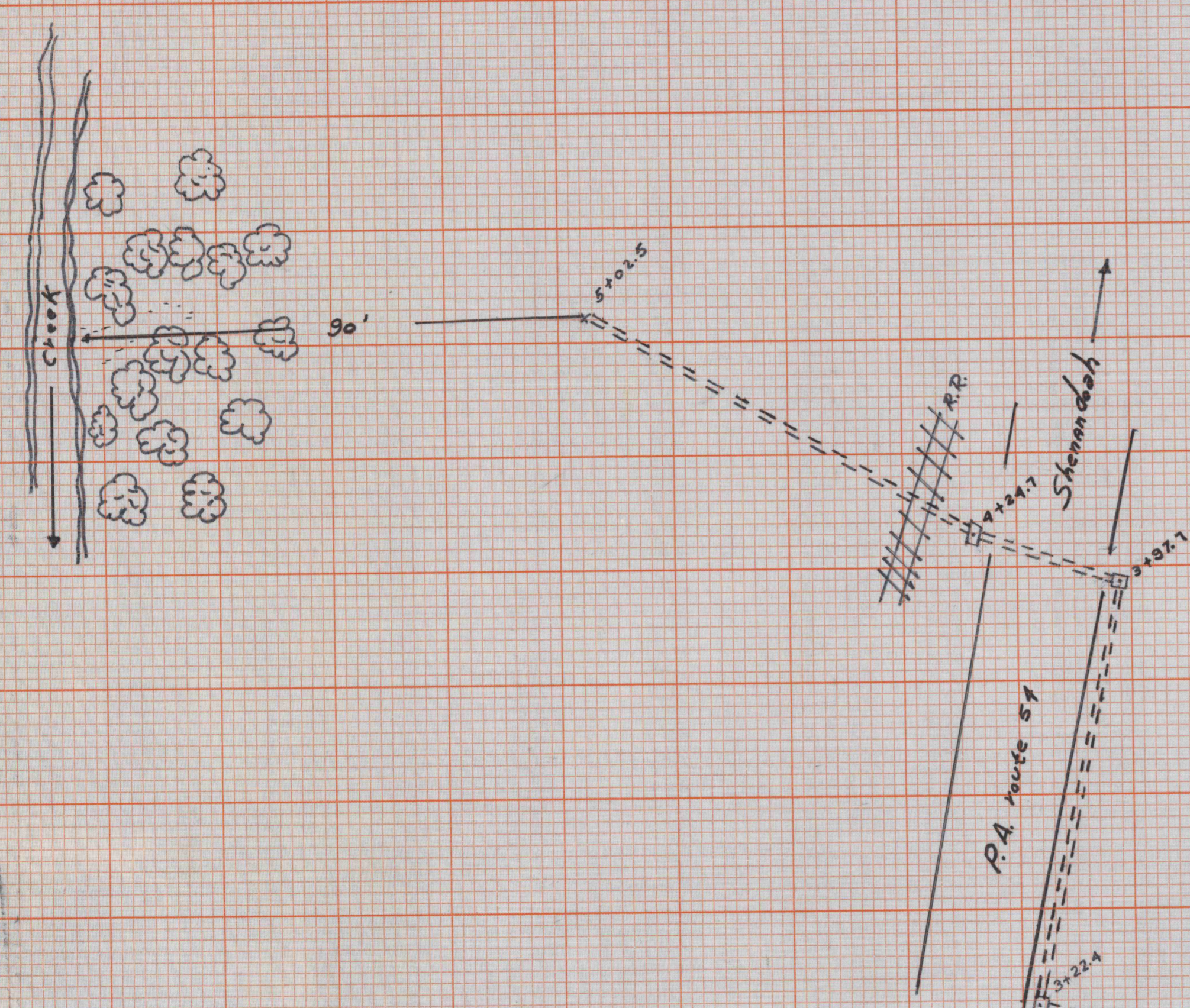

LOST CREEK PIPELINE 1.0% GRADE  
 WESTERN MIDDLE FIELD  
 MINNANDY TWP - SCHUYLKILL COUNTY  
 BTM OF 117N.

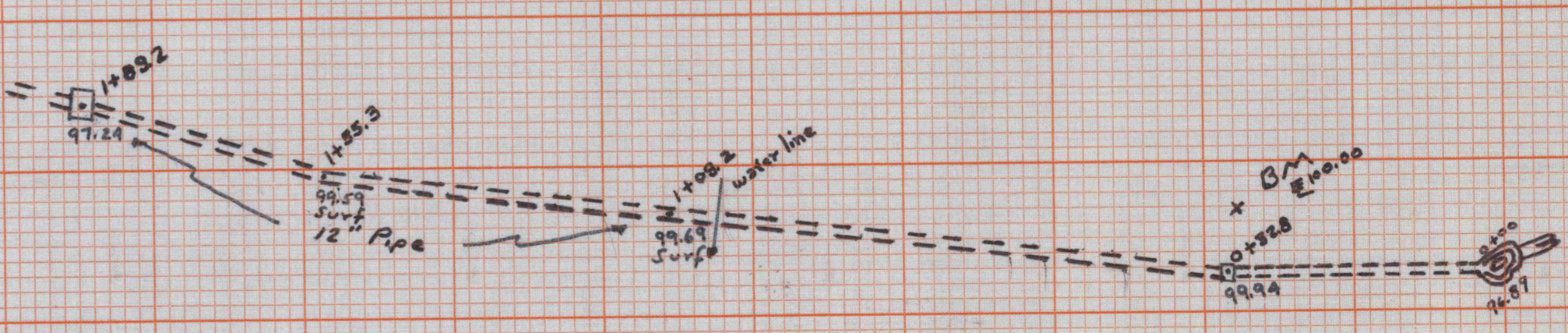

Scale 1" = 20'  
 Drawn - R. Yeat  
 Survey - J. Bayer