

B.M. EL. 1020.06
 □ CUT IN ROCK
 STA 18+55-67 LT. SURV. E

SURVEY E DATA
 P.I. STA. 17+00
 Δ - 24° 52' 50" RT.

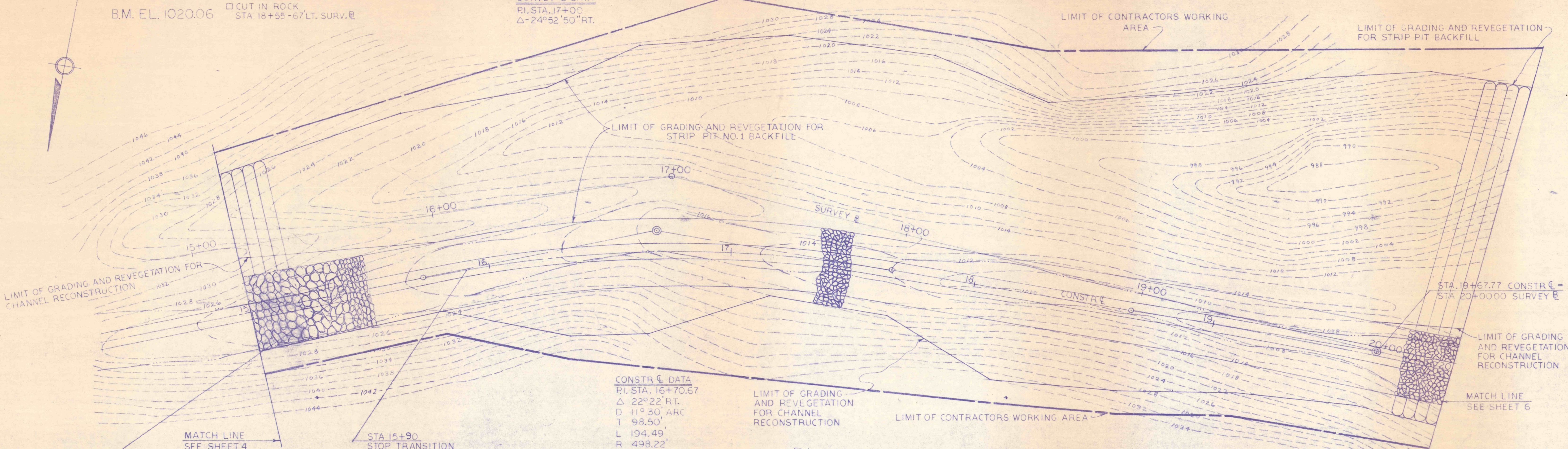
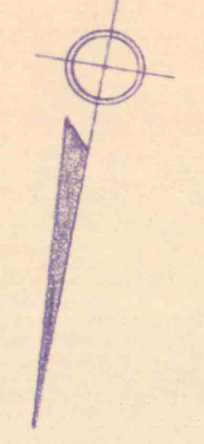

CONSTR. C DATA
 P.I. STA. 16+70.67
 Δ 22° 22' RT.
 D 11° 30' ARC
 T 98.50'
 L 194.49'
 R 498.22'
 E 9.64'
 P.C. STA. 15+72.17
 P.T. STA. 17+66.66

LIMIT OF GRADING AND REVEGETATION FOR CHANNEL RECONSTRUCTION

LIMIT OF CONTRACTORS WORKING AREA

LIMIT OF GRADING AND REVEGETATION FOR CHANNEL RECONSTRUCTION

PLAN
 SCALE: 1" = 20'

CONSTR. C DATA
 P.I. STA. 19+67.77
 Δ 5° 08' RT
 D 2° 30' ARC
 T 102.74'
 L 205.33'
 R 2291.83'
 E 2.30'
 P.C. STA. 18+65.03
 P.T. STA. 20+70.36

PVI STA. 15+00
 ELEV. 1019.77
 VC 200'
 MO 1.55'

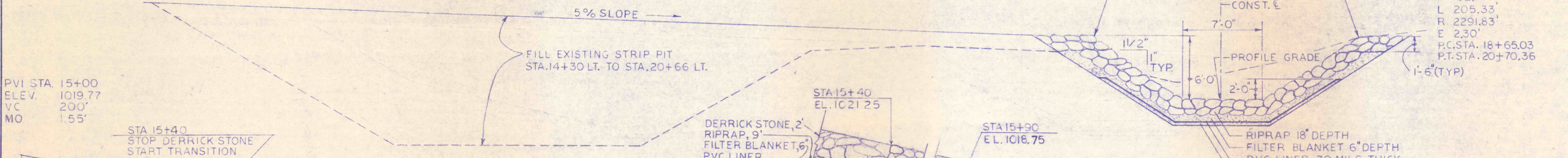

STA 15+40 STOP DERRICK STONE START TRANSITION
 STA 15+90 STOP TRANSITION START RIPRAP

STA 15+40 EL. 1021.25

STA 15+90 EL. 1016.75

DERRICK STONE, 2'
 RIPRAP, 9'
 FILTER BLANKET, 6"
 PVC LINER
 SAND, 3"

RIPRAP, 18" DEPTH
 FILTER BLANKET, 6" DEPTH
 PVC LINER 30 MILS THICK
 SAND 3" DEPTH

STA 15+40 EL. 1017.75
 STA 15+90 EL. 1016.50

TRANSITION SECTION
 SCALE 1" = 4'

TYPICAL SECTION
 STA. 15+90 TO STA. 19+50
 SCALE 1" = 5'

PVI STA. 19+50
 ELEV. 1006.95
 V.C. 100'
 M.O. 0.07'

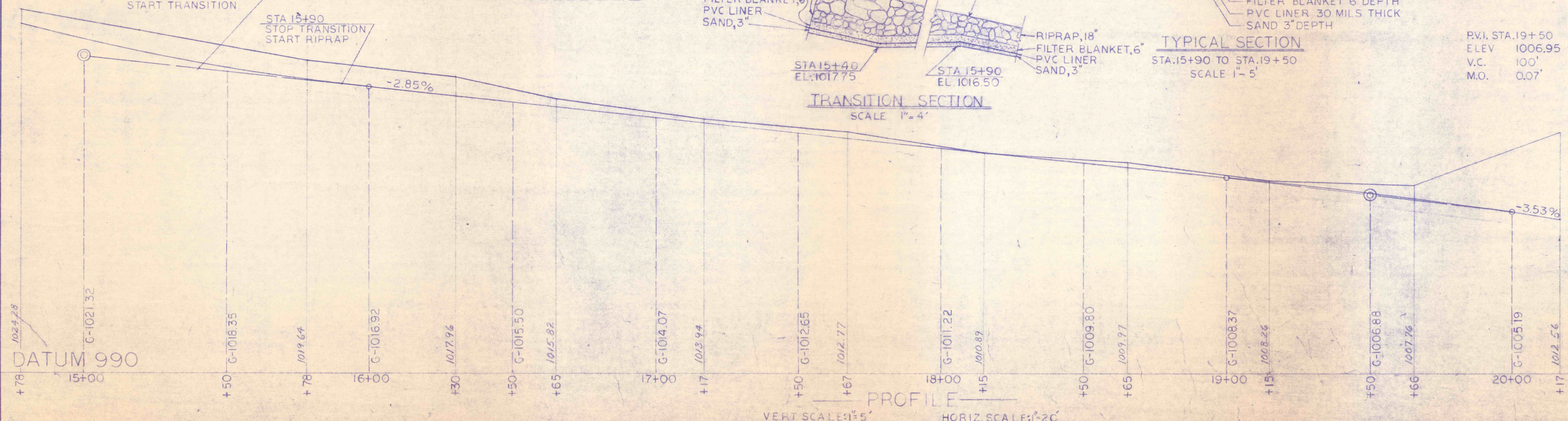

NO.	DATE	REVISION	APPR.

SUBMITTED: *Robert J. Schneider*
 PROFESSIONAL
 APPROVED: _____
 CHIEF - DIVISION OF MINE RECLAMATION
 APPROVED: _____
 DIRECTOR - BUREAU OF DESIGN



COMMONWEALTH OF PENNSYLVANIA
 DEPARTMENT OF ENVIRONMENTAL RESOURCES
 OFFICE OF RESOURCES MANAGEMENT
CONTRACT NO SL 139-1-1
MINE DRAINAGE POLLUTION ABATEMENT
LAUREL RUN
LACKAWANNA RIVER WATERSHED
LACKAWANNA COUNTY, PENNSYLVANIA

ALBERT E. PETERS ASSOCIATES
 Engineers - Designers - Consultants
 301 North Main Avenue
 Scranton, Penna. 18504

PLAN, PROFILE & TYPICAL SECTIONS

DRAWN BY R.E.N.	DATE	DRAWING NO. 5 OF 6
CHECKED BY R.J.S.	SCALE AS NOTED	