

B.M. EL. 1106.54  
 CUT IN ROCK LEDGE  
 STA. 2+10 - 7' RT

**SURVEY B DATA**  
 P.I. STA. 2+00  
 $\Delta = 7^{\circ}46'10''$  LT.

**CONSTR. C DATA**  
 P.I. STA. 2+49.97  
 $\Delta = 13^{\circ}10'$  RT.  
 D 13'00' ARC  
 T 50.87'  
 L 101.23'  
 R 430.74'  
 E 2.95'  
 P.C. STA. 1+99.10  
 P.T. STA. 3+00.38

**SURVEY E DATA**  
 P.I. STA. 3+00  
 $\Delta = 16^{\circ}29'30''$  RT.

**CONSTR. E DATA**  
 P.I. STA. 3+98.51  
 $\Delta = 18^{\circ}18'$  LT  
 D 15'23' ARC  
 T 59.99'  
 L 118.96'  
 R 372.45'  
 E 4.80'  
 P.C. STA. 3+38.52  
 P.T. STA. 4+57.50

**CONSTR. C DATA**  
 P.I. STA. 5+36.51  
 $\Delta = 22^{\circ}13'$  RT.  
 D 15'00' ARC  
 T 75.29'  
 L 148.67'  
 R 381.97'  
 E 7.35'  
 P.C. STA. 4+61.22  
 P.T. STA. 6+09.89

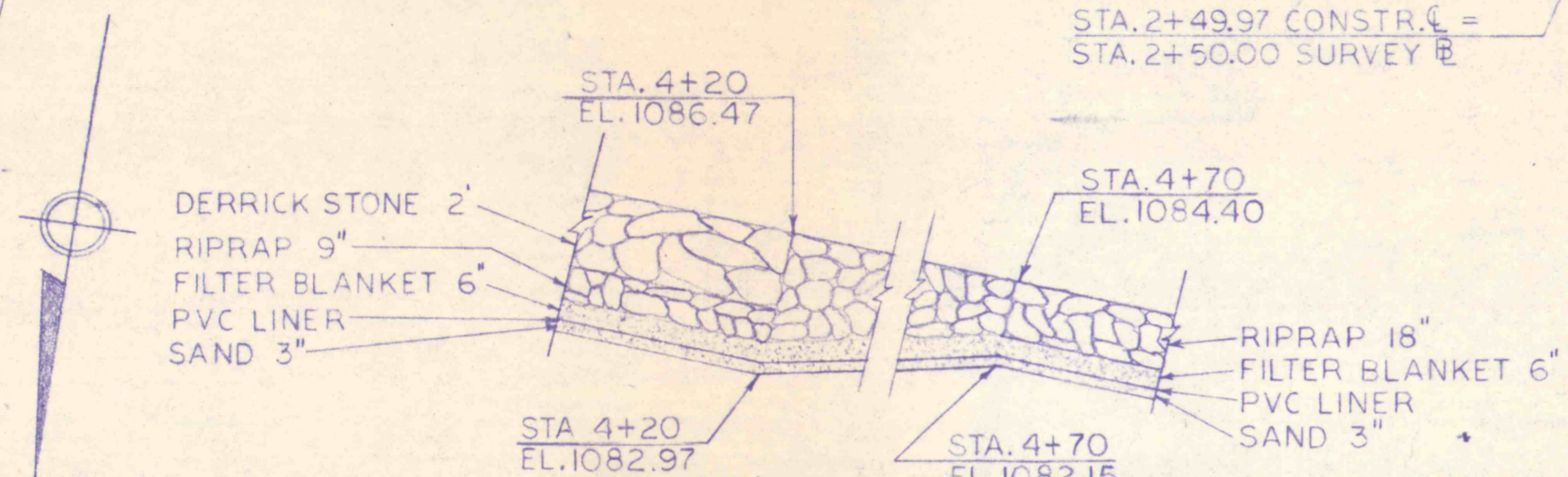
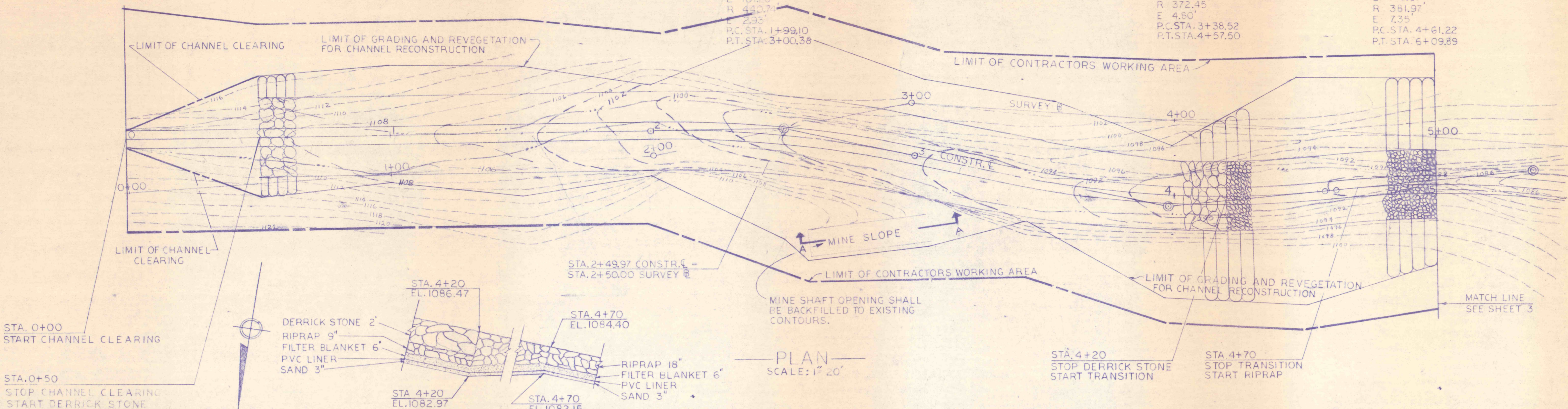

PLAN  
 SCALE: 1" = 20'

TRANSITION SECTION  
 SCALE: 1" = 4'

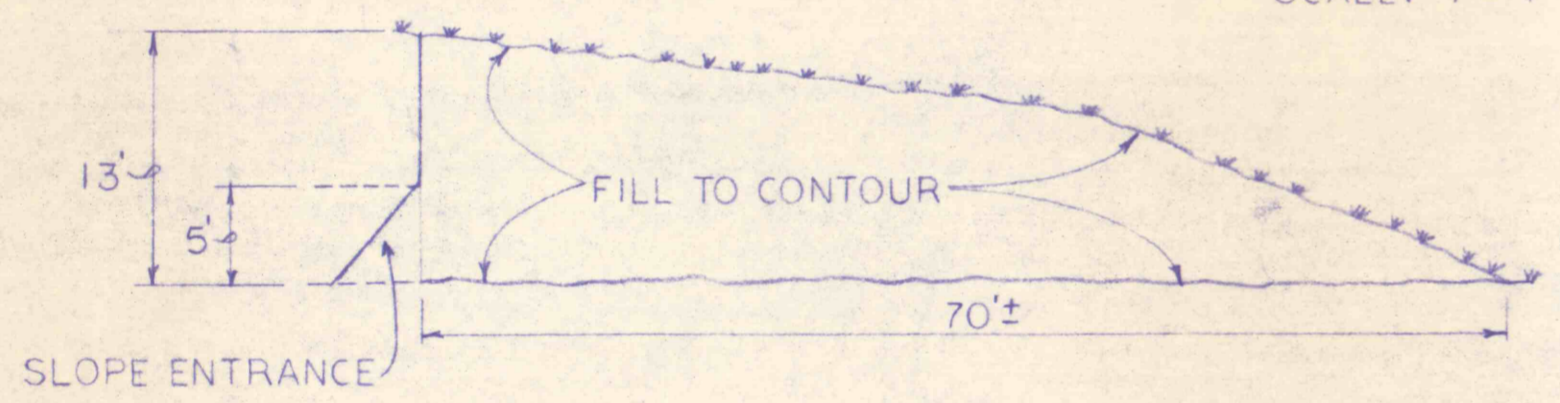

SECTION "A-A"  
 MINE SLOPE OPENING  
 NO SCALE

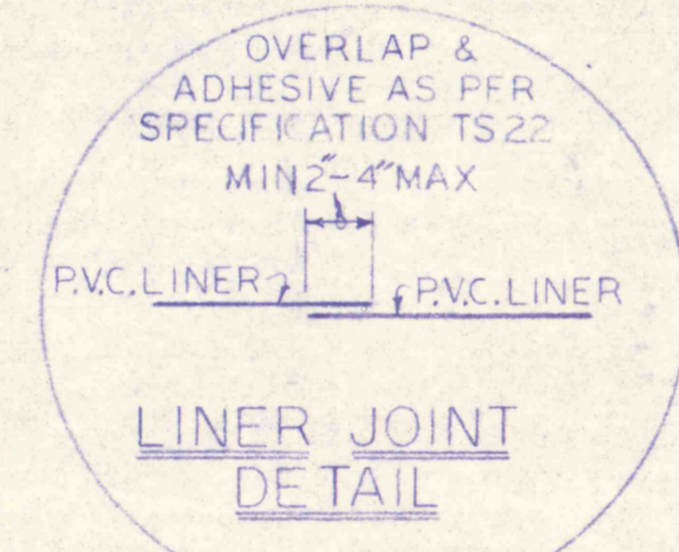

LINER JOINT  
 DETAIL

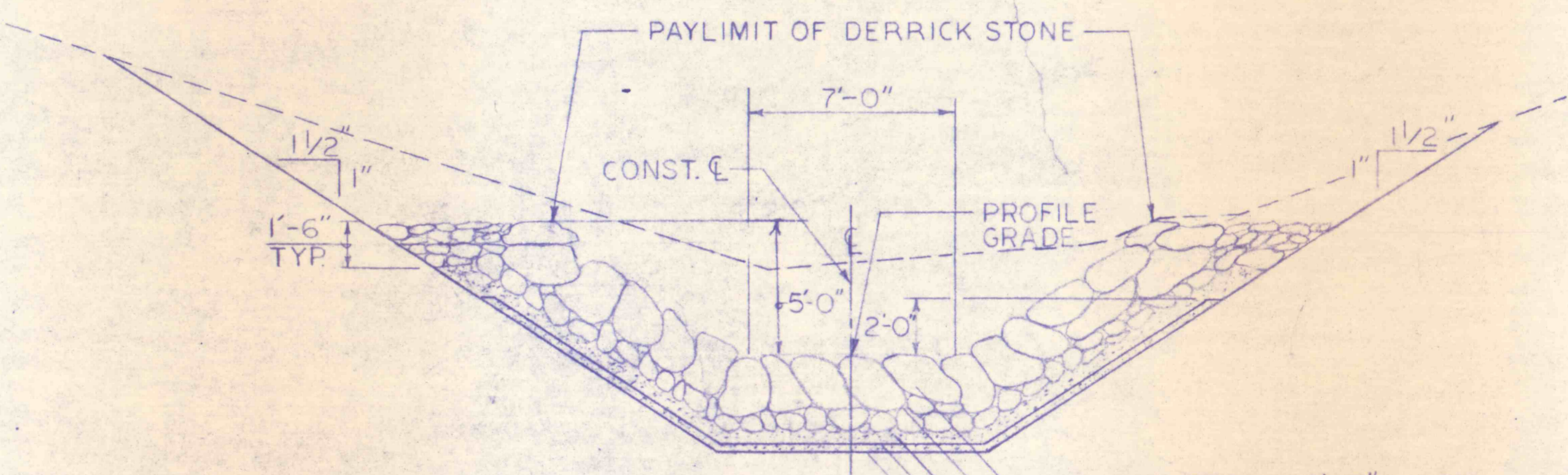

TYPICAL SECTION  
 STA. 0+50 TO STA. 4+20  
 SCALE: 1" = 5'

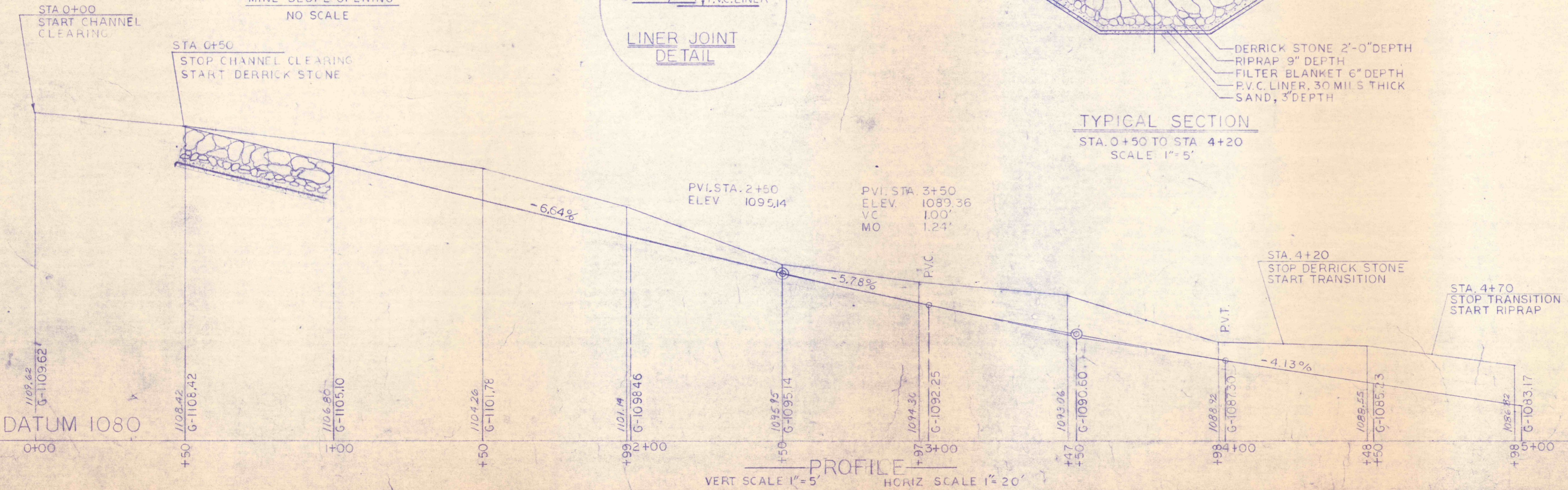

PROFILE  
 VERT SCALE 1" = 5'  
 HORIZ SCALE 1" = 20'

NO.	DATE	REVISION	APPR.
SUBMITTED			
 PROFESSIONAL			
APPROVED			
CHIEF - DIVISION OF MINE RECLAMATION			
APPROVED			
DIRECTOR - BUREAU OF DESIGN			
COMMONWEALTH OF PENNSYLVANIA DEPARTMENT OF ENVIRONMENTAL RESOURCES OFFICE OF RESOURCES MANAGEMENT			
<b>CONTRACT NO SL 139-1-1</b> <b>MINE DRAINAGE POLLUTION ABATEMENT</b> <b>LAUREL RUN</b> <b>LACKAWANNA RIVER WATERSHED</b> <b>LACKAWANNA COUNTY, PENNSYLVANIA</b>			
<b>ALBERT E. PETERS ASSOCIATES</b> Engineers-Designers-Consultants 301 North Main Avenue      Scranton, Penna. 18504			
<b>PLAN, PROFILE &amp; TYPICAL SECTIONS</b>			
DRAWN BY	DATE	DRAWING NO.	
R.E.N.		2 OF 6	
CHECKED BY	SCALE		
R.J.S.	AS NOTED		