

# SHEET NO. A-3

Projection Number: 8 REV. 1

Mining Period: 5-25-08 TO 11-25-08

Survey Date: 9-23-08

## Subsidence Map Legend

Gas Well		Six-Month Contemplated Mining	
Water Monitoring Point		Permit Boundary	
Background Water Point		Subsidence Boundary	
Drill Hole		Coal Contour	
Occupied Structure		100 Foot Cover Line	
Structure		Limit of Surface Activity Site	
Adverse Tract		Property Line	
1st Mining Only		Perennial Stream	
Hydrologic Barrier		Upper Freeport Cropline	
		Major Gas Line (1st Mining)	
		Affected Seal Area	

Notes:

Entry width will be 19 feet maximum except in belt where it will be 20 feet.

Surface and coal ownership are the same unless noted. The subsidence and permit boundary are common unless noted.

FINAL MAP  
10/02/08

**T.J.S. MINING, INC.**

**TJS NO. 5 MINE**

2340 SMITH ROAD, SHELOCTA, PA. 15774

CMAP No. 03031302

MSHA ID No. 36-09159

UPPER FREEPORT COAL SEAM

South Bend Twp., Armstrong Co.

Armstrong & Young Twps. Indiana Co.

Scale: 1" = 200'

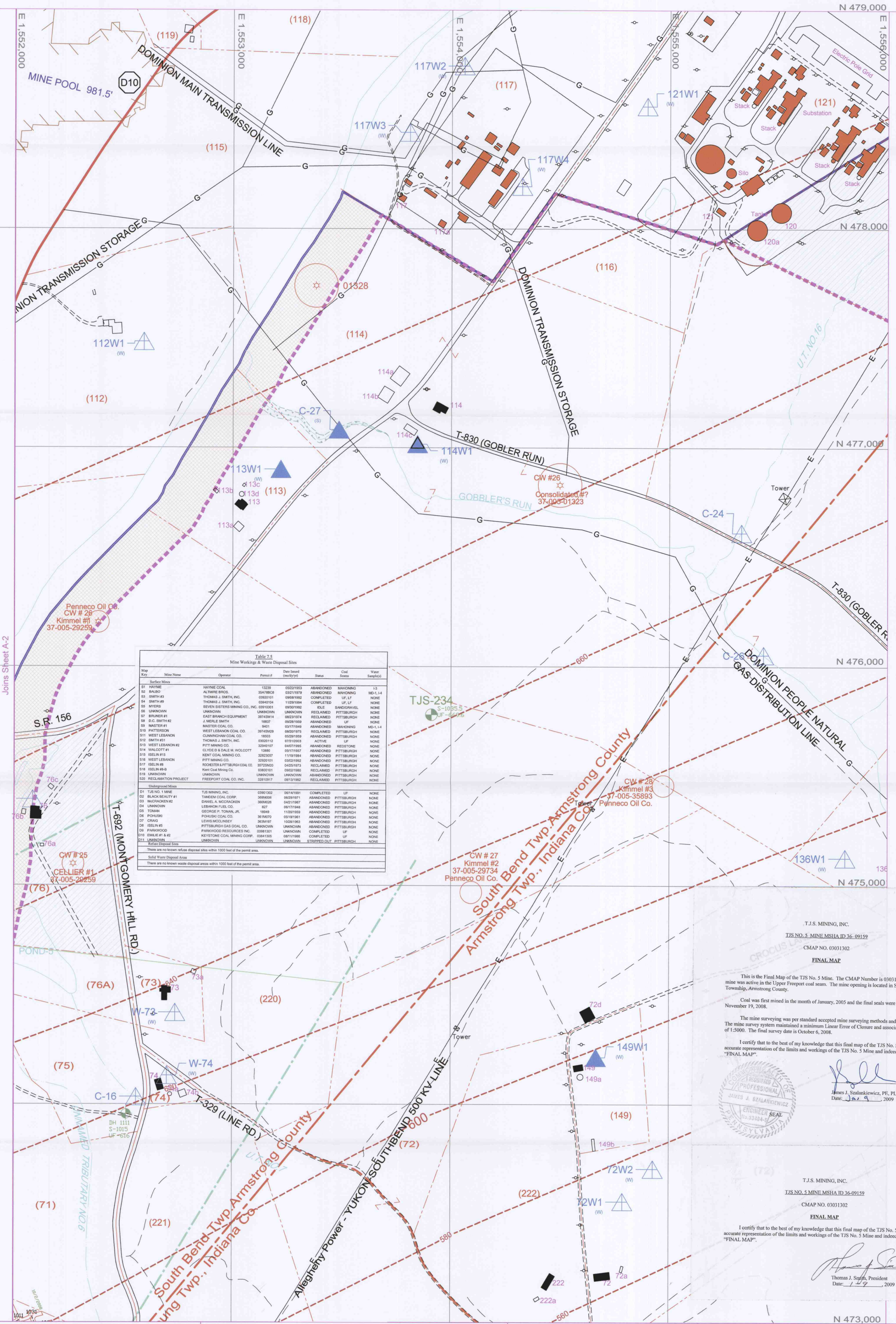

T.J.S. MINING, INC.  
TJS NO. 5 MINE MSHA ID 36-09159  
CMAP NO. 03031302  
FINAL MAP

This is the Final Map of the TJS No. 5 Mine. The CMAP Number is 03031302. The mine was active in the Upper Freeport coal seam. The mine opening is located in South Bend Township, Armstrong County.

Coal was first mined in the month of January, 2005 and the final seals were inspected on November 19, 2008.

The mine surveying was per standard accepted mine surveying methods and procedures. The mine survey system maintained a minimum Linear Error of Closure and associated precision of 1:5000. The final survey date is October 6, 2008.

I certify that to the best of my knowledge that this final map of the TJS No. 5 Mine is an accurate representation of the limits and workings of the TJS No. 5 Mine and indeed the true "FINAL MAP".

James J. Szalankiewicz, PE, PLS  
Date: 10/9/2009

T.J.S. MINING, INC.  
TJS NO. 5 MINE MSHA ID 36-09159  
CMAP NO. 03031302  
FINAL MAP

I certify that to the best of my knowledge that this final map of the TJS No. 5 Mine is an accurate representation of the limits and workings of the TJS No. 5 Mine and indeed the true "FINAL MAP".

Thomas J. Smith, President  
Date: 10/9/2009