

MESA  
RECEIVED  
JAN 14 1991

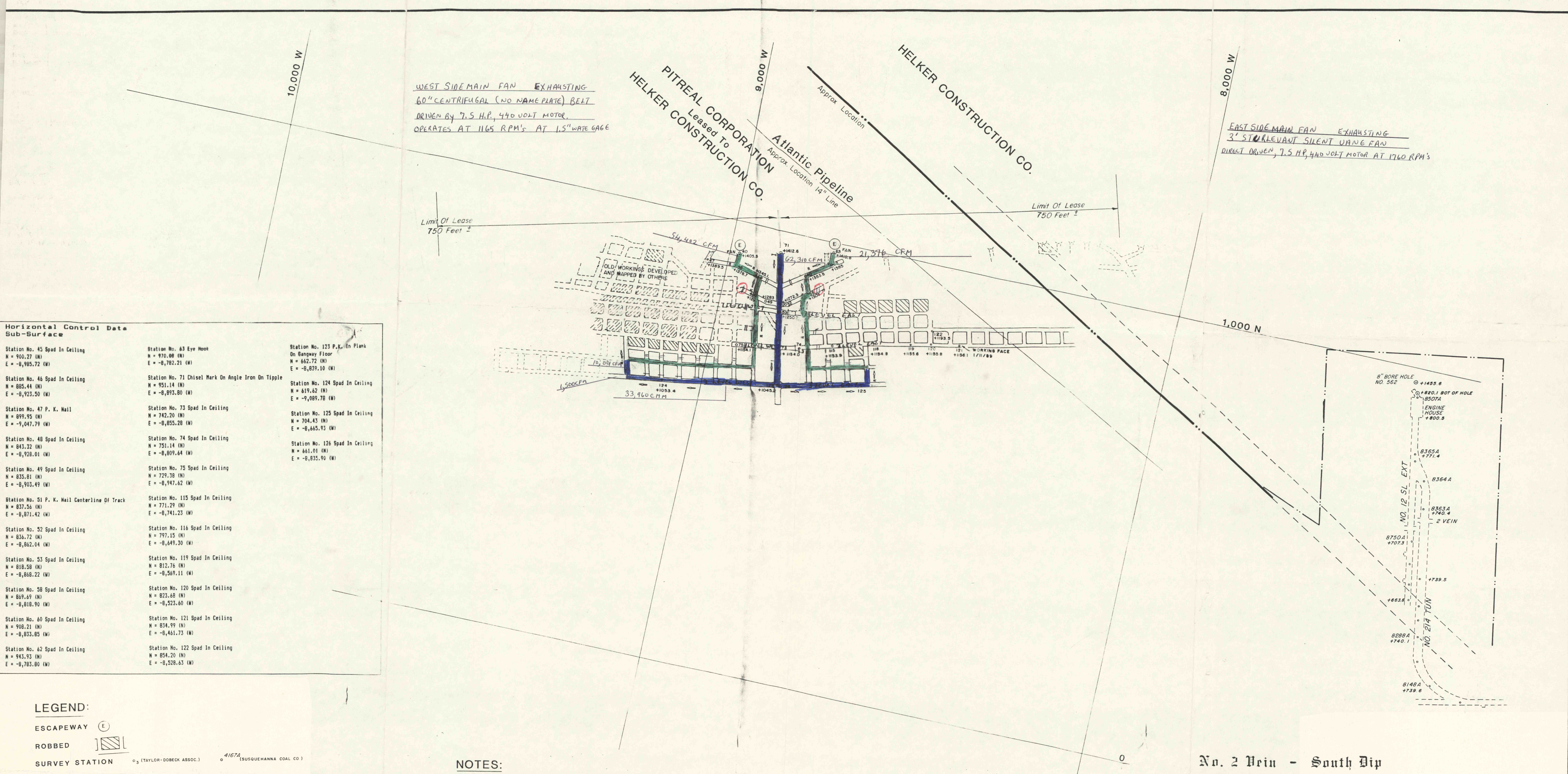

**Horizontal Control Data Sub-Surface**

Station No. 45 Spad In Ceiling N = 900.27 (N) E = -8,985.72 (W)	Station No. 43 Eye Hook N = 970.08 (N) E = -8,782.21 (W)	Station No. 123 P.K. In Plank On Gangway Floor N = 662.72 (N) E = -8,839.10 (W)
Station No. 46 Spad In Ceiling N = 865.44 (N) E = -8,923.50 (W)	Station No. 71 Chisel Mark On Angle Iron On Tipple N = 951.14 (N) E = -8,893.80 (W)	Station No. 124 Spad In Ceiling N = 619.62 (N) E = -9,089.78 (W)
Station No. 47 P. K. Nail N = 899.95 (N) E = -9,047.79 (W)	Station No. 73 Spad In Ceiling N = 742.20 (N) E = -8,855.28 (W)	Station No. 125 Spad In Ceiling N = 704.43 (N) E = -8,665.93 (W)
Station No. 48 Spad In Ceiling N = 843.32 (N) E = -8,928.01 (W)	Station No. 74 Spad In Ceiling N = 751.14 (N) E = -8,809.64 (W)	Station No. 126 Spad In Ceiling N = 661.01 (N) E = -8,835.90 (W)
Station No. 49 Spad In Ceiling N = 835.81 (N) E = -8,903.49 (W)	Station No. 75 Spad In Ceiling N = 729.38 (N) E = -8,947.62 (W)	
Station No. 51 P. K. Nail Centerline Of Track N = 837.56 (N) E = -8,871.42 (W)	Station No. 115 Spad In Ceiling N = 771.29 (N) E = -8,741.23 (W)	
Station No. 52 Spad In Ceiling N = 836.72 (N) E = -8,862.04 (W)	Station No. 116 Spad In Ceiling N = 797.15 (N) E = -8,649.30 (W)	
Station No. 53 Spad In Ceiling N = 818.58 (N) E = -8,868.22 (W)	Station No. 119 Spad In Ceiling N = 812.76 (N) E = -8,569.11 (W)	
Station No. 58 Spad In Ceiling N = 869.69 (N) E = -8,818.90 (W)	Station No. 120 Spad In Ceiling N = 823.68 (N) E = -8,523.60 (W)	
Station No. 60 Spad In Ceiling N = 908.21 (N) E = -8,833.85 (W)	Station No. 121 Spad In Ceiling N = 834.99 (N) E = -8,461.73 (W)	
Station No. 62 Spad In Ceiling N = 943.93 (N) E = -8,783.80 (W)	Station No. 122 Spad In Ceiling N = 854.20 (N) E = -8,528.63 (W)	

- LEGEND:**
- ESCAPEWAY (E)
  - ROBBED (hatched box)
  - SURVEY STATION (circle with cross)
  - ELEVATION (+1382 (SUSQUEHANNA COAL CO. DATUM))
  - STOPPING (T-bar symbol)
  - INTAKE AIR (I)
  - RETURN AIR (R)
  - OLD ABANDONED WORKINGS (dashed line)
  - NEW WORKINGS OF NORTH MOUNTAIN COAL CO. (solid line)
  - PROPERTY LINE (thick solid line)
  - OUTCROP LINE (dashed line)
  - PITCH OF VEIN (DEGREES) 50°
  - (M) BLEEDER EVALUATION POINT

**NOTES:**

1. LOCATIONS AND EXTENT OF OLD ABANDONED WORKINGS UNKNOWN

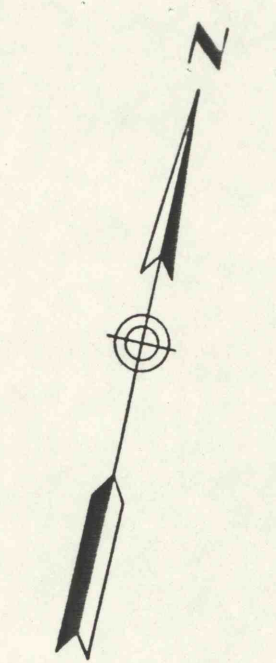

**No. 2 Vein - South Dip**

MINE SURVEY FOR  
**NORTH MOUNTAIN COAL CO.**  
COAL TOWNSHIP, NORTHUMBERLAND COUNTY  
PENNSYLVANIA

SCALE: 1 INCH = 100 FEET, OCTOBER 16, 1985  
REVISED: NOV. 6, 1987

M.S.H.A. I.D.# 36-05873  
36-07681  
West side South Dip

**Taylor-Doberck Associates**  
PROFESSIONAL LAND SURVEYORS  
RD#1 BOX 659  
SHAMOKIN, PA. 17872

NOV. 14, 1988  
JAN. 20, 1989  
MAY 23, 1989  
MAY 15, 1990

