

mine map requirements Section. 75.1200

The Map shall be accurate and up-to-date and shall show:

1. Mine Name and Location, and I.D. No.
2. Scale, Orientation and Legend.
3. Property or boundary lines. Distances North, East, South and West. from the mine opening will be acceptable.
4. All openings in the vein being mined.
5. Outline of active workings.
6. All Stripped areas in the vein being mined.
7. Pillard, worked out and abandoned areas.
8. Location of Surface Fan.
9. Pitch of vein(s).
10. Escapeways - designate as (E).
11. All available information on mines above and below.
12. All available information on water pools above and below.
13. Intake and return airways with the direction of air flow.
14. All drill holes that penetrate the vein being mined.
15. All known adjacent mine workings within 1000 feet.
16. Active or inactive oil or gas wells within 500 feet of the mine.
17. Surface features such as railroads and other roads leading to the mine and permanent mine buildings. Identify same.
18. Areas which have been pillard, worked out or abandoned, which are inaccessible or cannot be entered safely and on which information is not available.
19. Gangway identification, i. e., the name of the vein and level being mined.
20. Survey tie-in with the surface and underground, showing the location and description of Two permanent base line points establishing horizontal control and two permanent bench marks establishing vertical control.
21. Elevations of tops and bottoms of shafts and slopes and the floor at the entrance to drift and tunnel openings.
22. Elevations in the gangways at the end of a gangway before it is abandoned.
23. Ventilation controls constructed or removed, such as seals, overcasts, undercasts, regulators and permanent and temporary stoppings.
24. Elevations in rooms, chambers, or breasts advancing toward or adjacent to property or boundary lines of adjacent mines.
25. The location and elevation of any water dammed in the mines.
26. Cross Section through the vein at approximately 1,000 foot intervals in the gangways and or at the end of a gangway if it is less than 1,000 feet (in lieu of contour lines).
27. Seal and signature of the registered engineer or registered surveyor preparing the map.

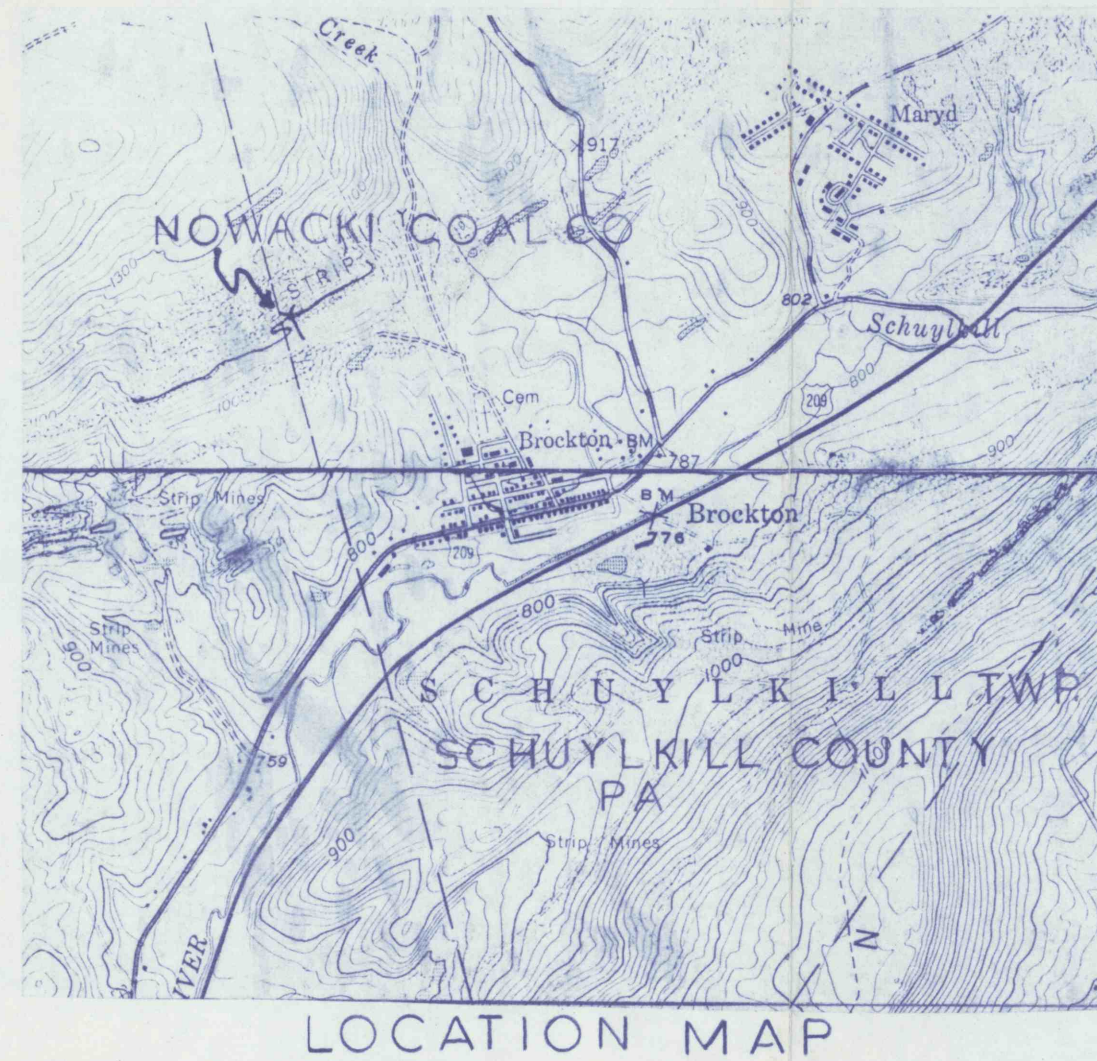

LOCATION MAP

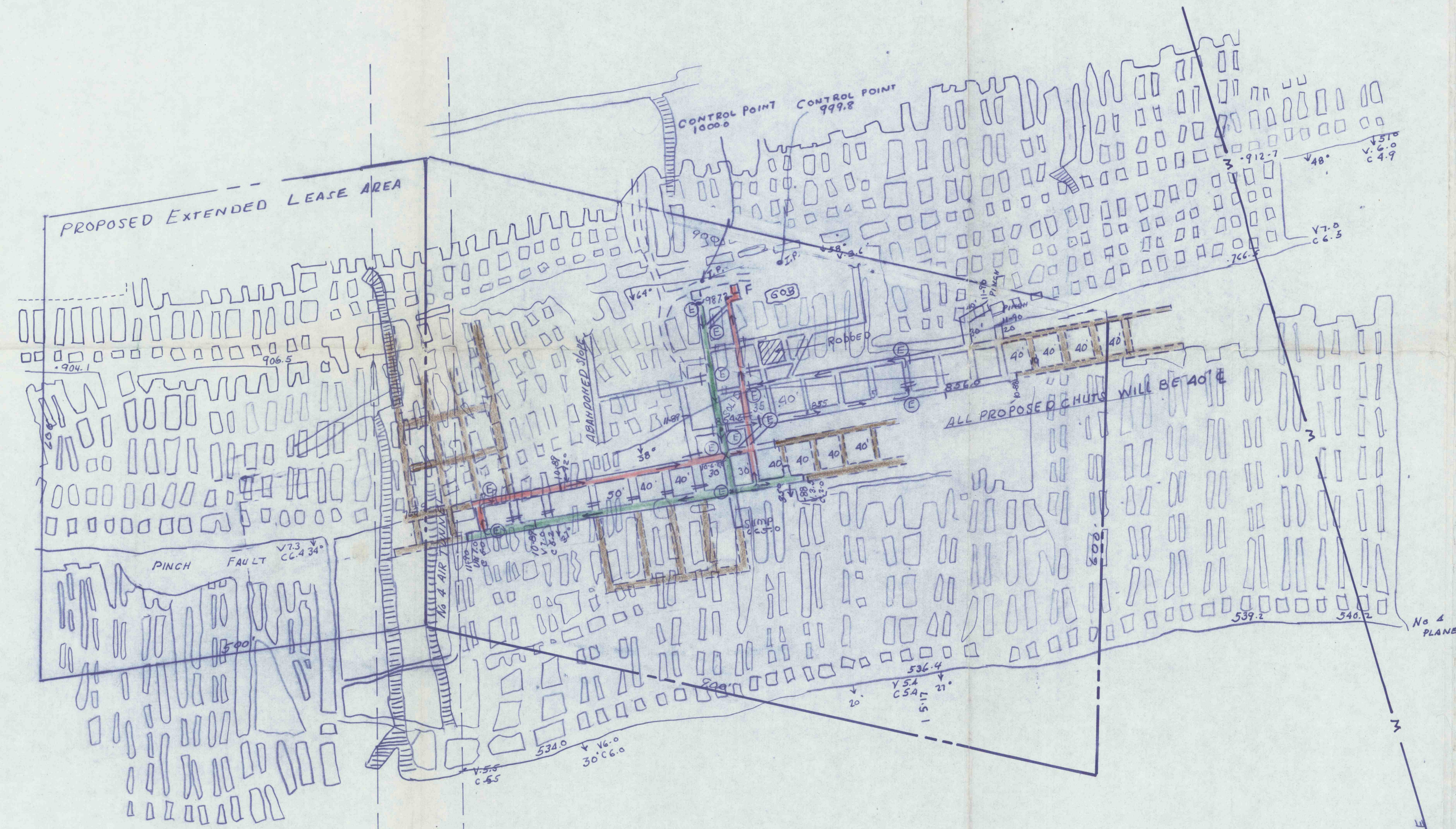

LEGEND	
DOOR	-----D
STOPPING	=====
OVERCAST	-----X
BATTICE	-----
DIRECTION OF AIR	INTAKE -----> EXHAUST -----<
REGULATOR	-----R
CURTAIN OR CHECK	-----C
FAN	27" Centrifugal P-22,000 CUE SINOCO FAN
ESCAPE	-----E
WORKED SURFACE AREA	-----
PROPOSED	-----

NOWACKI COAL COMPANY ID #36-07592
SCHUYLKILL, TWP. SCHUYLKILL COUNTY, PA.

NOTE: THERE IS NO POOLED WATER ON THE SURFACE WITHIN THE MAPPED AREA. THE SUBSURFACE WATER LEVELS ARE AT LOCATIONS AND ELEVATIONS SHOWN ON MAP.
THERE ARE NO R. R. OR PAVED ROADS LEADING TO THE MINE. ACCESS IS FROM THE DIRT ROAD OUTLINED ON THE MAP.
PERMANENT BUILDINGS ON THE SITE CONSIST OF THE HOIST HOUSE AND SURFACE FAN, AS SHOWN ON THE MAP.
SURFACE SURVEY TIE IN POINTS ARE PINNED MARKERS AT LOCATIONS SHOWN ON THE MAP.

PRESENT VEIN BEING MINED IS THE MIDDLE SPLIT SOUTH DIP VEIN

NOTE: WORKINGS FROM OTHER VEINS COPIED FROM MINE MAPS.
SURVEY LIMITED TO LEASE AREA AND VEIN OF PRESENT WORKINGS
BUCK VEIN #1 EAST GUY.

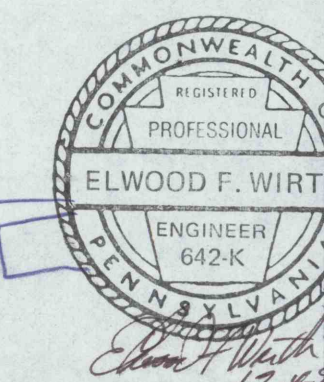
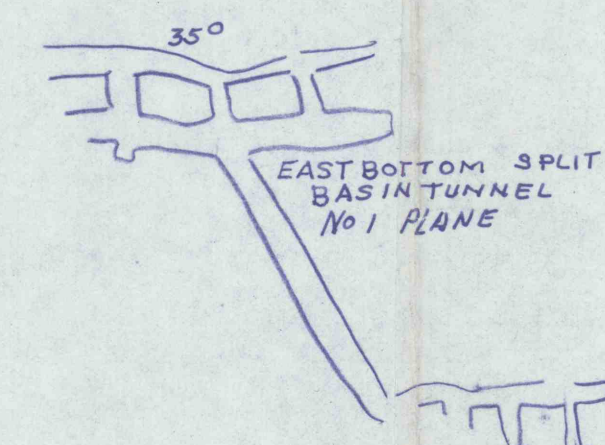
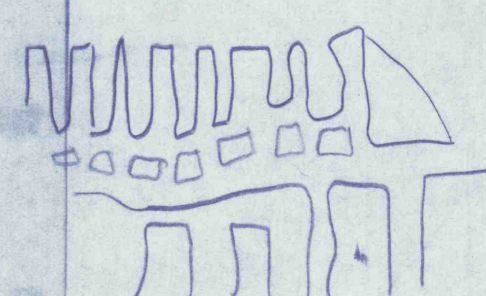

12-4-90
REVISIONS 11-24-86 11-24-87 11-8-88 11-27-89
NOWACKI COAL COMPANY
Lease No. 7A
PERMIT No. 36-07592
SCHUYLKILL TWP.
JOB NO. 11-8-88
DATE: 11-8-88
SCALE: 1" = 100'
DRAWN: [Signature]
APPROVED: [Signature]

