

STA.	NORTHING	EASTING	ELEVATION	DESCRIPTION
67	-2012.500	-52788.470	1176.80	TACK IN HUB
68	-2025.700	-52866.130	1177.70	DH IN ROCK
71	-1994.260	-52527.300	1176.10	RR SPK
72	-1989.270	-52492.930	1175.60	3/4" IR @ INT.
74	-1797.600	-52580.000	1160.30	5/8" IR 2ND OPEN
83	-1783.890	-52711.620	1159.40	PK NL IN TIPPLE
86	-1799.780	-52610.960	1126.40	SPK AT LADDER
87	-1800.360	-52658.180	1112.80	SPAD IN CEILING
88	-1790.650	-52709.600	1081.70	SPAD IN CEILING
90	-1798.110	-52762.930	1081.00	SPAD IN CEILING
91	-1779.740	-52784.530	1071.00	SPAD IN CEILING
95	-1804.780	-52806.660	1072.80	SPAD IN CEILING
97	-1761.590	-52833.630	1052.50	SPAD IN CEILING
98	-1707.080	-52856.030	1032.40	SPK IN FLOOR
99	-1783.820	-52973.970	1038.50	SPK IN CEILING
101	-1657.410	-52749.790	1034.70	SPAD IN CEILING
104	-1852.140	-53061.780	1039.90	SPAD IN CEILING
106	-1947.420	-53146.810	1041.80	SPAD IN CEILING
110	-1969.780	-53121.190	1046.00	SPAD IN CEILING
111	-1969.330	-53092.120	1042.70	SPAD IN CEILING
113	-1618.763	-52750.099	1015.19	SPK ON FLOOR
114	-1585.524	-52772.279	1011.48	SPAD
115	-1610.899	-52870.680	1008.54	SPAD IN TRACK
116	-1607.704	-52855.300	1012.09	SPAD
117	-1613.150	-52922.936	1008.57	SPK IN TIE
118	-1584.087	-52981.108	1010.60	SPK IN FLOOR
119	-1586.163	-53026.144	1019.78	CHUTE #3
120	-1593.061	-53108.322	1012.26	CHUTE #4
121	-1597.932	-53163.919	1012.06	SPAD

CROSS-SECTION THRU SLOPE
Looking West
1" = 40'

NOTE: GANGWAY ELEVATIONS OF NO. 11 VEIN - 700'
MINE POOL ELEVATION - 770'
SEE SHEET NO. 3

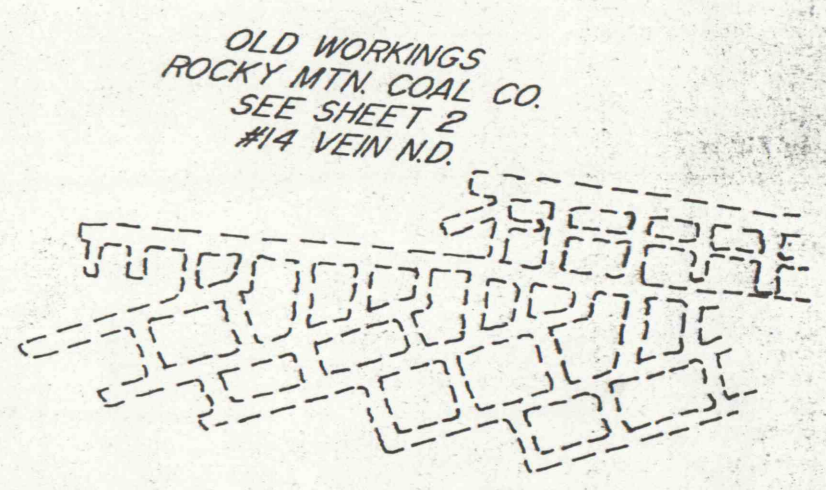
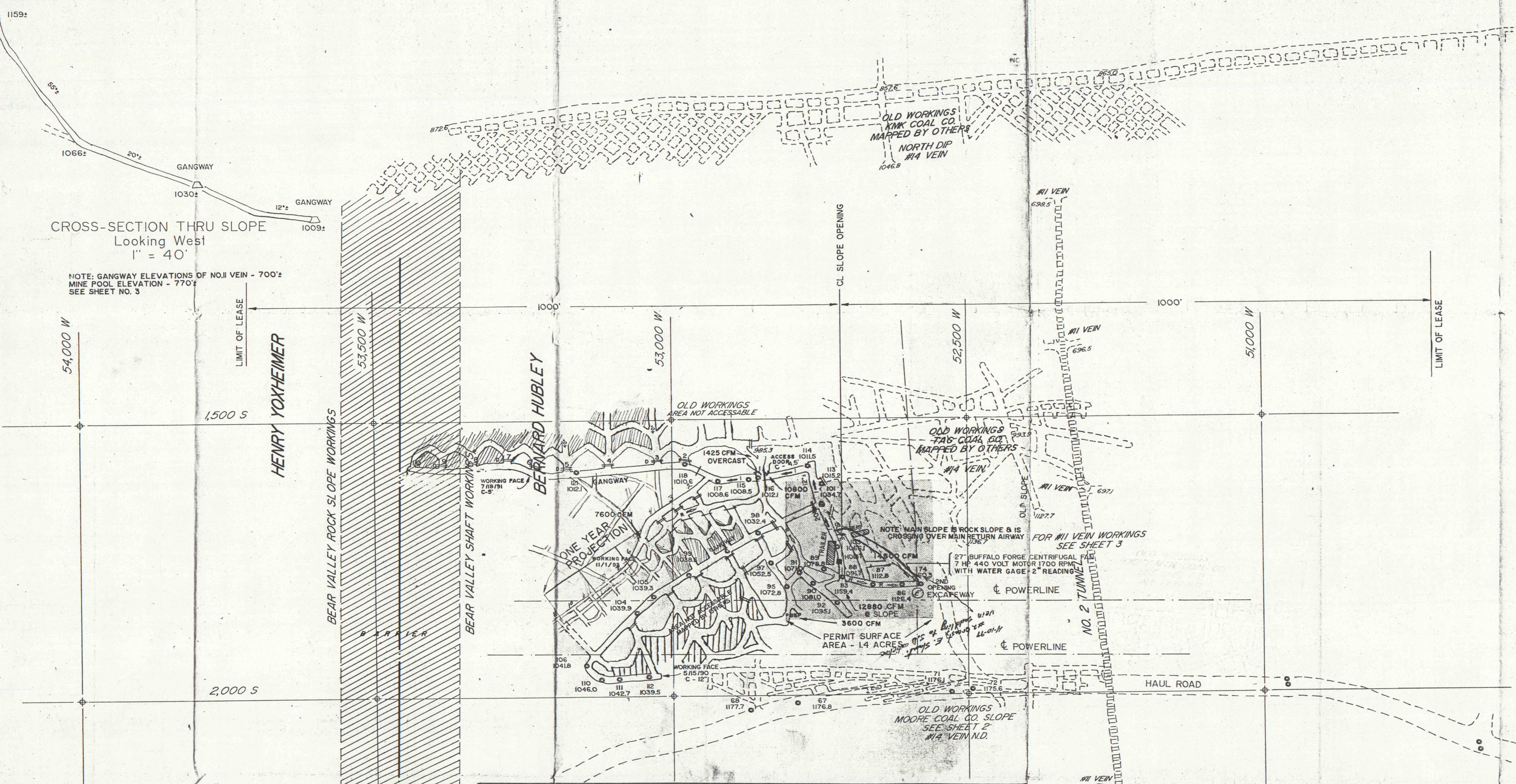

LEGEND

- ESCAPEWAY
- INTAKE AIR
- RETURN AIR
- SURVEY STATION (STA. NO. & ELEVATION)
- TEMPORARY STOPPING
- PERMANENT STOPPING
- PERMANENT STOPPING WITH DOOR
- OLD WORKINGS MAPPED BY OTHERS AND/OR INACCESSIBLE
- (BEP) BLEEDER EVALUATION POINT
- ROBBED

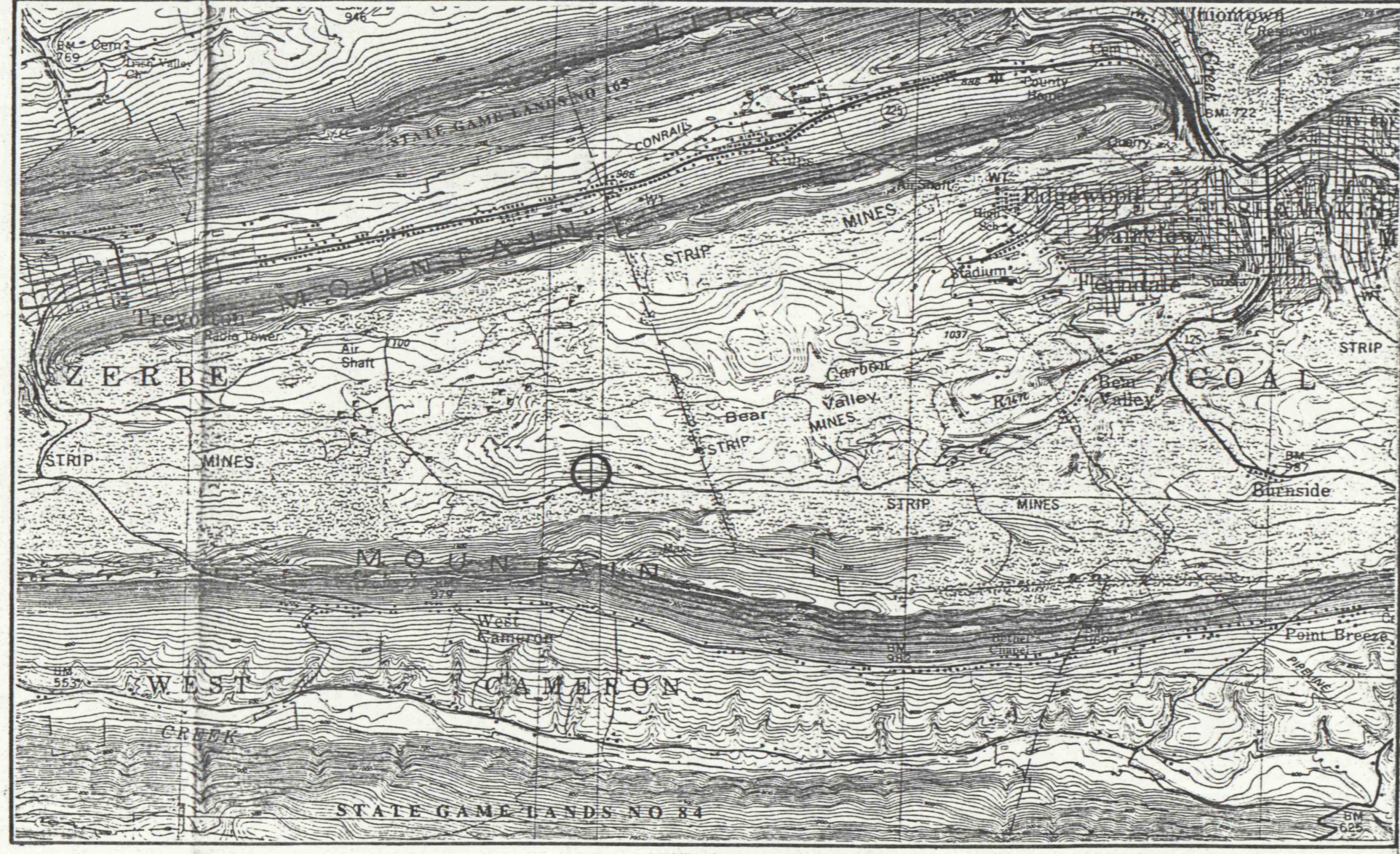

Location Map

MINE MAP &
VENTILATION MAP
**SHELDON DERCK
NO. 1 SLOPE**

NO. 14 VEIN - NORTH DIP

LOCATED IN
ZERBE TOWNSHIP
NORTHUMBERLAND COUNTY
PENNSYLVANIA

SCALE: 1 INCH = 100 FEET



MAY 15, 1990

REVISED: JULY 18, 1991

MARCH 30, 1992

AUGUST 20, 1992

NOVEMBER 1, 1992

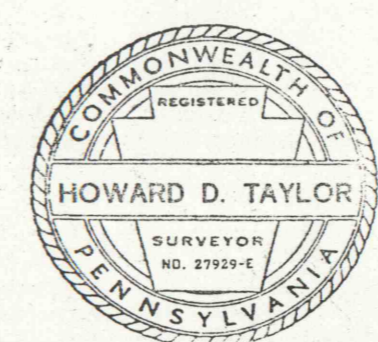

Taylor-Doback Associates
PROFESSIONAL LAND SURVEYORS
RD #1, BOX 659
SHAMOKIN, PA 17872

Howard D. Taylor

ADDRESS

SHELDON DERCK NO. 1 SLOPE
C/O SHELDON DERCK
133 EAST ACADEMY ST.
SHAMOKIN, PA. 17872
(717) 648-9083

MINE MAP &
VENTILATION MAP
SHELDON DERCK
NO. 1 SLOPE - NO. 14 VEIN
MSHA I.D. # 36-07018