

#820
1-12-8000
cc

SHEET ONE
DOVERSPIKE BROS. COAL CO.
DORA No. 5 MINE
PORTER & PERRY TOWNSHIPS
JEFFERSON COUNTY, PENNA.

LEGEND
CONTEMPLATED MINING
COMPLETED MINING

MINING COMPLETED AS SHOWN 12/1/76



WILLIAM N. GREEN *W. N. Green*

MERLE COLEMAN

GEORGE DANKO

PAUL STAHLMAN

DANIEL MOSER

J. ADAMS, EST.

J. C. ENTERPRISES

ROBERT STEIMER

MATCH LINE SHEET 184

PORTER TOWNSHIP
PERRY TOWNSHIP

MATCH LINE SHEET 182

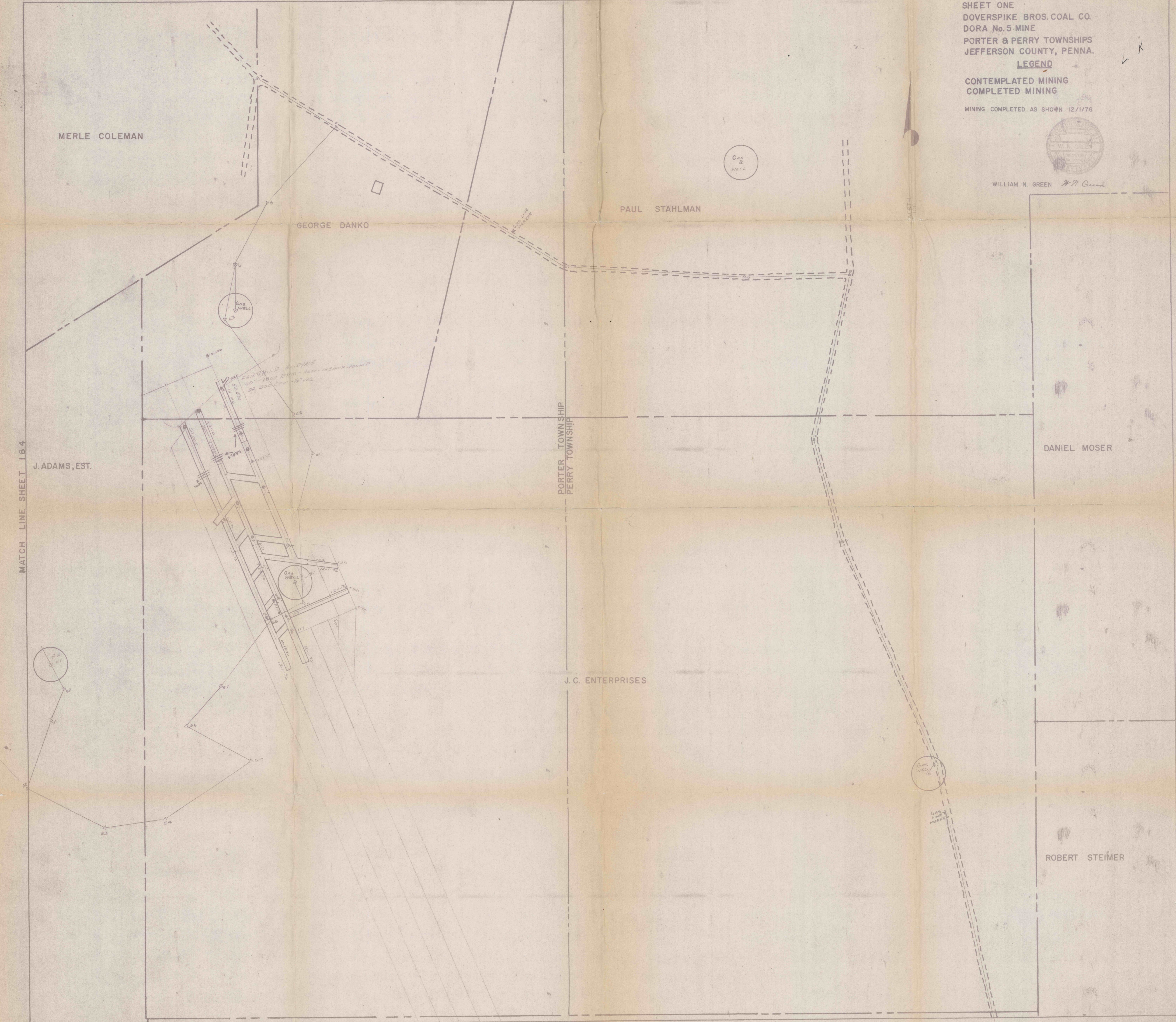

*FAVORABLE FINDING
50' - 1000' STRIKE - 450' - 100' JOINT
50' 300' STRIKE - 100'*