

#1179
7-27-99
C.C.

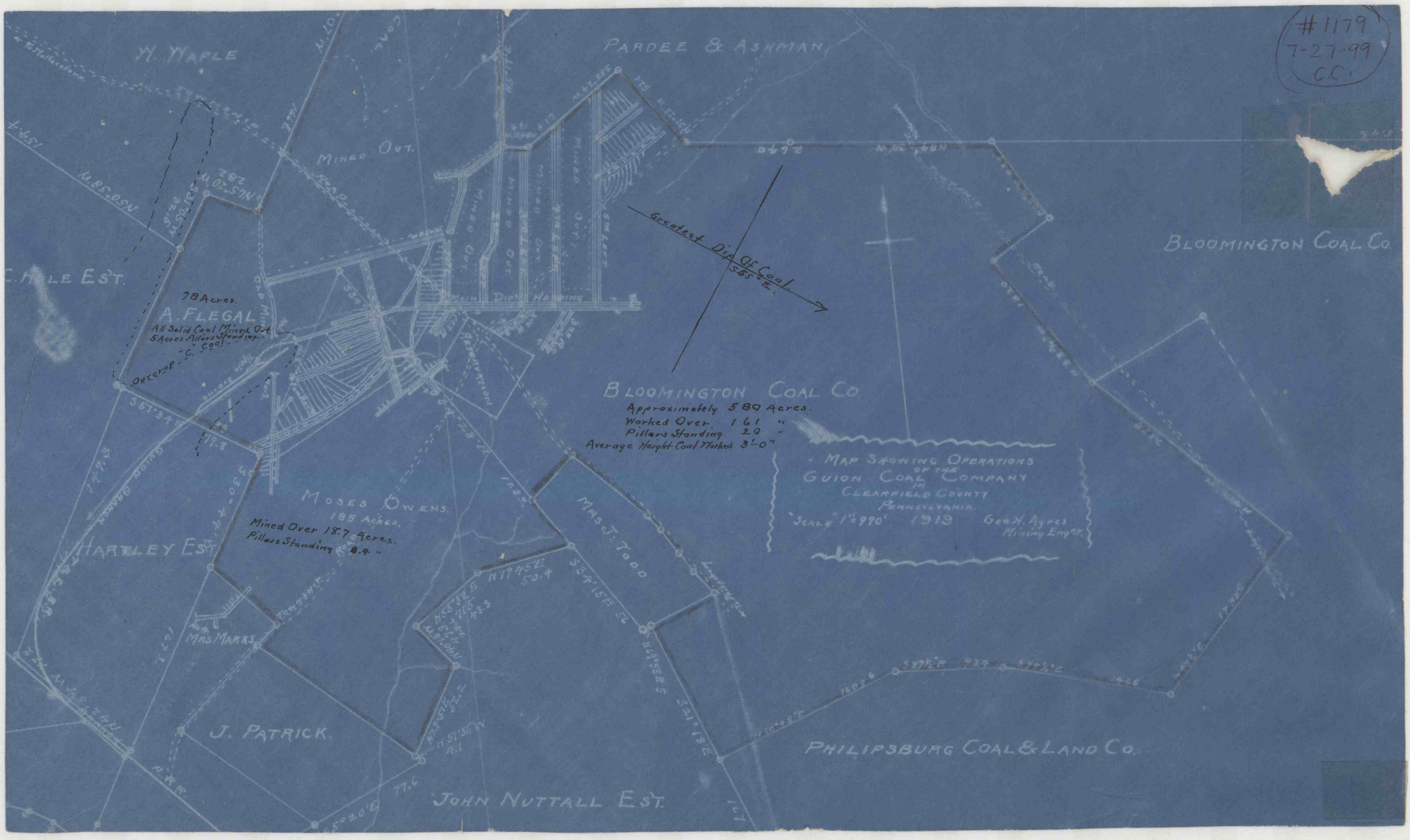

BLOOMINGTON COAL CO

BLOOMINGTON COAL CO
Approximately 580 Acres.
Worked Over 161 "
Pillars Standing 20 "
Average Height Coal Worked 3'-0"

MAP SHOWING OPERATIONS
OF THE
GUION COAL COMPANY
IN
CLEARFIELD COUNTY
PENNSYLVANIA.
SCALE 1"=990' 1913 Geo. H. Ayres
Mining Eng'g.

W. MAPLE

PARDEE & ASHMAN

78 Acres.
A. FLEGAL

All Solid Coal Mined Out.
5 Acres Pillars Standing in
"C" Coal.

MOSES OWENS.
185 Acres.

Mined Over 18.7 Acres.
Pillars Standing 8.9 "

HARTLEY EST.

J. PATRICK.

JOHN NUTTALL EST.

PHILIPSBURG COAL & LAND CO.

Greatest Dip of Coal
56° E.