

GOB

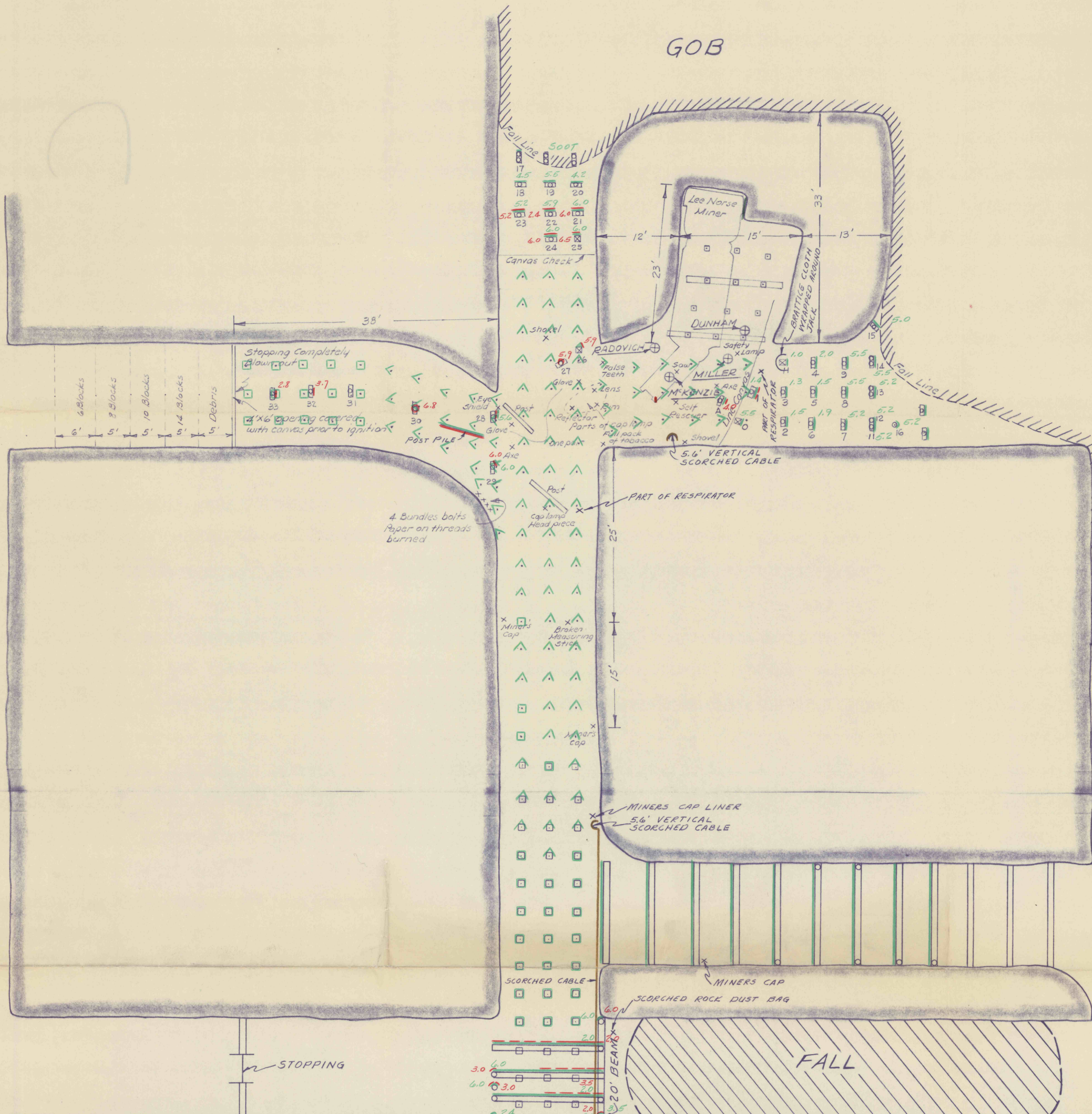

GOB

LEGEND

- POST
- ROOF BOLT
- 20 TON YIELDING JACK
- CAP PIECE
- 14' PLANK

NOTE-ENTRIES BOLTED ON 4' CENTERS

— SOOT
— COKE

ROBENA NO. 2 MINE
LONG SHAFT
1 MAIN - 12 FLAT RT - 9 PANEL
SCALE 1" = 8' OCT. 2, 1962