

DRILL HOLES (B.C. - BOTTOM OF COAL)			
No.	SURFACE ELEVATION	KITTANNING COAL ELEVATION	KITTANNING COAL THICKNESS
1	1075.01		
2 & 2A	837.09		
3	1191.49		
4	1213.64	1061	3' 2 1/2"
5	1237.73		
6 - K.F.B. 295	1213.87	727.46	
DOME No. 1			
DOME No. 2			
12			
25	1406.09	B.C. - 988.67	

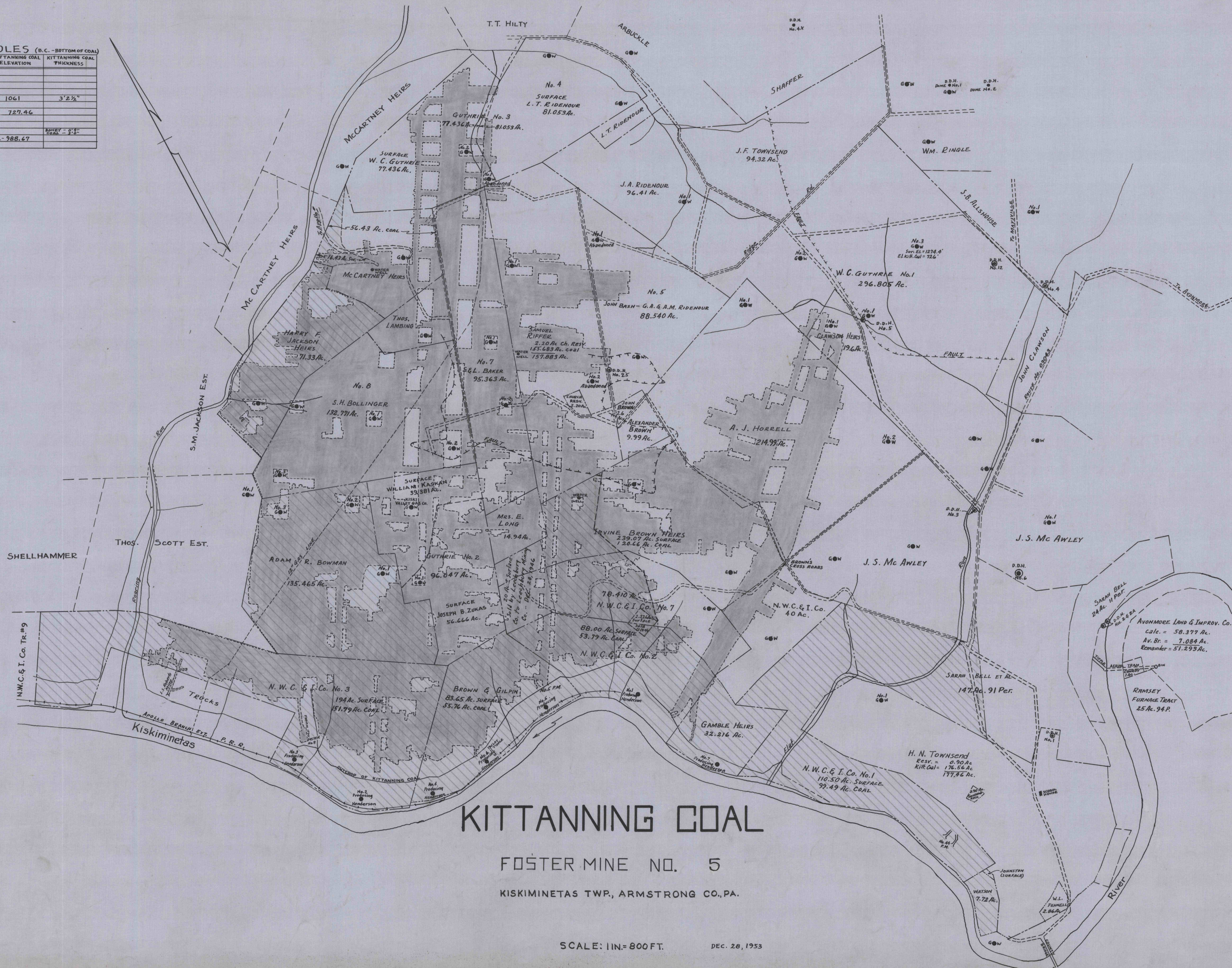

SCALE: 1 IN. = 800 FT.

DEC. 28, 1933