

Location	Geological Section
On Line H going South Station 7+00.	Top Covering 31'
	Bronze Slate 36 Ft 6 inches
On Line H going south Sta. 39+50 thence east 100 feet	Dark slate 4-6 LUSHI VEIN 30' coal
	Conglomerate 70 Feet
	Light colored sandy slate 2-4'
	Black Slate 4-6'
	White Fire Clay 3-6'
	Black Slate 1-2'
	Light blue Slate 13' 8"
	Black Slate 7-8'
	BLOSS VEIN 5 1/2' coal
	Pine Clay 3-0'
On Line H going south Sta. 39+50 thence west 100'	Light colored Slate 13 feet
	Lower Conglomerate

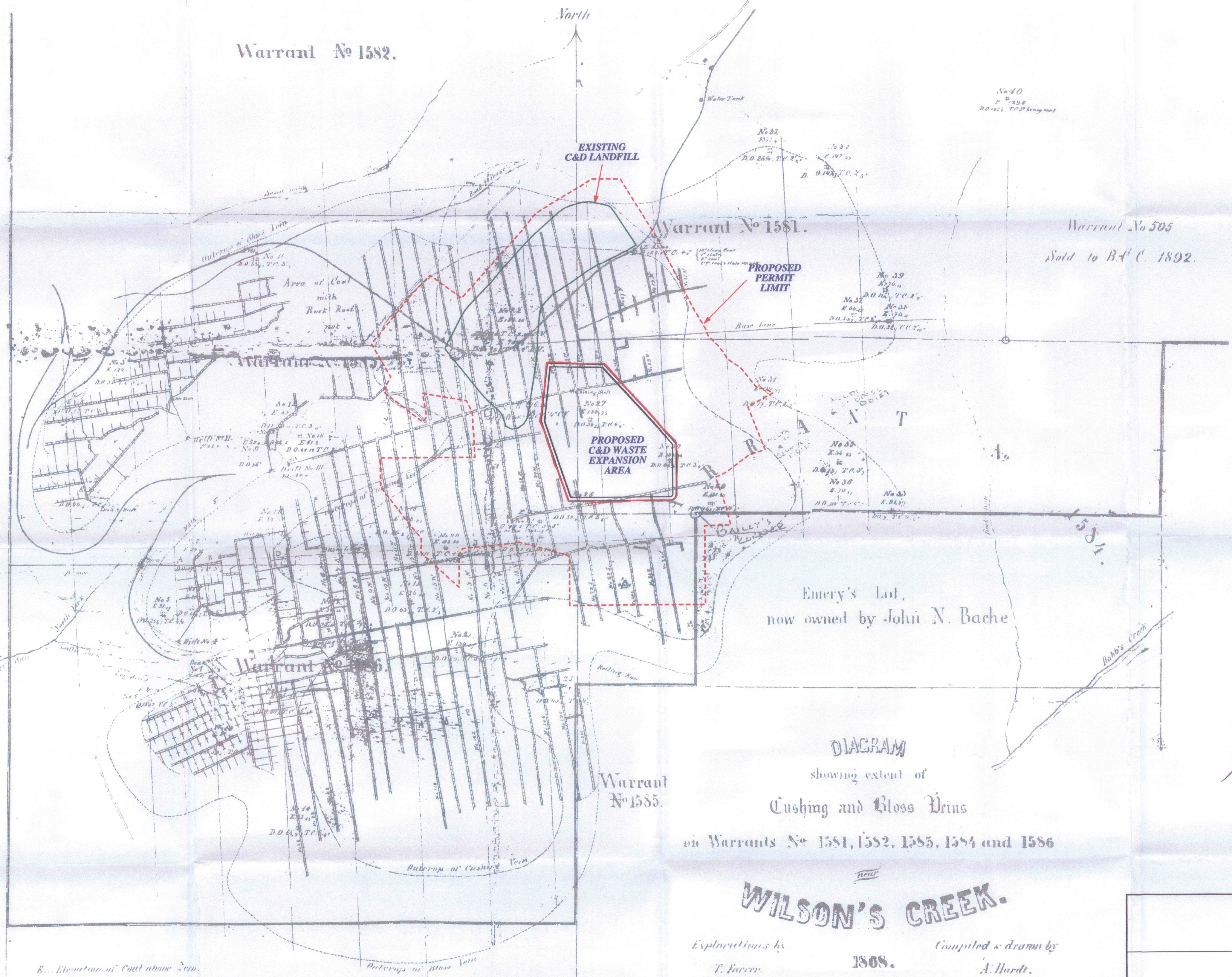
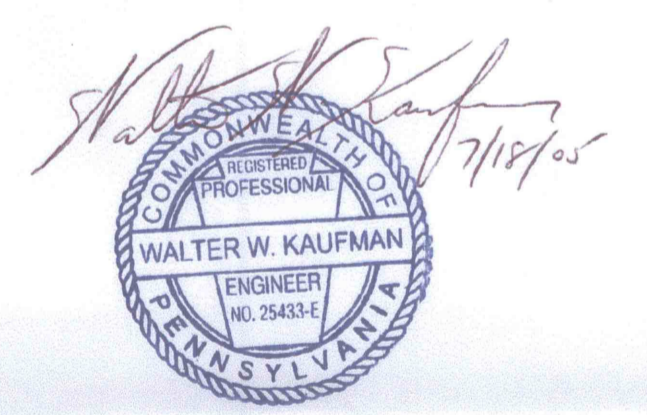

DIAGRAM showing extent of Cushing and Bloss Veins on Warrants No 1581, 1582, 1585, 1584 and 1586

**WILSON'S CREEK.**

Explorations by T. Farver 1868. Compiled & drawn by A. Hurd.

Scale 500 feet to the inch.



Phoenix Resources, Inc.  
C&D Landfill Expansion  
Duncan Twp., Tioga County

**Exhibit 11-A**  
**Antrim Underground Mine Map**

Scale: 1" = 800'-0"      Date: July 18, 2005

**KAUFMAN ENGINEERING Inc.**  
1444 East Lackawanna Ave.  
Olyphant, PA 18447  
(570)307-1267