

REPUBLIC CONNELLSVILLE COKE CO. COAL

REPUBLIC CONNELLSVILLE COKE CO.

STRUTHERS MINE STRUTHERS COAL & COKE CO.

SITUATE IN
REDSTONE AND MENALLEN TOWNSHIPS
FAYETTE COUNTY, PA.

SCALE - 1 IN. = 50 FT. SEPTEMBER 4, 1912
FAYETTE ENGINEERING CO.
ORDINATOWN, PA.

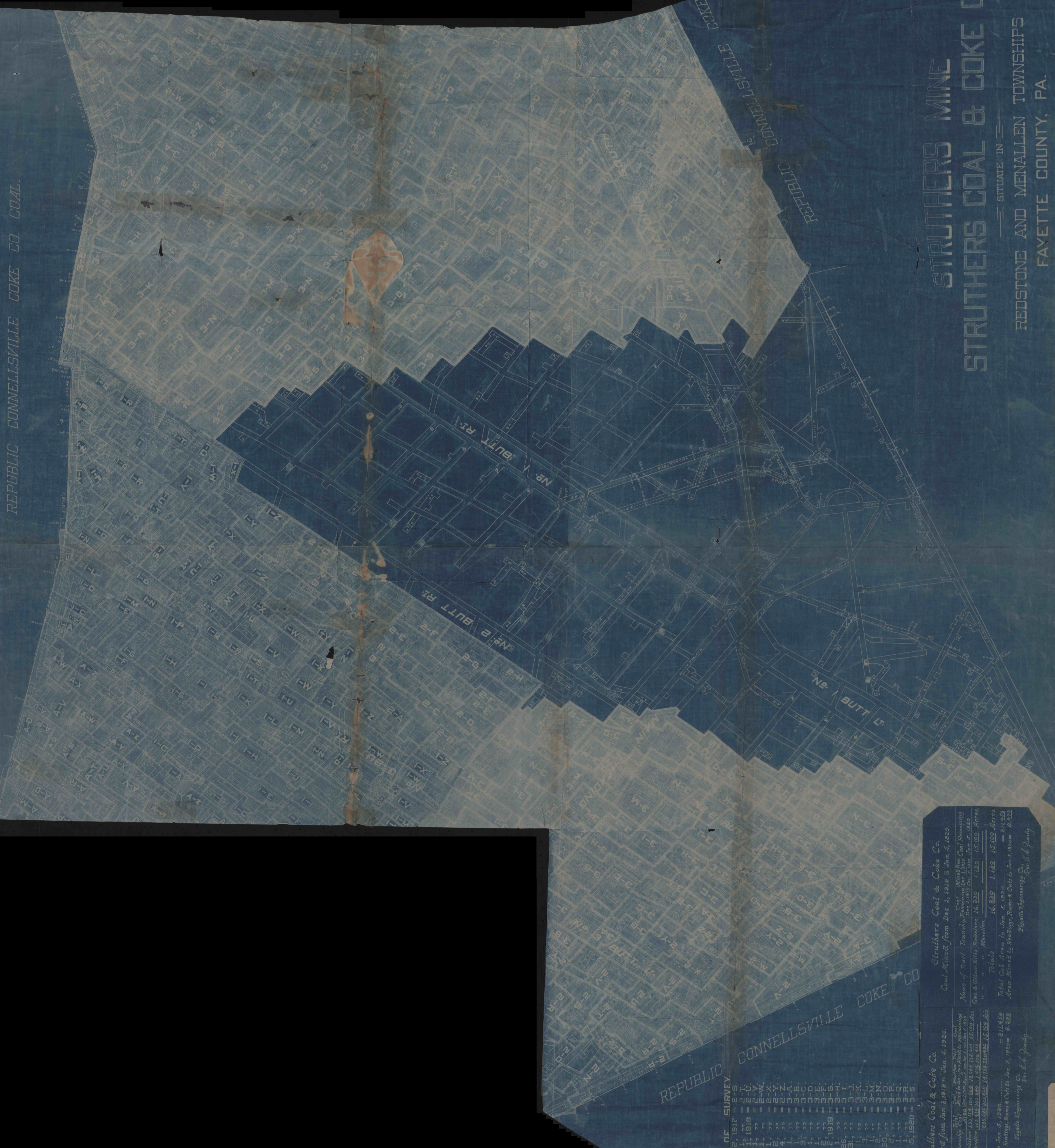

DATE	OF SURVEY
NOV. 21, 1917	2-T
DEC. 1, 1918	2-U
JAN. 1, 1918	2-V
FEB. 1, 1918	2-W
MAR. 1, 1918	2-X
APR. 1, 1918	2-Y
MAY 1, 1918	2-Z
JUNE 1, 1918	3-A
JULY 1, 1918	3-B
AUG. 1, 1918	3-C
SEPT. 1, 1918	3-D
OCT. 1, 1918	3-E
NOV. 1, 1918	3-F
DEC. 1, 1918	3-G
JAN. 1, 1919	3-H
FEB. 1, 1919	3-I
MAR. 1, 1919	3-J
APR. 1, 1919	3-K
MAY 1, 1919	3-L
JUNE 1, 1919	3-M
JULY 1, 1919	3-N
AUG. 1, 1919	3-O
SEPT. 1, 1919	3-P
OCT. 1, 1919	3-Q
NOV. 1, 1919	3-R
DEC. 1, 1919	3-S

Struthers Coal & Coke Co.
 Coal Mined from Jan. 2, 1919 to Jan. 5, 1920.

Name of Tract	Township	Coal	Coal Remaining
Geo. & Susan Mills	Redstone	16,230	1,130
" " "	Menallen	16,230	1,130
Totals		32,460	2,260

Total Coal Area to Jan. 5, 1920 = 211,438
 Area Mined by Headings, Rooms & Cuts to Jan. 5, 1920 = 9,228

Fayette Engineering Co. Per: E. C. Dancy

Struthers Coal & Coke Co.
 Coal Mined from Dec. 4, 1919 to Jan. 5, 1920.

Name of Tract	Township	Coal	Coal Remaining
Geo. & Susan Mills	Redstone	16,230	1,130
" " "	Menallen	16,230	1,130
Totals		32,460	2,260

Total Coal Area to Jan. 5, 1920 = 211,438
 Area Mined by Headings, Rooms & Cuts to Jan. 5, 1920 = 9,228

Fayette Engineering Co. Per: E. C. Dancy

EXHIBIT "A"
 STRUTHERS COAL & COKE COMPANY
 COMMISSIONERS TO AUDITOR GENERAL
 STATE OF PENNSYLVANIA, dated
 March 28th, 1920.