

JAS. P. LYTLE

(To Intersection Cont. 21803.44)

1030 FT.

S 65 E

(To Intersection 1483.23)

1350 FT.

AREA TO BOUNDARY LINE
19.27 ACRES.

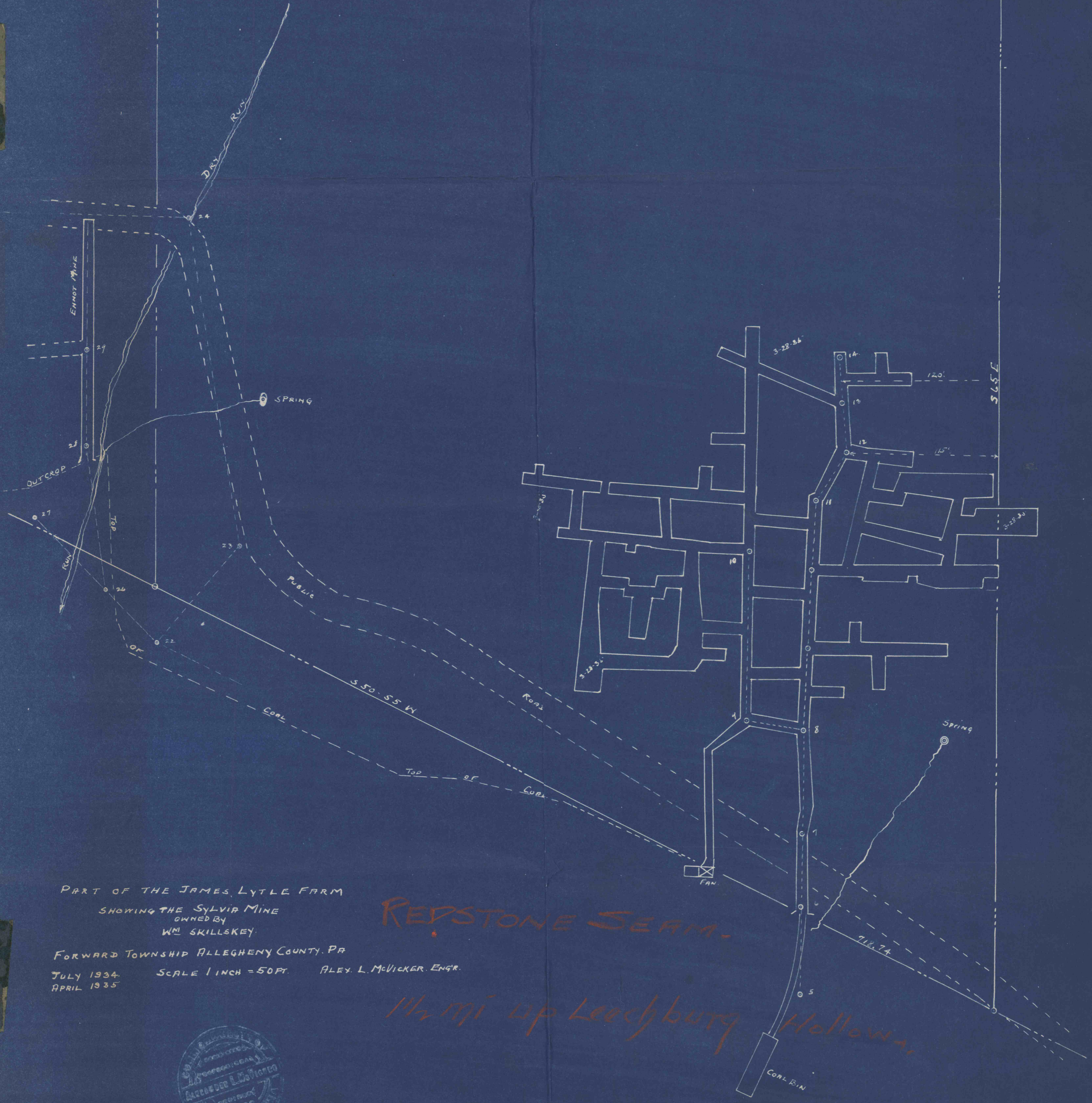

PART OF THE JAMES, LYTLE FARM
SHOWING THE SYLVIA MINE
OWNED BY
WM SKILLSKEY.

REDSTONE SEAM.

FORWARD TOWNSHIP ALLEGHENY COUNTY, PA

JULY 1934 SCALE 1 INCH = 50 FT. ALEX. L. McVICKER, ENGR.

APRIL 1935

1/2 mi up Leechburg Hollow

