

DATE OF SURVEY

NOV. 14, 1919=K.
MAY 11, 1920=L.

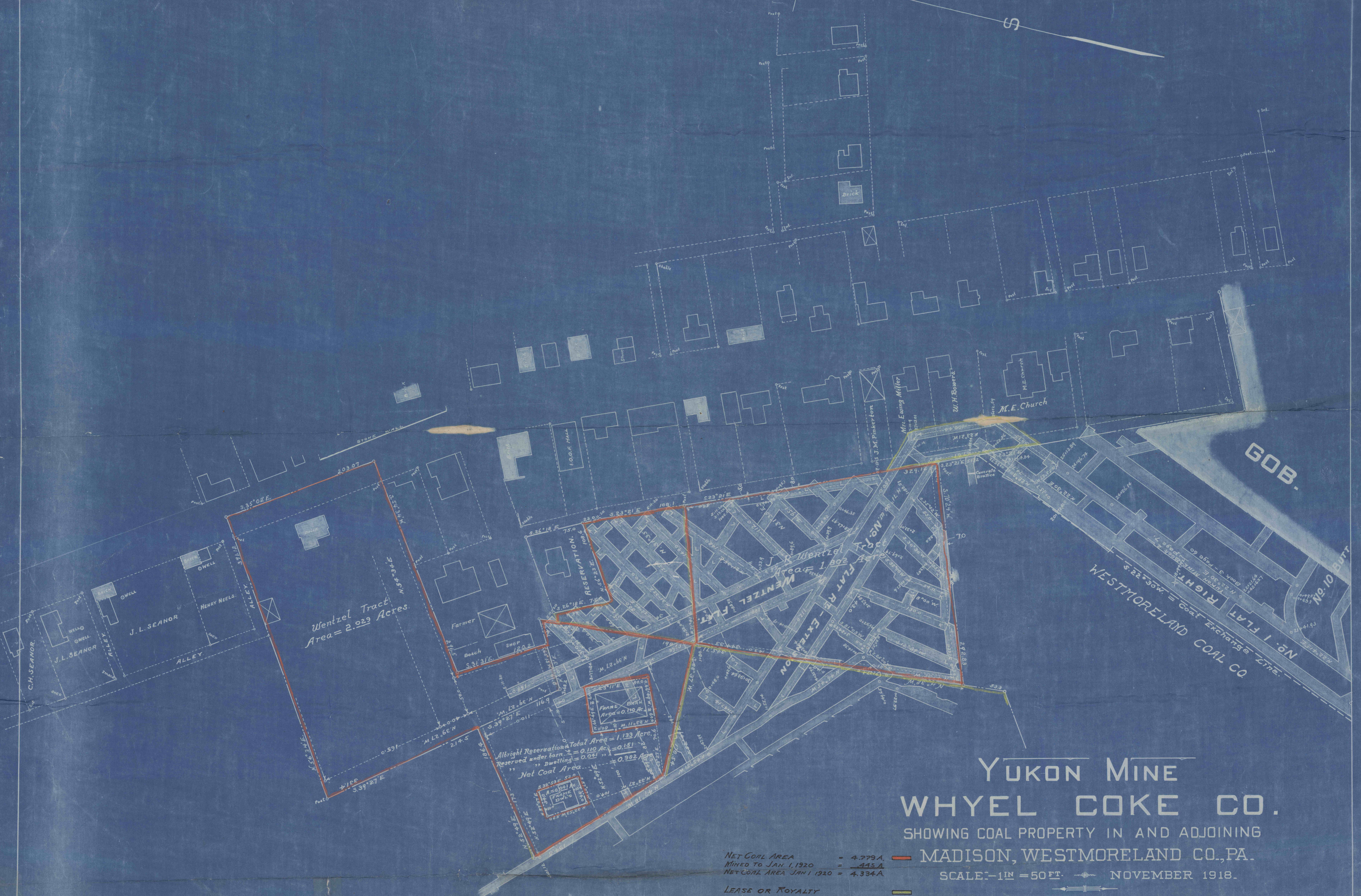
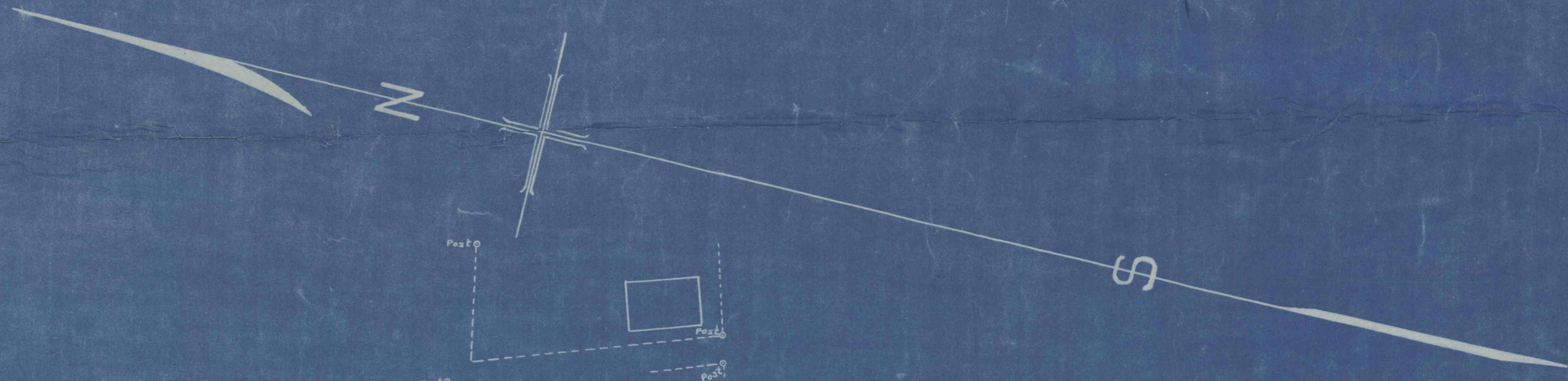

Wentzel Tract
Area = 2.023 Acres.

Albright Reservations Total Area = 1.133 Acres.
Reserved under barn = 0.110 Ac. = 0.151
Dwelling = 0.021 " = 0.022
Net Coal Area = 0.992

YUKON MINE WHYEL COKE CO.

SHOWING COAL PROPERTY IN AND ADJOINING
MADISON, WESTMORELAND CO., PA.

SCALE - 1" = 50 FT. NOVEMBER 1918.

NET COAL AREA = 4.779 A.
MINED TO JAN. 1, 1920 = 1.445 A.
NET COAL AREA JAN. 1, 1920 = 4.334 A.

LEASE OR ROYALTY
PITTSBURGH VEIN OF COAL 6' 6" THICK.

Fayette Engineering Co., Uniontown, Pa.

KEYSTONE COAL AND COKE CO.

GOB.

WESTMORELAND COAL CO
RIGHTS
No. 1 FLAT
No. 10 BUTT