

RECEIVED
JUL 13 2000

Dept. of Environmental Protection
Monroney District Office

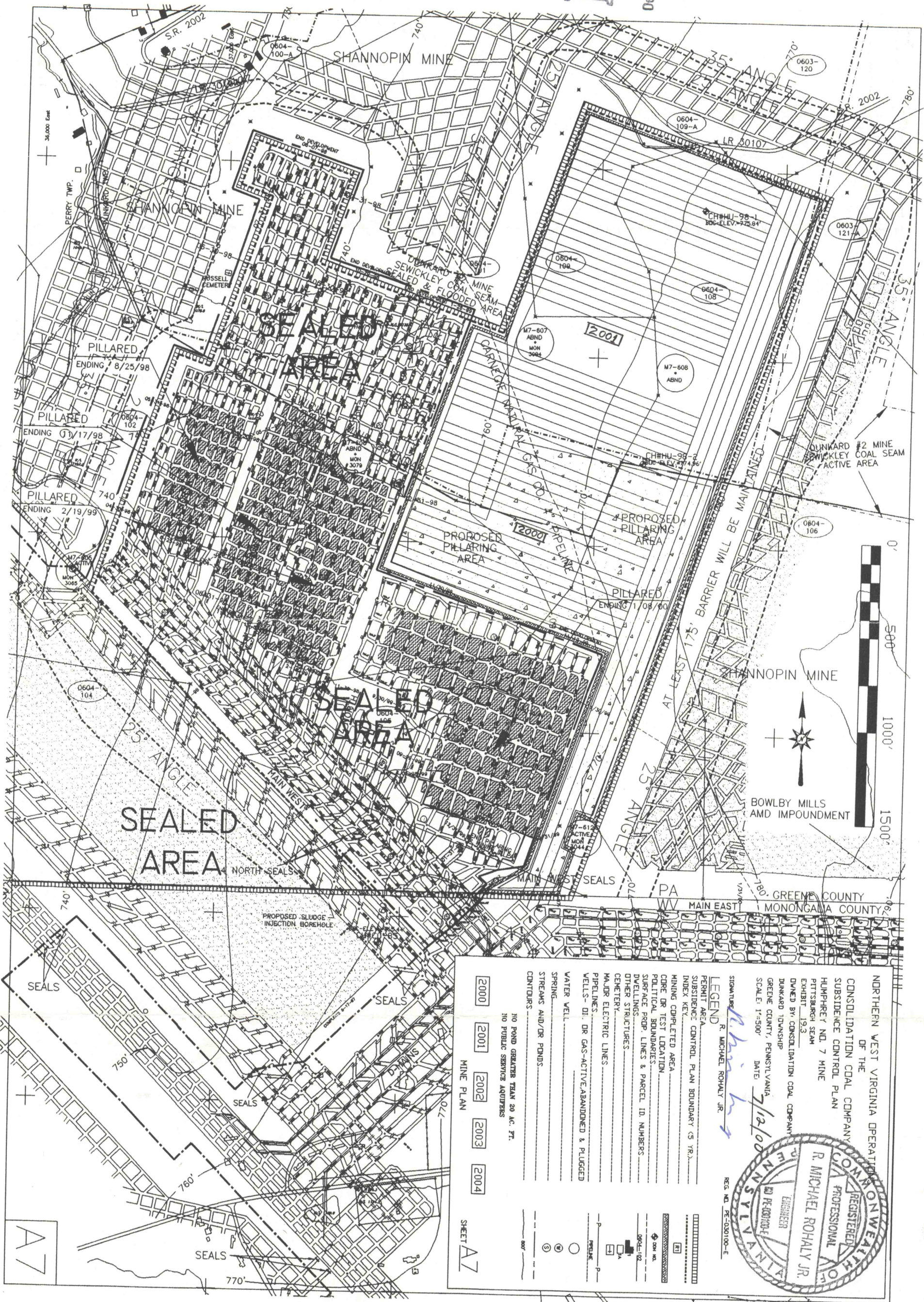

NORTHERN WEST VIRGINIA OPERATING COMPANY
OF THE
CONSOLIDATION COAL COMPANY
SUBSIDENCE CONTROL PLAN
HUMPHREY NO. 7 MINE
PITTSBURGH SEAM
EXHIBIT 193
DIVIDED BY CONSOLIDATION COAL COMPANY
DUNKARD TOWNSHIP
GREENE COUNTY, PENNSYLVANIA
SCALE: 1"=500'

DATE: 7/12/00

REG. NO. PE-030100-E

REGISTERED PROFESSIONAL ENGINEER
R. MICHAEL ROHALY JR.

LEGEND

- PERMIT AREA
- SUBSIDENCE CONTROL PLAN BOUNDARY (S.Y.R.)
- INDEX KEY
- MINING COMPLETED AREA
- CODE OR TEST LOCATION
- POLITICAL BOUNDARIES
- SURFACE PROP. LINES & PARCEL ID. NUMBERS
- DWELLINGS
- OTHER STRUCTURES
- CEMETERY
- MAJOR ELECTRIC LINES
- PIPELINES
- WELLS - DI. OR GAS-ACTIVE/ABANDONED & PLUGGED
- WATER WELL
- SPRING
- STREAMS AND/OR PONDS
- NO POND GREATER THAN 20 AC. FT.
- NO PUBLIC SERVICE BUILDINGS

2000 2001 2002 2003 2004

MINE PLAN

SHEET A7