

Small white rectangular label in the top left corner with illegible text.

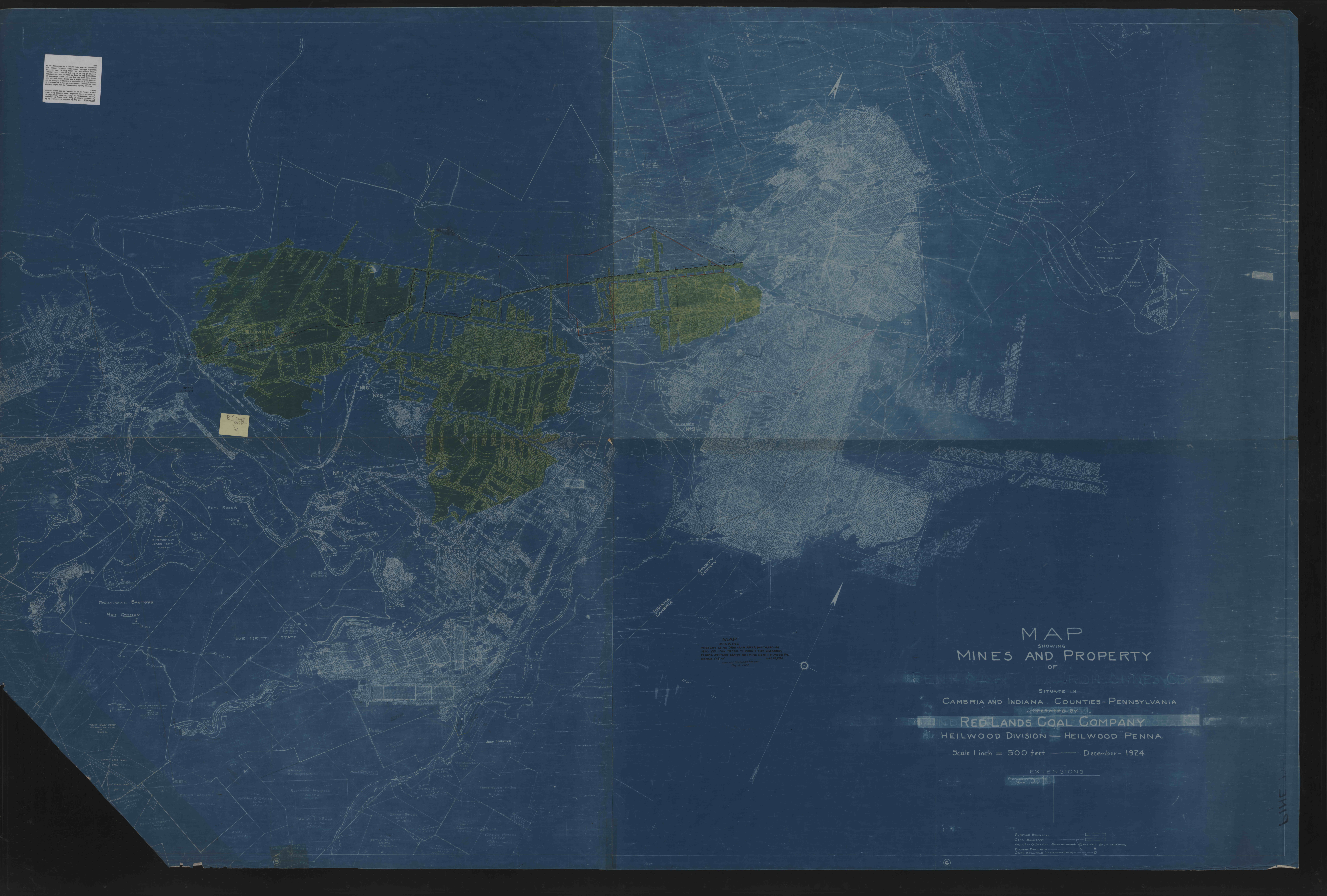

Handwritten note: "B.C. CASE" with a checkmark.

MAP SHOWING PRESENT AND PROPOSED DRAINAGE AREAS DISCHARGING INTO BELLEVILLE CREEK THROUGH THE MARIETTA PLUMS AT PEAK BEARS' ALLIANCE NEAR HEILWOOD, PENNSYLVANIA. SCALE 1:50,000. DATE 12/1/24.

MAP SHOWING MINES AND PROPERTY OF

RED LANDS COAL COMPANY
SITUATE IN CAMBRIA AND INDIANA COUNTIES - PENNSYLVANIA
OPERATED BY

RED LANDS COAL COMPANY
HEILWOOD DIVISION - HEILWOOD PENNA.

Scale 1 inch = 500 feet — December - 1924

EXTENSIONS

Surface Boundary	—
Coal Boundary	—
Mine	—
Discharge Point	—
Other	—

Handwritten note: "LINE"