

BLAIRSVILLE CEMETERY

MAHER LAND

OTHER PART OF CATHOLIC CEMETERY

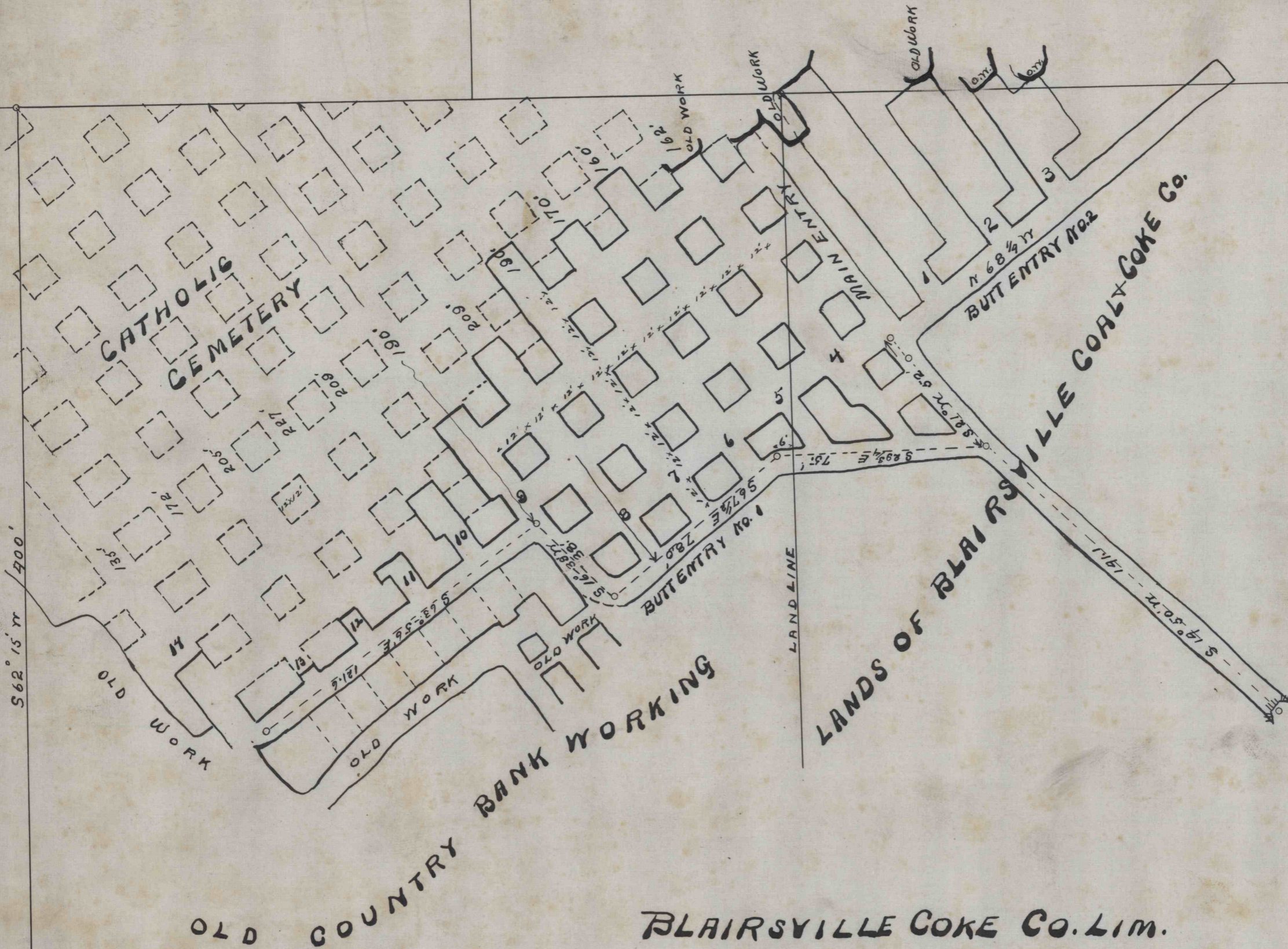

BLAIRSVILLE COKE CO. LIM.

NO. 2 MINE

WILSON AND SMITH  
CIVIL ENGINEERS

JAN. 4. 1902.

SCALE 1" = 90'

4261