

ON THIS 25 DAY OF MAY 1951, BEFORE ME THE  
 UNDERSIGNED OFFICER, PERSONALLY APPEARED  
**JAMES FROGGATT** WHO ACKNOWLEDGED THAT  
 THE DAM HEREON DETAILLED WAS CONSTRUCTED  
 BY HIM OR UNDER HIS SUPERVISION ACCORDING TO  
 THE SPECIFICATIONS SHOWN.

*Alfred W. Wagner*  
 NOTARY PUBLIC  
 My Commission Expires January 4, 1953

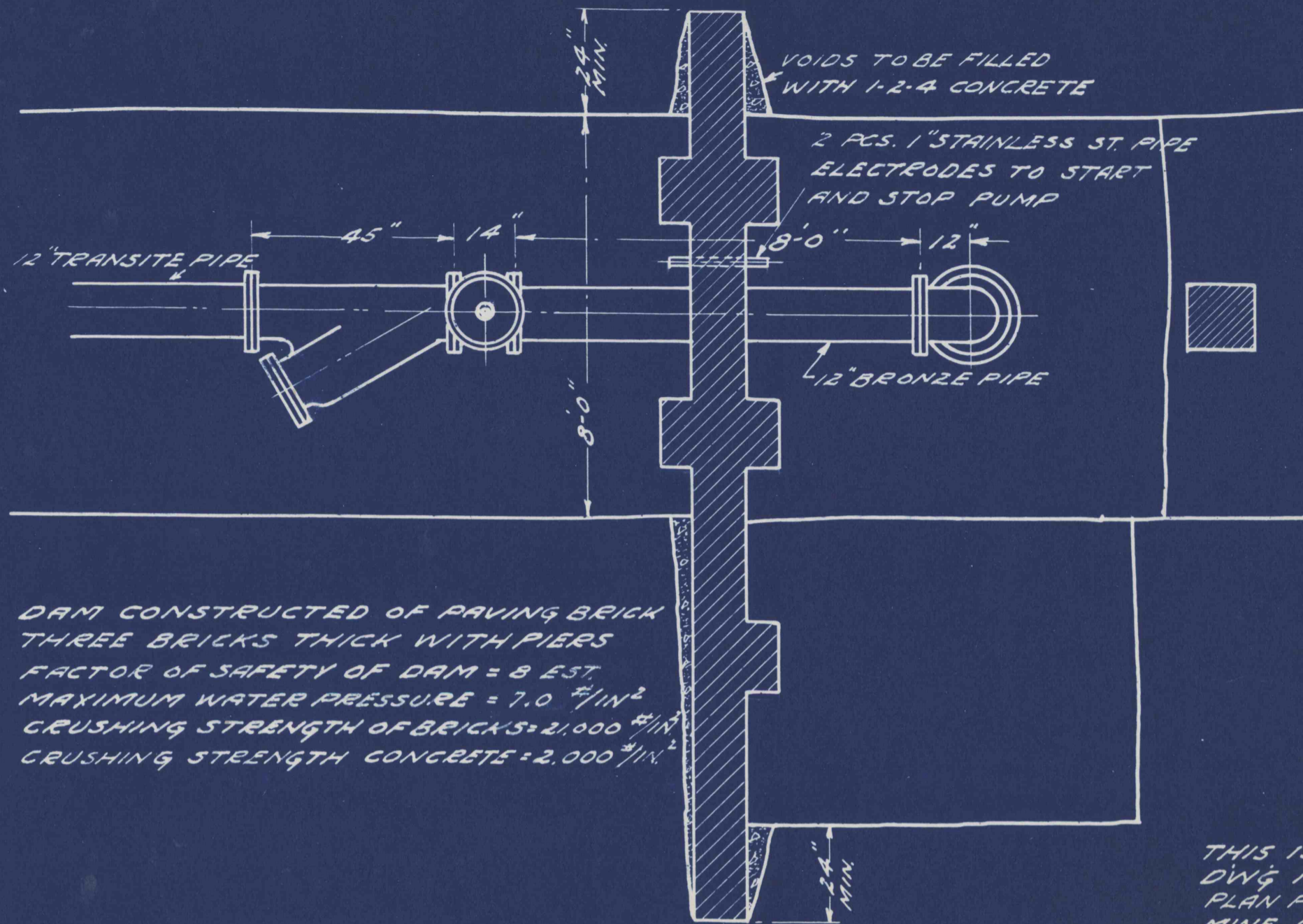

THIS IS TO CERTIFY THAT THIS BLUE PRINT,  
 DWG NO. K-4-21 IS A CORRECT COPY OF THE  
 PLAN FOR THE DAM CONSTRUCTED IN HUGHES NO.2  
 MINE, C.A. HUGHES & CO.

*Alfred W. Wagner*  
 ENGINEER

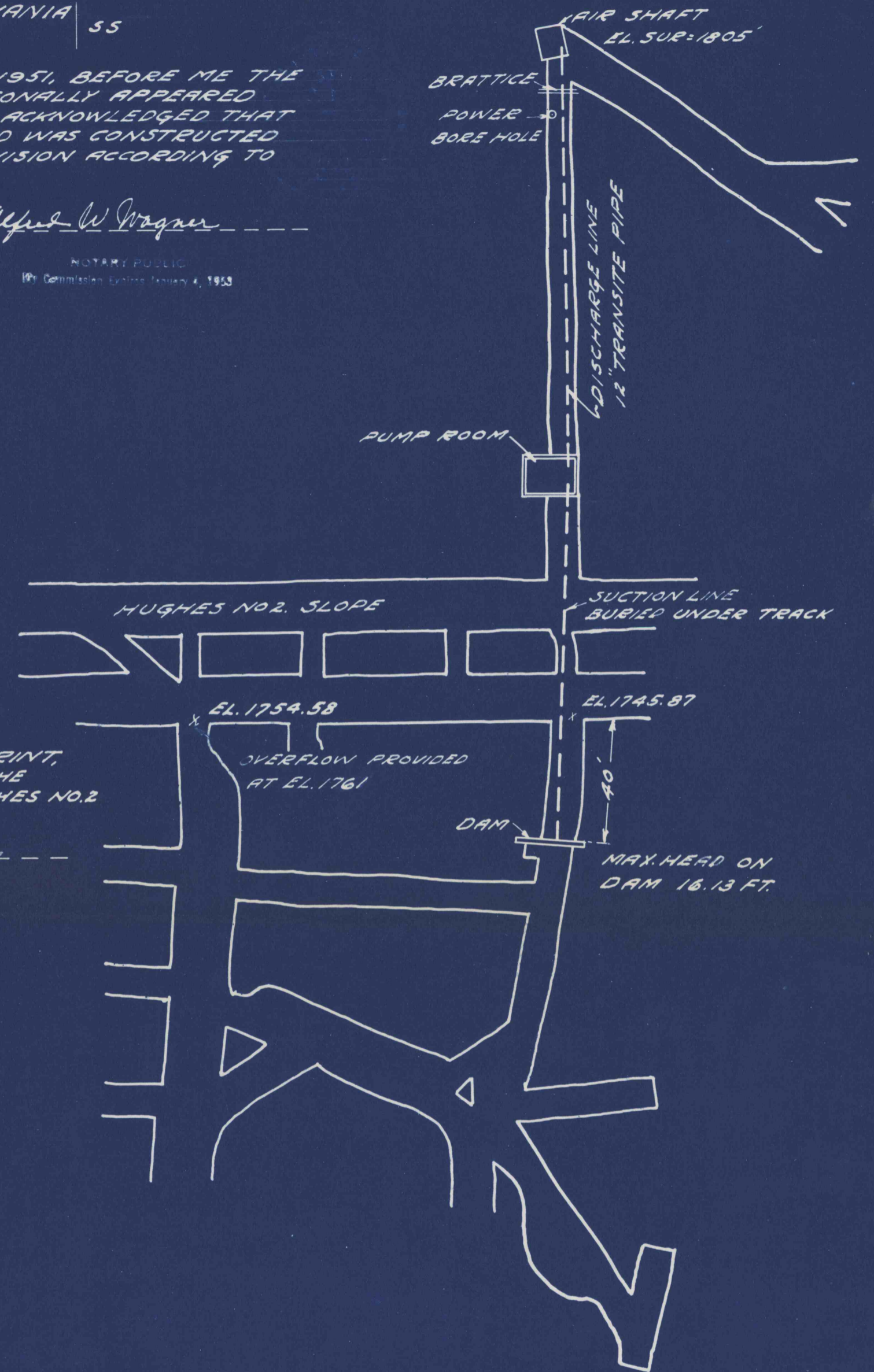

THIS TRACING SUPERSEDES TRACING  
 K-4-20 WHICH HAS BEEN MADE  
 OBSOLETE ON ACCOUNT OF CHANGES  
 AND ADDITIONS

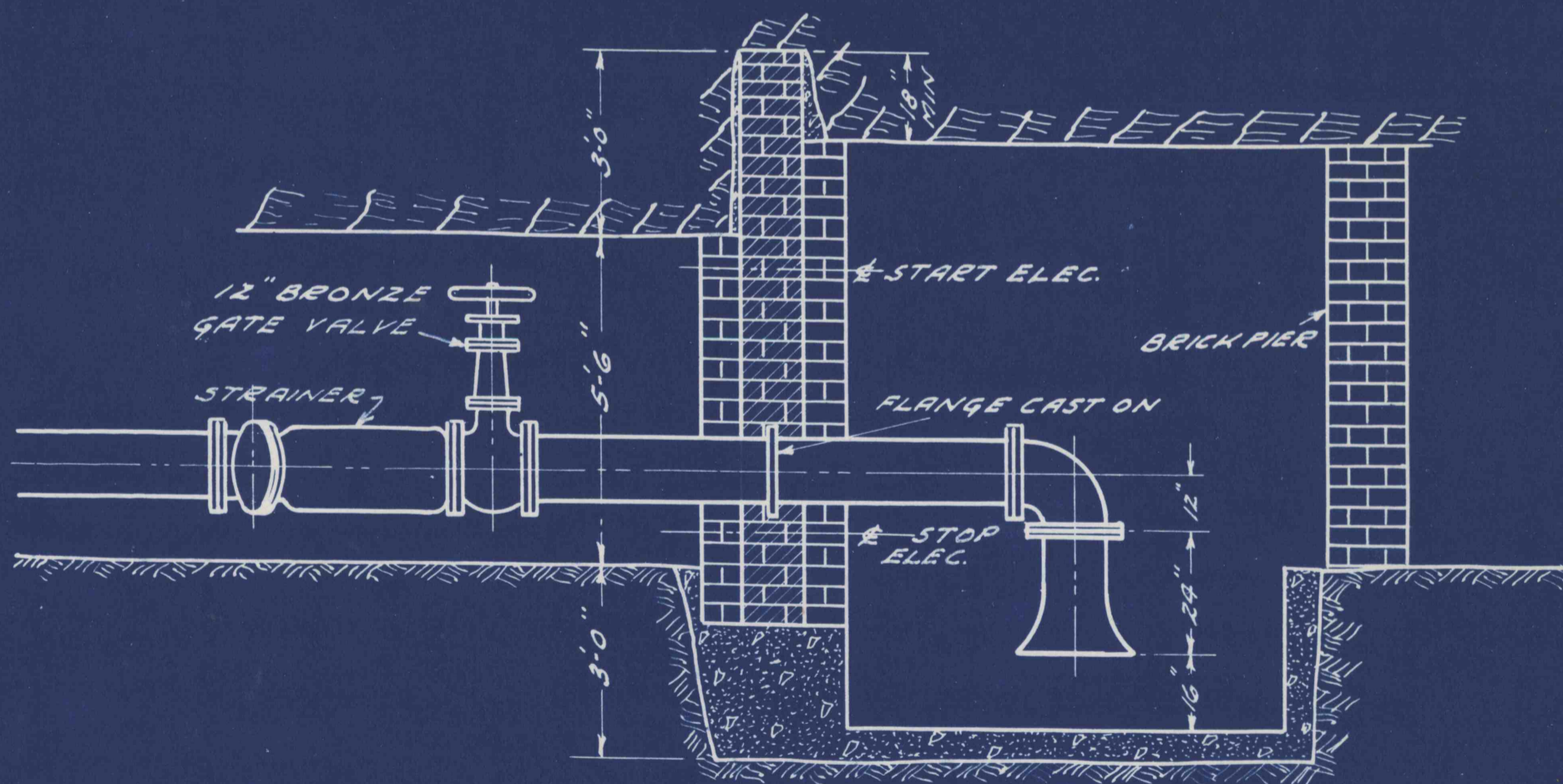

APPROVED:-

*W. R. Cunningham*  
 W. R. CUNNINGHAM, INSPECTOR  
 7TH. BITUMINOUS DISTRICT.

*Richard E. George*  
 RICHARD E. GEORGE, INSPECTOR  
 18TH. BITUMINOUS DISTRICT.

*Charles E. Fisher*  
 CHARLES E. FISHER, INSPECTOR  
 10TH. BITUMINOUS DISTRICT.

C. A. HUGHES & CO.  
 CRESSON, PA.

HUGHES NO.2 MINE  
 SUMP AND DAM  
 ROCK HEADING CUTTHROUGH

SCALE 3/8" = 1 FT.  
 1" = 40 FT.

DRAWN BY E.P.J.

CHECKED BY E.P.J.

DATE 3-12-51

APPROVED  
 K-4-21