

DDH. N^o 1
SUR. 1583.0
Det. Cont. - 1433.3

DDH.
SUR. 1531.30
Det. Cont. - 1433.3

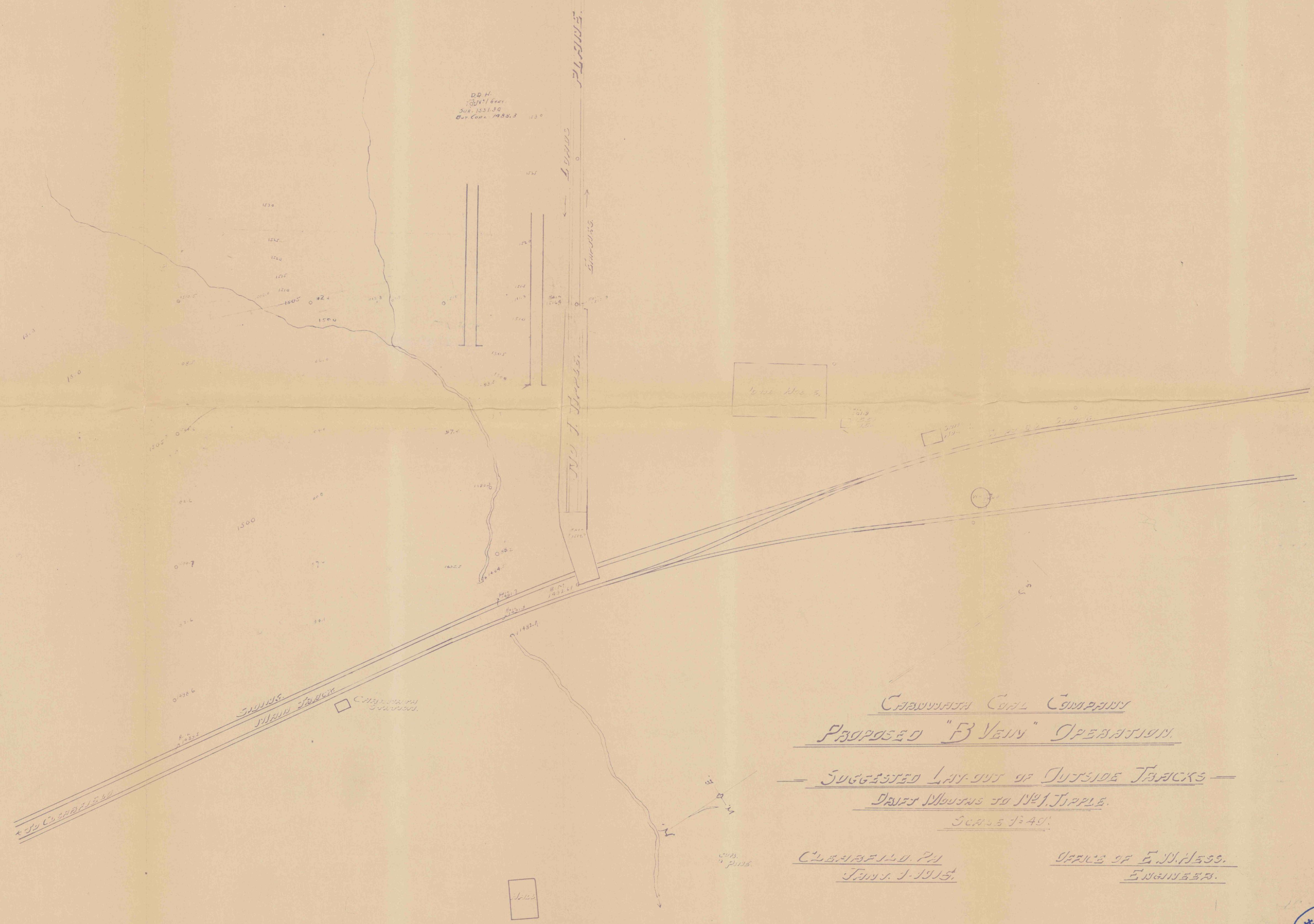

CARROLLTON COAL COMPANY
PROPOSED "B VENN" OPERATION.

SUGGESTED LAY-OUT OF OUTSIDE TRACKS

DRIFT MOUNTAINS TO NEW J. BRIDGE.

SCALE 1" = 40'

CLEVELAND, OH
JAN. 1-1915.

OFFICE OF E. D. HESS,
ENGINEER.

#465
6-22-99
cc.