

- 7 Pandall Smith
- 5 Jamie Keeler
- 11 John Campbell
- 23 Debra Goodman
- 2 Harry Pierce
- 22 Sara Marie Dunmire
- 23 Sara Marie Dunmire
- 34 Wes' Lebanon Cemetery
- 25 D.G. Wertz Coal Inc.
- 26 D.G. Wertz Coal Inc.
- 27 Daniel McCracken
- 28 Arthur Velisig
- 29 Emma M. Zak
- 30 Arthur Velisig
- 31 Arthur Velisig
- 32 Robert Sommers
- 33 Angeline Wilson
- 34 Vaughn Dotts
- 35 Sara Ray
- 36 Sara Ray
- 37 John Velisig
- 38 Esther Lingham
- 39 Marion Johnson
- 40 Mike Bertolino
- 41 Liberty Bertolino
- 42 Liberty Bertolino
- 43 Daniel McCracken
- 44 Daniel McCracken
- 45 Floyd Lester Smith
- 46 Herschel Hosack
- 47 West Lebanon Community Holiness Church
- 48 Home Missions of Church of God Inc.
- 49 Vaughn Dotts
- 50 Charles Duncan
- 51 Charles Duncan
- 52 West Lebanon Community Holiness Church
- 53 James Dunmire
- 54 Helen Dunmire
- 55 Norma Richard
- 56 Norma Richard
- 57 Harry Seger
- 58 Ruth Coleman
- 59 West Lebanon Vol. Fire Dept.
- 60 West Lebanon Community Assoc.
- 61 Ruth Coleman
- 62 Valentine Wisniewski
- 64 Max Craig
- 65 James Bentley
- 66 John Velisig
- 67 John Velisig
- 68 Peoples Bank of West Lebanon
- 69 John Velisig
- 70 Glenn Dixon
- 71 Marie Cottins
- 72 Max Rudock
- 73 Helen Dunmire
- 74 Lloyd Stewart
- 75 Harry Bridenthal
- 76 Virginia McCracken
- 77 Virginia McCracken
- 78 Daniel McCracken
- 79 Robert Coulter
- 80 Daniel McCracken
- 81 West Lebanon School
- 82 Youngs Tap Road District
- 83 D.G. Wertz Coal Inc.
- 84 Samuel J. Berger

BOND INCREMENT STATUS				
Mining Acres	Support	Total	Act.	Status
0-85'	85'-115'	+115'		
12.2	2.7	3.0	10.3	25.2
				Accumulated

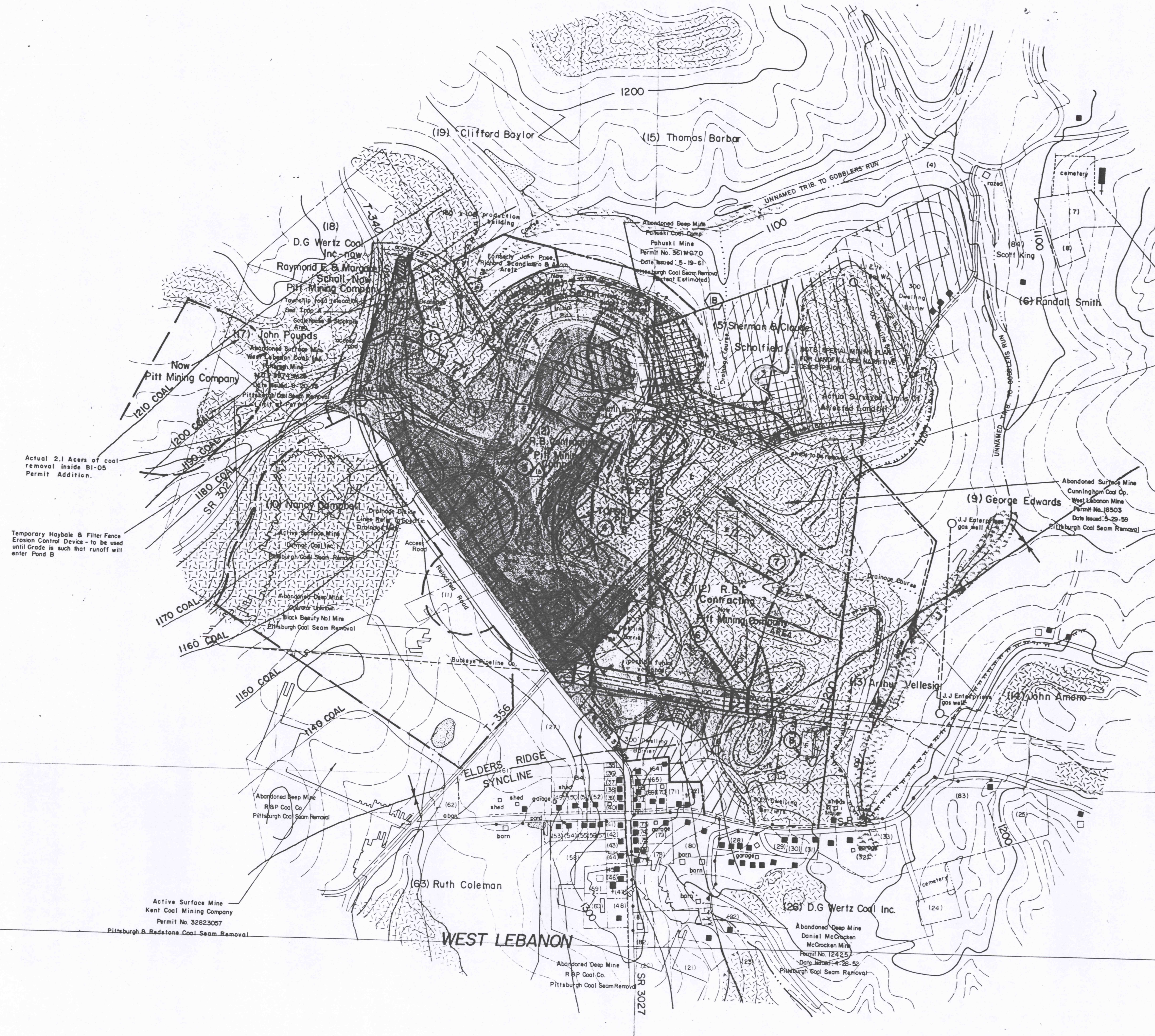

Company	2007-2008	2009-2010	2011-2012
Pitt Mining Company	12.2	2.7	3.0
D.G. Wertz Coal Inc.	10.3	25.2	
Total	22.5	27.9	33.0

RECEIVED
Aug 2 2008
Bureau of Mine Safety
Uniontown

LEGEND

- TOTAL MINE DRAINAGE PERMIT 272.3 acs.
- AMENDED AREA 10.0 acres
- MINE DRAINAGE PERMIT 262.3 acres
- BARRIER ZONES
- KEY NO. TO INDIVIDUAL PROPERTY OWNERS (15)
- OCCUPIED DWELLINGS
- PROPERTY LINE
- PREVIOUSLY SURFACE MINED AREAS
- SEDIMENTATION POND
- TREATMENT FACILITY
- APRON OF RIPRAP
- COLLECTION DITCH
- DIVERSION DITCH
- DIKING
- SEDIMENT TRAP
- LEVEL LIP SPREADER
- TOPSOIL STOCKPILE
- SOILS QUALIFIED AS PRIME FARMLAND
- PRIME FARMLAND STOCKPILE
- SEQUENCE OF MINING
- PITTSBURGH COAL SEAM OUTCROP
- DEEP MINE ENTRY
- DEEP MINE EXTENT
- WETLANDS
- SCHOLFIELD SANITARY LANDFILL EXTENT
- GASLINE
- BELL TELEPHONE UNDERGROUND CABLE
- WATERLINE
- POWERLINE
- BOND INCREMENT APPROVAL
- MINING - 0'-85' HIGHWALL
- MINING - 85'-115' HIGHWALL
- MINING - > 115' HIGHWALL
- SUPPORT
- EXTENT OF ACTUAL LANDFILL ACTIVITIES
- BLASTING AREA
- ABANDONED REDSTONE HIGHWALL
- ABANDONED PITTSBURGH HIGHWALL
- INITIAL 20acs. AREA FOR BIO-SOLID PLACEMENT
- REMAINING 20 acre increments
- PROPOSED GROUNDWATER MONITORING WELLS

UTILITY LEGEND

TYPE OF UTILITY	COMPANY	ADDRESS	MAP SYMBOL
Gasline	T.W. Phillips Gas and Oil Co.	205 North Main St. Butler, Pa. 16001	
Electric	Southwest Electric Cooperative	Airport Rd. Indiana, Pa.	
	Buckeye Pipeline Co.	RD 1, Indiana, Pa.	
Water	West Lebanon Water Authority	West Lebanon, Pa.	

VAPCO ENGINEERING
PUNXSUTAWNEY, PENNSYLVANIA

APPROVED: [Signature]
DATE: [Date]

NOTES:
1. This map has been prepared from county tax maps, filed B field markers. This map represents a partial survey of property lines shown.
2. Contour lines and natural features were taken from a survey of 7.5 min. Merit No. 15 S.S. quadrangle.

RECEIVED
SEP - 6 1986
ERIE COUNTY DISTRICT OFFICE
02470

PROPOSED SURFACE MINE
PITT MINING COMPANY
WEST LEBANON MINE
Indiana Co.
Young Twp.

EXHIBIT 9
OPERATIONS
MAP