

JAMES LEAMER

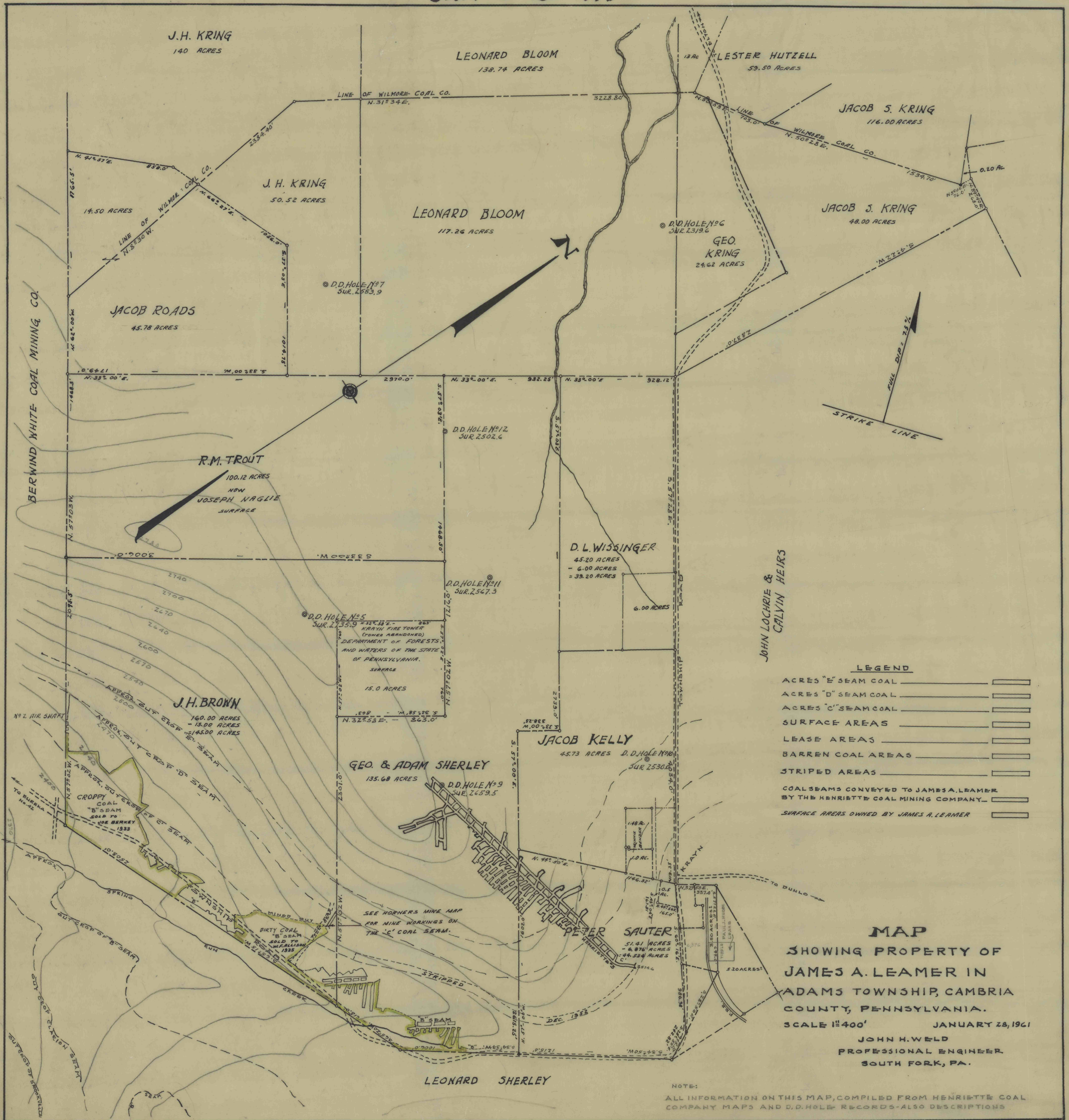

LEGEND

- ACRES "E" SEAM COAL
- ACRES "D" SEAM COAL
- ACRES "C" SEAM COAL
- SURFACE AREAS
- LEASE AREAS
- BARREN COAL AREAS
- STRIPED AREAS
- COAL SEAMS CONVEYED TO JAMES A. LEAMER BY THE HENRIETTE COAL MINING COMPANY
- SURFACE AREAS OWNED BY JAMES A. LEAMER

MAP
 SHOWING PROPERTY OF
JAMES A. LEAMER IN
 ADAMS TOWNSHIP, CAMBRIA
 COUNTY, PENNSYLVANIA.
 SCALE 1" = 400' JANUARY 28, 1961
 JOHN H. WELD
 PROFESSIONAL ENGINEER
 SOUTH FORK, PA.

NOTE:
 ALL INFORMATION ON THIS MAP, COMPILED FROM HENRIETTE COAL
 COMPANY MAPS AND D.D. HOLE RECORDS-ALSO DESCRIPTIONS