

Surface (S) and Coal (C) Owners
 Capitals indicate affected properties.
 Surface and Coal Owners are the same unless noted.

- | | |
|--|-----------------------------------|
| (1) JAMES J. ANDERSON | (111) Mark E. Bruner |
| (2) RONALD W. LOVE | (112) BRADLEY L. CRAIG |
| (3) DEAN A. SNYDER | (113) RANDY M. CRAIG |
| (4) John C. Jamison | (114) BRADLEY L. CRAIG |
| (5) Robert L. Tressler | (115) RANDY M. CRAIG |
| (6) John R. Shaffer, Jr. | (116) Clifford L. Baylor |
| (7) Robert Benkowski | (117) RICHARD H. FISCUS |
| (8) Cynthia J. Blystone | (118) RONALD H. BUZZARD |
| (9) Michael L. Flickinger | (119) Gary L. Toy |
| (10) James C. Steffey | (120) Barbara M. Clark |
| (11) Jeffery A. Howell | (121) Maurice L. Tosi |
| (12) FRED C. PUGLIESE | (122) Robert L. Townsend |
| (13) Alfred G. Shaw | (123) Lawrence E. O'Masta |
| (14) Linda L. Kromer | (124) Diane B. Gearhart |
| (15) Jack N. Silvis | (125) Harry J. Smith |
| (16) Richard R. Reardon | (126) John G. Weaver |
| (17) Armstrong County Commissioners | (127) Thomas E. Palermo |
| (18) Robert S. Townsend | (128) Michael R. Denning |
| (19) Gerald T. Bush | (129) Milton C. Stinemann |
| (20) DALE W. HEMKE | (130) Allen Shellhammer |
| RONALD G. MCINTIRE - C | (131) Evangelical Reformed Church |
| (21) ROBERT R. COLEMAN | (132) FLOYD B. STOUTON III |
| JAY W. SWAN | ALAN KEITH HILL - C |
| (22) Steve Kundrak | (133) Martha Anna Hallis |
| (23) RONALD G. MCINTIRE | (134) Helen W. O'Masta |
| (24) HENRY TOWNSEND, JR. | (135) Charlie E. Kutach |
| EDWARD J. PINO - S | (136) EDWARD GAMBLE |
| PATSY A. PINO - C | (137) Shirley J. Agudo |
| (27) PATSY A. PINO | (138) Bruce E. Sturm |
| (28) DAVID E. DUNMIRE | (139) Clarence E. Altman |
| (29) JAMES W. DUNMIRE | (140) Donald L. Altman |
| (30) Harry J. Davis | (141) Torrence E. Townsend |
| (31) Ronald H. Buzzard | (142) Ronald L. McCouland |
| (32) ROBERT BENKOWSKI | (143) William Jones |
| (33) EDWIN B. ARMITAGE ESTATE | (144) RAYMOND A. HELD |
| (34) MELVIN L. DESCHAND | |
| (35) Rochester & Pittsburgh Coal Co. | |
| (36) Charles A. Colton | |
| (37) THOMAS M. SMITH | |
| RONALD G. MCINTIRE - C | |
| (38) MICHAEL E. REEFER | |
| RONALD G. MCINTIRE - C | |
| (39) ARTHUR L. BLYSTONE | |
| RONALD G. MCINTIRE - C | |
| (40) RONALD G. MCINTIRE | |
| (41) JAMES R. HILTY | |
| (42) THOMAS H. MORAN - S | |
| PATSY A. PINO - C | |
| (43) ROBERT B. BOYER - S | |
| PATSY A. PINO - C | |
| (44) MARGARY R. MARITTELL | |
| DA FISCUS PLUM - C | |
| (45) THOMAS PAUL FISCUS | |
| (46) JERRY G. WILSON - S | |
| ROCHESTER & PITTSBURGH COAL COMPANY - C | |
| (47) DONALD F. KNIZE - S | |
| ROCHESTER & PITTSBURGH COAL COMPANY - C | |
| (48) FRANK J. NEMETH - S | |
| ROCHESTER & PITTSBURGH COAL COMPANY - C | |
| (49) DENNIS SNYDER | |
| (50) ELI H. SNYDER | |
| (51) JAMES PENCOLA | |
| (52) DEWITT SHELLHAMMER | |
| (53) MARK E. BAER | |
| (54) NORTHERN ELK DEVELOPMENT | |
| (55) SAMUEL G. CLINE | |
| WILLIAM MCINTIRE - C | |
| (56) HAZEL ECKMAN | |
| (57) KEVIN D. SILVIS | |
| (58) JAMES M. HOLLENBAUGH | |
| (59) ROBERT E. KELLY | |
| (60) ALAN KEITH HILL | |
| (61) CONSOLIDATED GAS TRANSMISSION CORP. | |
| GLENN E. LEARN | |
| (62) ROONEY D. CRAWFORD | |
| (63) CAROLE L. HOLLAND | |
| (64) Daniel B. Davis | |
| (65) JOHN T. SICKON, JR. | |
| (66) IRA GEORGE WEAVER | |
| ANGELA BRUNO ESTATE - C | |
| (67) GREG J. CURRY | |
| (68) Andrew F. Smetana | |
| (69) Thelma Burg | |
| (70) Adolph E. Mayuric | |
| (71) Russell C. Kyler | |
| (72) Max T. Craig | |
| (73) GRACE M. WALKER | |
| (74) Daniel J. Beavino | |
| (75) Lawrence Cumberledge | |
| (76) Russell R. Roush | |
| (77) Richard R. Rearick | |
| (78) Leland C. Atkins | |
| (79) LANCE R. CRISMAN | |
| ALAN KEITH HILL - C | |
| (80) DAVID P. GABRIELIK, JR. | |
| ALAN KEITH HILL - C | |
| (81) Todd M. Frampton | |
| (82) Alan D. Wilson | |
| (83) James L. Oster | |
| (84) John Ondo | |
| (85) Raymond Rogger | |
| (86) Robert M. Knox | |
| (87) David J. Carasso | |
| (88) Hugh F. Stockdale | |
| (89) John Ondo | |
| (90) KENT COAL MINING CO. | |
| (91) George Haber, Jr. | |
| (92) Daniel Fine | |
| (93) Terry W. George | |
| (94) Richard Hooge | |
| (95) TERRENCE M. HOSAC | |
| (96) ROBERT A. ECKMAN | |
| (97) SAMUEL G. CLINE | |
| (98) HERMAN K. ECKMAN | |
| (99) JOHN S. ROOSE | |
| (100) Daniel B. Davis | |
| (101) Robert H. Houston | |
| (102) HERMAN K. ECKMAN | |
| (103) ROBERT M. BIRGE | |
| (104) WARD E. BAYLOR | |
| (105) SANFORD B. REARICK | |
| (106) Alan C. Henderson | |
| (107) John Peace | |
| (108) Pitt Mining Co. | |
| (109) David R. Bruner | |

MAP NOTES / COMMENTS

There will be no mining on adverse properties until T.J.S. Mining, Inc. controls the coal rights.

Property lines are based on county tax maps, not actual field survey.

There will be no mining within 100 feet of any active and/or abandoned UPPER FREEPORT surface and/or deep mine unless it is specifically noted in the mine permit application.

The locations of major gas lines (4" or greater) are based on gas company maps and have not been verified in the field.

A 400 foot barrier will be maintained along Crooked Creek in the northeast portion of the permit boundary.

Map Legend

- Gas Well with 100 foot barrier
- Background Sampling Point
- Water Monitoring Point
- Spring
- Water Well
- Exploration Drill Hole
- Occupied Structure
- Unoccupied Structure
- 100 Foot Cover Line
- Upper Freeport Coal Contour
- Upper Freeport Coal Outcrop
- Property Line
- Intermittent Stream
- Perennial Stream
- Subsidence Boundary
- Major (4"+) Gas Line
- No Mining Zone
- Old Permit Limit
- Permit Boundary
- Existing Mine Key
- Yearly Mining Increment
- Abandoned Mine Entry
- Limit of Existing Mine Permit
- Adverse Property
- Limit of Surface Activity Site
- Stream Protection (No Mining)
- Stream Protection (1st Mining)
- Existing Surface Mining
- Existing Deep Mining

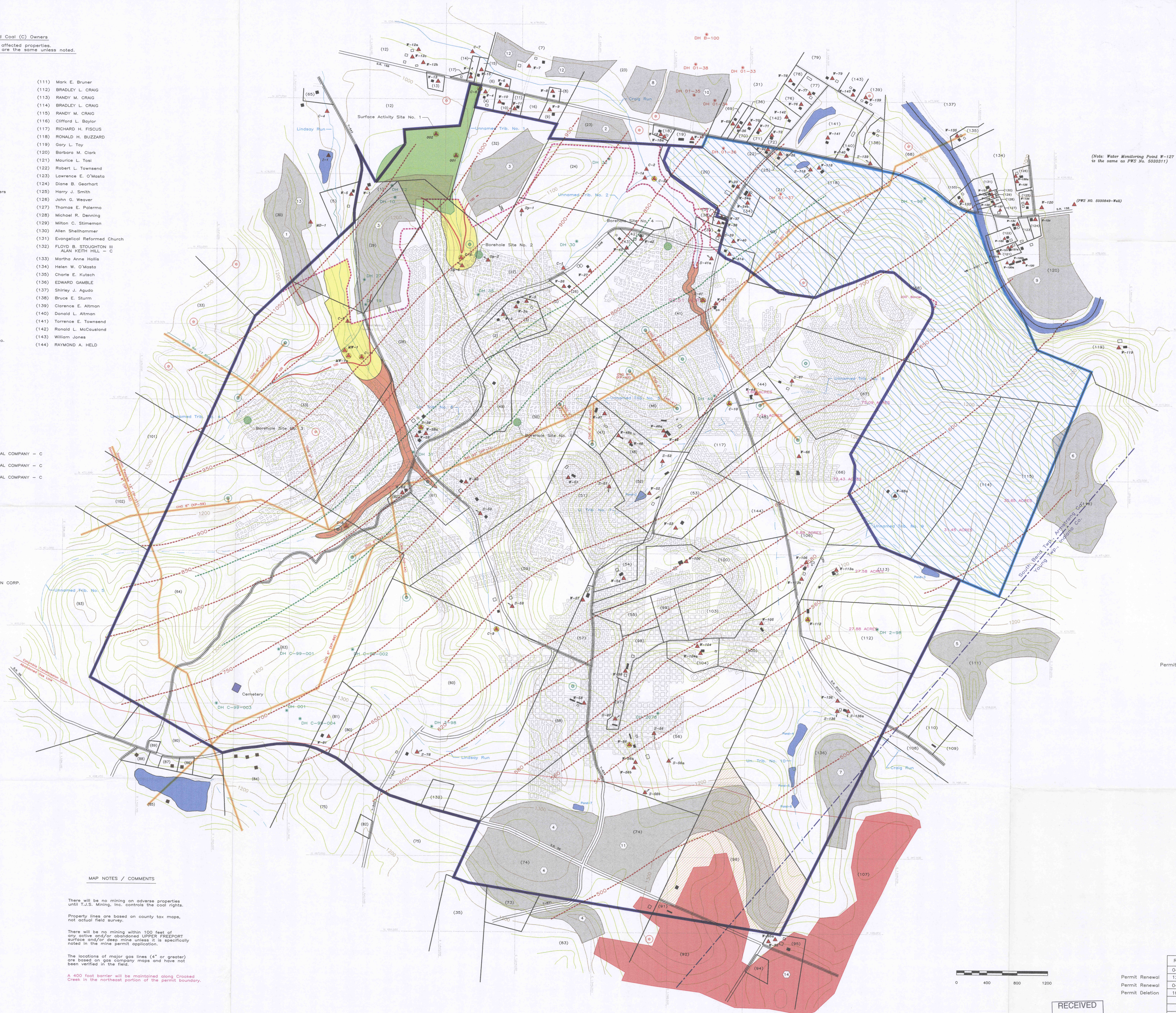

(Note: Water Monitoring Point W-127 is the same as PWS No. 5030311)

Permit Deletion Area (314.9 Acres)

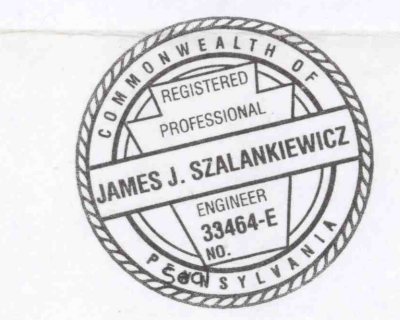

J. Scalaprinco

Final Mine Map
 Environmental Resources Map

TJS No. 1 Deep Mine

TJS Mining, Inc.
 R.D. #1, Shelcta, PA 15774

South Bend Twp., Armstrong Co.

UPPER FREEPORT COAL SEAM

JMO 10-10-97

1" = 400' Module 6.3 Map

Revisions	DATE	FOR	LOCATION	SEAM	DRAWN BY	DATE	SCALE	DRAWING NO.
04-23-99	04-23-99							
12-07-00	12-07-00							
04-04-01	04-04-01							
10-25-04	10-25-04							

Permit Renewal
 Permit Deletion

RECEIVED
 OCT 28 2004

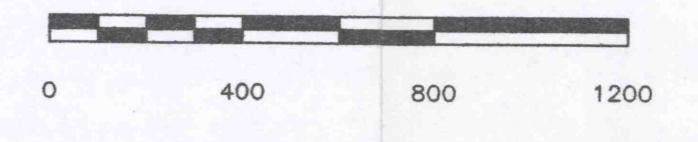

JMO 10/28/04
 RT 11/2/04