

**Surface (S) and Coal (C) Owners**  
 Capitals indicate affected properties.  
 Surface and Coal Owners are the same unless noted.

- |  |                                   |
|--|-----------------------------------|
| (1) JAMES J. ANDERSON                    | (111) Mark E. Bruner              |
| (2) RONALD W. LOVE                       | (112) BRADLEY L. CRAIG            |
| (3) DEAN A. SNYDER                       | (113) RANDY M. CRAIG              |
| (4) John C. Jamison                      | (114) BRADLEY L. CRAIG            |
| (5) Robert L. Tressler                   | (115) RANDY M. CRAIG              |
| (6) John R. Shaffer, Jr.                 | (116) Clifford L. Baylor          |
| (7) Robert Benkowski                     | (117) RICHARD H. FISZUS           |
| (8) Cynthia J. Blystone                  | (118) RONALD H. BUZZARD           |
| (9) Michael L. Flickinger                | (119) Gary L. To                  |
| (10) James C. Staffey                    | (120) Barbara M. Clark            |
| (11) Jaffery A. Howell                   | (121) Maurice L. Tsai             |
| (12) FRED C. PUGLIESE                    | (122) Robert L. Townsend          |
| (13) Alfred G. Shaw                      | (123) Lawrence E. O'Masta         |
| (14) Linda L. Kromer                     | (124) Diane B. Gearhart           |
| (15) Jack N. Silvis                      | (125) Harry J. Smith              |
| (16) Richard R. Rearick                  | (126) John G. Weaver              |
| (17) Armstrong County Commissioners      | (127) Thomas E. Palermo           |
| (18) Robert S. Townsend                  | (128) Michael R. Denning          |
| (19) Gerald T. Bosh                      | (129) Milton C. Stinemann         |
| (20) DALE W. HEWKE                       | (130) Allen Shellhammer           |
| RONALD G. MCINTIRE - C                   | (131) Evangelical Reformed Church |
| (21) ROBERT R. COLEMAN                   | (132) FLOYD B. STOUGHTON III      |
| (22) JAY W. SMAL                         | ALAN KEITH HILL - C               |
| (23) Steve Kundrak                       | (133) Martha Anne Hollis          |
| (24) RONALD G. MCINTIRE                  | (134) Helen W. O'Masta            |
| (25) HENRY TOWNSEND, JR.                 | (135) Charie E. Kutach            |
| (26) EDWARD J. PINO - S                  | (136) EDWARD GAMBLE               |
| PATSY A. PINO - C                        | (137) Shirley J. Aguda            |
| (27) PATSY A. PINO                       | (138) Bruce E. Sturm              |
| (28) DAVID E. DUNMIRE                    | (139) Clarence E. Altman          |
| (29) JAMES W. DUNMIRE                    | (140) Donald L. Altman            |
| (30) Harry J. Davis                      | (141) Terrence E. Townsend        |
| (31) Ronald H. Buzzard                   | (142) Ronald L. McCouland         |
| (32) ROBERT BENKOWSKI                    | (143) William Jones               |
| (33) EDWIN B. ARMITAGE ESTATE            | (144) RAYMOND A. HELD             |
| (34) MELVIN L. DESCHAND                  |                                   |
| (35) Rochester & Pittsburgh Coal Co.     |                                   |
| (36) Charles A. Cotton                   |                                   |
| (37) THOMAS M. SMITH                     |                                   |
| RONALD G. MCINTIRE - C                   |                                   |
| (38) MICHAEL E. REEFER                   |                                   |
| RONALD G. MCINTIRE - C                   |                                   |
| (39) ARTHUR L. BLYSTONE                  |                                   |
| RONALD G. MCINTIRE - C                   |                                   |
| (40) RONALD G. MCINTIRE                  |                                   |
| (41) JAMES R. HILTY                      |                                   |
| (42) THOMAS H. MORAN - S                 |                                   |
| PATSY A. PINO - C                        |                                   |
| (43) ROBERT B. BOYER - S                 |                                   |
| PATSY A. PINO - C                        |                                   |
| (44) MARGARY R. MARRITELL                |                                   |
| IDA FISZUS PLUM - C                      |                                   |
| (45) THOMAS PAUL FISZUS                  |                                   |
| (46) JERRY G. WILSON - S                 |                                   |
| ROCHESTER & PITTSBURGH COAL COMPANY - C  |                                   |
| (47) DONALD F. KNIZE - S                 |                                   |
| ROCHESTER & PITTSBURGH COAL COMPANY - C  |                                   |
| (48) FRANK J. NEMETH - S                 |                                   |
| ROCHESTER & PITTSBURGH COAL COMPANY - C  |                                   |
| (49) DENNIS SAYDOR                       |                                   |
| (50) ELI H. SNYDER                       |                                   |
| (51) JAMES PENCOLA                       |                                   |
| (52) DEVT SHELLHAMMER                    |                                   |
| (53) MARK E. BAER                        |                                   |
| (54) NORTHERN ELK DEVELOPMENT            |                                   |
| (55) SAMUEL G. CLINE                     |                                   |
| WILLIAM MCINTIRE - C                     |                                   |
| (56) HAZEL ECKMAN                        |                                   |
| (57) KEVIN D. SILVIS                     |                                   |
| (58) JAMES M. HOLLENBAUGH                |                                   |
| (59) ROBERT E. KELLY                     |                                   |
| (60) ALAN KEITH HILL                     |                                   |
| (61) CONSOLIDATED GAS TRANSMISSION CORP. |                                   |
| (62) GLENN E. LEARN                      |                                   |
| (63) RODNEY D. CRAWFORD                  |                                   |
| (64) CAROLE L. HOLLAND                   |                                   |
| (65) Daniel B. Davis                     |                                   |
| (66) JOHN T. SICKON, JR.                 |                                   |
| (67) IRA GEORGE WEAVER                   |                                   |
| ANGELA BRUNO ESTATE - C                  |                                   |
| (68) GREG J. CURRY                       |                                   |
| (69) Andrew F. Smetlana                  |                                   |
| (70) Thelma Burg                         |                                   |
| (71) Adolph E. Mayuric                   |                                   |
| (72) Russell C. Kyler                    |                                   |
| (73) MAE T. CRAIG                        |                                   |
| (74) GRACE M. WALKER                     |                                   |
| (75) Daniel J. Bevelino                  |                                   |
| (76) Lawrence Cumberlandidge             |                                   |
| (77) Russell R. Roush                    |                                   |
| (78) Richard R. Rearick                  |                                   |
| (79) Leland C. Alkins                    |                                   |
| (80) LANCE R. CRISMAN                    |                                   |
| ALAN KEITH HILL - C                      |                                   |
| (81) DAVID P. GABRIELICH, JR.            |                                   |
| ALAN KEITH HILL - C                      |                                   |
| (82) Todd M. Frampton                    |                                   |
| (83) Alan D. Wilson                      |                                   |
| (84) James L. Oster                      |                                   |
| (85) John Onda                           |                                   |
| (86) Raymond Rodger                      |                                   |
| (87) Robert M. Knox                      |                                   |
| (88) David J. Corosso                    |                                   |
| (89) Hugh F. Stockidle                   |                                   |
| (90) John Onda                           |                                   |
| (91) KENT COAL MINING CO.                |                                   |
| (92) George Heber, Jr.                   |                                   |
| (93) Daniel Fine                         |                                   |
| (94) Terry W. George                     |                                   |
| (95) Richard Hooge                       |                                   |
| (96) TERRENCE M. HOSAC                   |                                   |
| (97) ROBERT A. ECKMAN                    |                                   |
| (98) SAMUEL G. CLINE                     |                                   |
| (99) HERMAN K. ECKMAN                    |                                   |
| (100) JOHN S. ROSS                       |                                   |
| (101) Daniel B. Steele                   |                                   |
| (102) Robert H. Houston                  |                                   |
| (103) HERMAN K. ECKMAN                   |                                   |
| (104) ROBERT M. BIRGE                    |                                   |
| (105) WARD E. BAYLOR                     |                                   |
| (106) SANFORD B. REARICK                 |                                   |
| (107) Alan C. Henderson                  |                                   |
| (108) John Peace                         |                                   |
| (109) PHT Mining Co.                     |                                   |
| (110) David R. Bruner                    |                                   |

**MAP NOTES / COMMENTS**

There will be no mining on adverse properties until T.J.S. Mining, Inc. controls the coal rights.

Property lines are based on county tax maps, not actual field survey.

There will be no mining within 100 feet of any active and/or abandoned UPPER FREEPORT surface and/or deep mine unless it is specifically noted in the mine permit application.

The locations of major gas lines (4" or greater) are based on gas company maps and have not been verified in the field.

A 400 foot barrier will be maintained along Crooked Creek in the northeast portion of the permit boundary.

**Map Legend**

Gas Well with 100 foot barrier	⊙
Background Sampling Point	▲
Water Monitoring Point	●
Spring	○
Water Well	○
Exploration Drill Hole	○
Occupied Structure	■
Unoccupied Structure	□
100 Foot Cover Line	—
Upper Freeport Coal Contour	—
Upper Freeport Coal Outcrop	—
Property Line	—
Intermittent Stream	—
Perennial Stream	—
Subsidence Boundary	—
Major (4"+) Gas Line	—
No Mining Zone	—
Old Permit Limit	—
Permit Boundary	—
Existing Mine Key	②
Yearly Mining Increment	③
Abandoned Mine Entry	④
Limit of Existing Mine Permit	⑤
Adverse Property	▨
Limit of Surface Activity Site	▨
Stream Protection (No Mining)	▨
Stream Protection (1st Mining)	▨
Existing Surface Mining	▨
Existing Deep Mining	▨

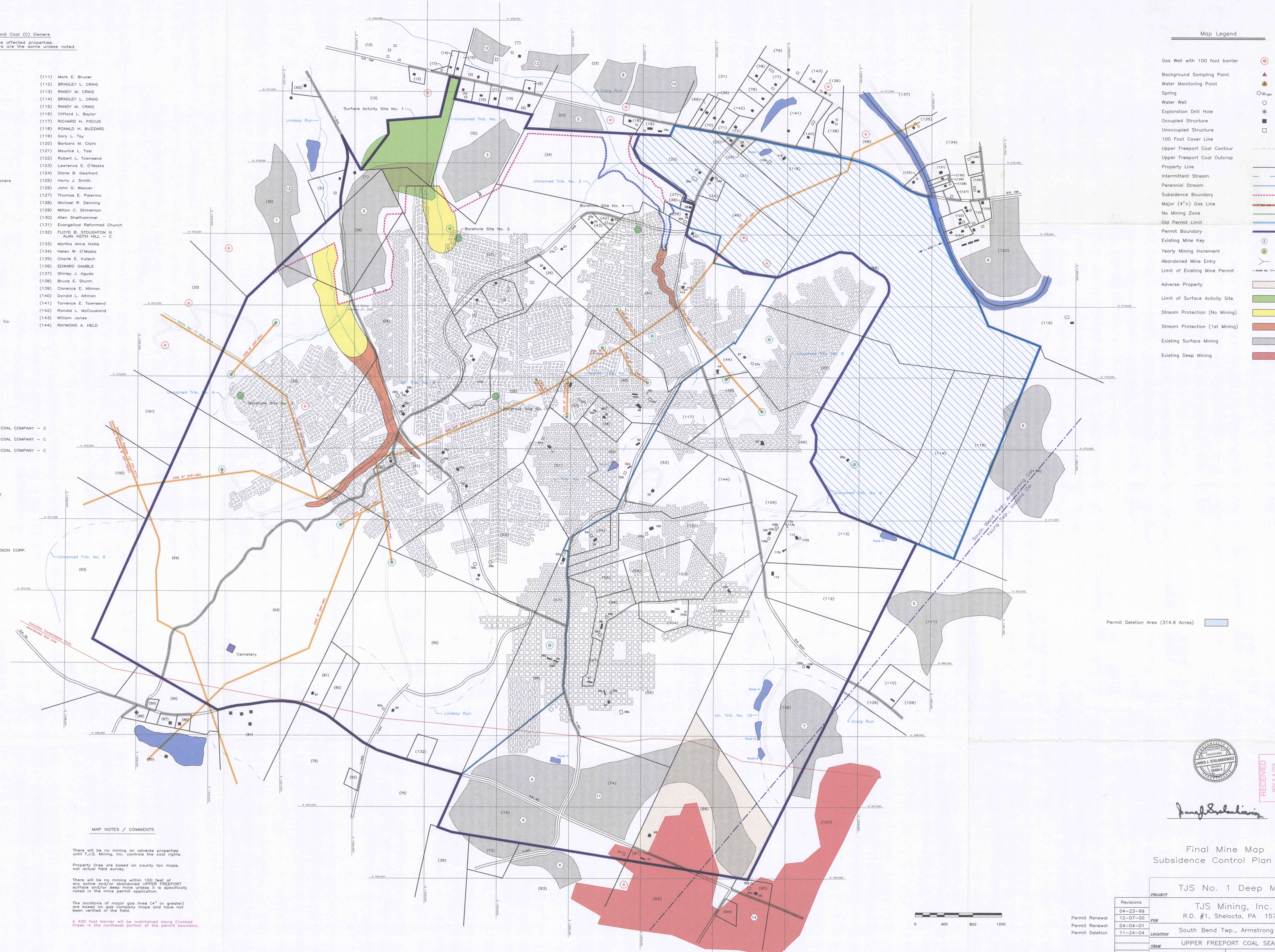

*Handwritten signature of the engineer/surveyor.*

**Final Mine Map  
 Subsidence Control Plan Map**

PROJECT		TJS No. 1 Deep Mine	
FOR		TJS Mining, Inc. R.D. #1, Shelocta, PA 15774	
LOCATION		South Bend Twp., Armstrong Co.	
SEAM		UPPER FREEPORT COAL SEAM	
DRAWN BY		JMO	DATE 10-10-97
SCALE		1" = 400'	DRAWING NO. Module 22.4
Revisions		04-23-99	
FOR		12-07-00	
PERMIT RENEWAL		04-04-01	
PERMIT RENEWAL		11-24-04	
PERMIT DELETION			