

John Long.

C. P. COLLINS,
CIVIL AND MINING ENGR.
JOHNSTOWN, PA.
March 2, 1907.

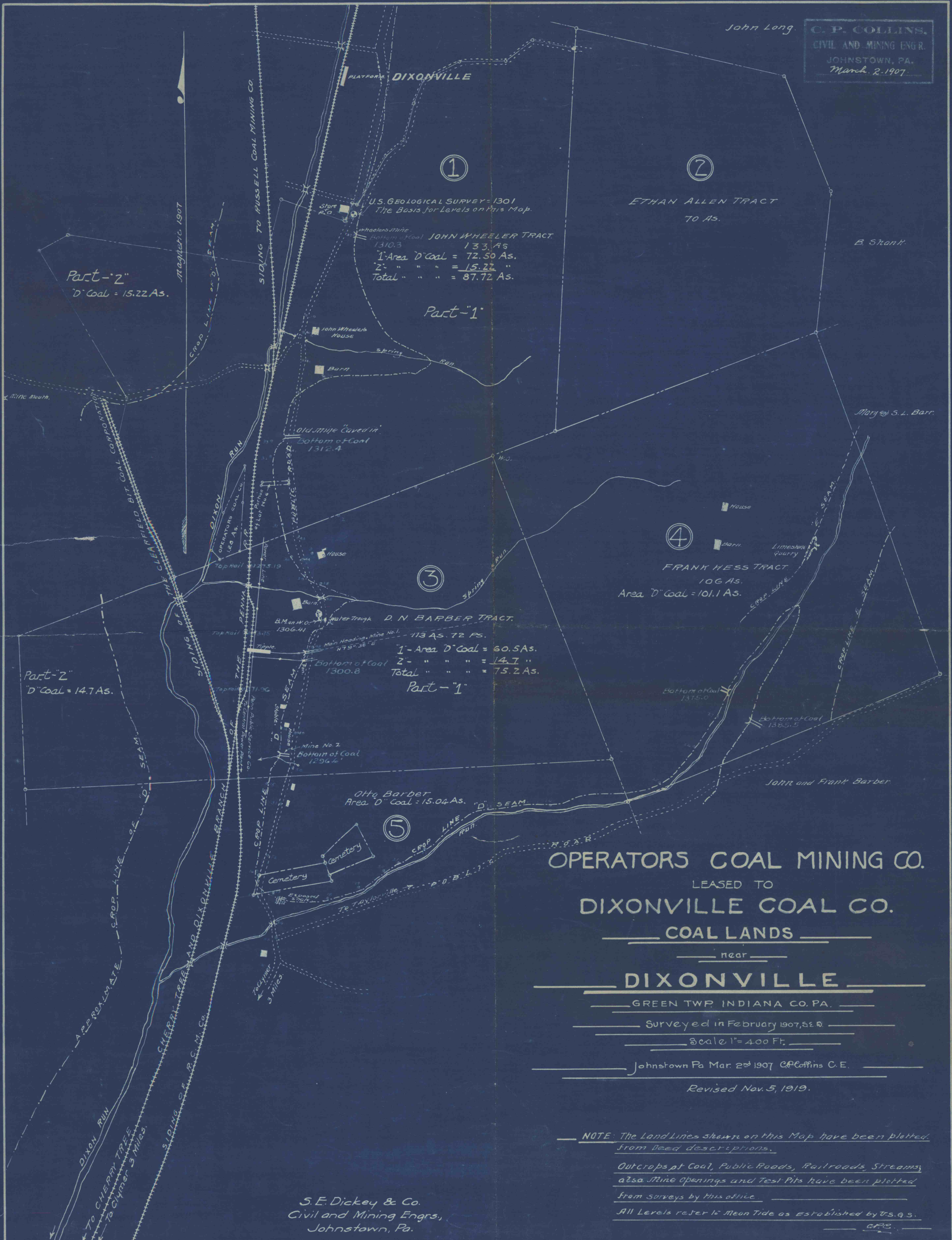

U.S. GEOLOGICAL SURVEY = 1301
The Basis for Levels on this Map.

Wheeler's Mine
Bottom of Coal 1310.3
1 Area D' Coal = 72.50 As.
2 " " " = 15.22 "
Total " " " = 87.72 As.

D. N. BARBER TRACT.
Main Heading, Mine No. 1 - 113 As. 72 Ps.
1 - Area D' Coal = 60.5 As.
2 - " " " = 14.7 "
Total " " " = 75.2 As.

FRANK HESS TRACT
106 As.
Area D' Coal = 101.1 As.

Otto Barber
Area D' Coal = 15.04 As.

Part-2
D' Coal = 15.22 As.

Part-2
D' Coal = 14.7 As.

OPERATORS COAL MINING CO.
LEASED TO
DIXONVILLE COAL CO.
COAL LANDS
near
DIXONVILLE

GREEN TWP. INDIANA CO. PA.

Surveyed in February 1907, 5 E 10

Scale 1" = 400 Ft.

Johnstown Pa Mar 2nd 1907 C.P. Collins C.E.

Revised Nov. 5, 1919.

NOTE: The Land Lines shown on this Map have been plotted from deed descriptions.
Outcrops of Coal, Public Roads, Railroads, Streams, also Mine Openings and Test Pits have been plotted from surveys by this office.
All Levels refer to Mean Tide as established by U.S.G.S.

S.E. Dickey & Co.
Civil and Mining Engrs.,
Johnstown, Pa.