

John Long.

C. P. COLLINS,
CIVIL AND MINING ENGR.
JOHNSTOWN, PA.
March 2-1907.

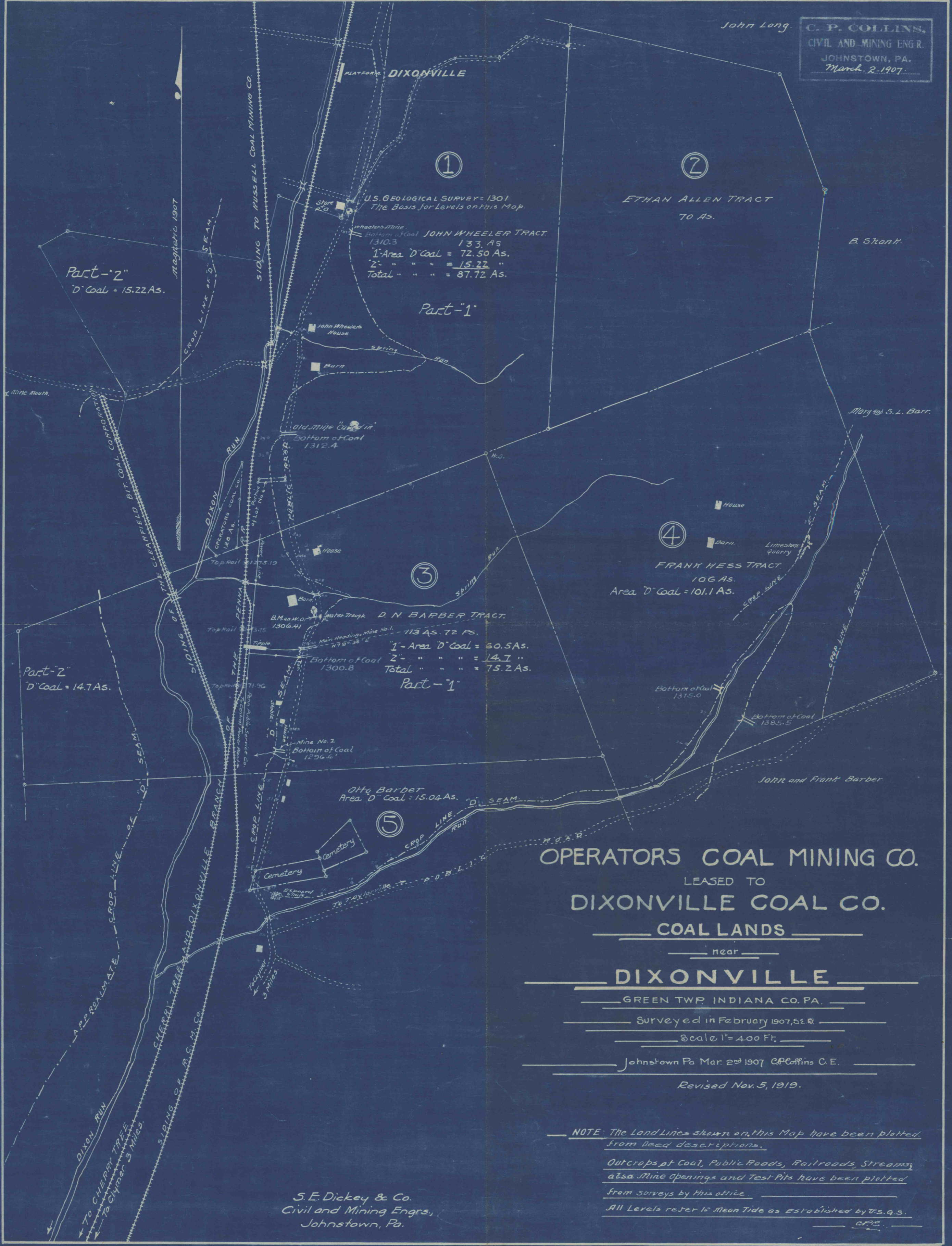

U.S. GEOLOGICAL SURVEY = 1301
The Basis for Levels on this Map.

Wheeler's Mine
Bottom of Coal 1310.3
133 AS
1 - Area D' Coal = 72.50 AS.
2 - " " " = 15.22 "
Total " " " = 87.72 AS.

Part-Z
D' Coal = 15.22 AS.

Part-1

ETHAN ALLEN TRACT
TO AS.

B. Stanton.

Mary S. L. Barr.

FRANK HESS TRACT
106 AS.
Area D' Coal = 101.1 AS.

D. N. BARBER TRACT.
113 AS. 72 FS.
1 - Area D' Coal = 60.5 AS.
2 - " " " = 14.7 "
Total " " " = 75.2 AS.

Part-Z
D' Coal = 14.7 AS.

Part-1

Otto Barber
Area D' Coal = 15.04 AS.

OPERATORS COAL MINING CO.
LEASED TO
DIXONVILLE COAL CO.
COAL LANDS

DIXONVILLE

GREEN TWP. INDIANA CO. PA.

Surveyed in February 1907, S.E. & O.

Scale 1" = 400 Ft.

Johnstown Pa. Mar. 2nd 1907 C.P. Collins C.E.

Revised Nov. 5, 1919.

NOTE: The Land Lines shown on this Map have been plotted from deed descriptions.

Outcrops of Coal, Public Roads, Railroads, Streams, also Mine Openings and Test Pits have been plotted from surveys by this office.

All Levels refer to Mean Tide as Established by U.S.G.S.

S. E. Dickey & Co.
Civil and Mining Engrs,
Johnstown, Pa.

DRAWER 1-A
SHEET 28