

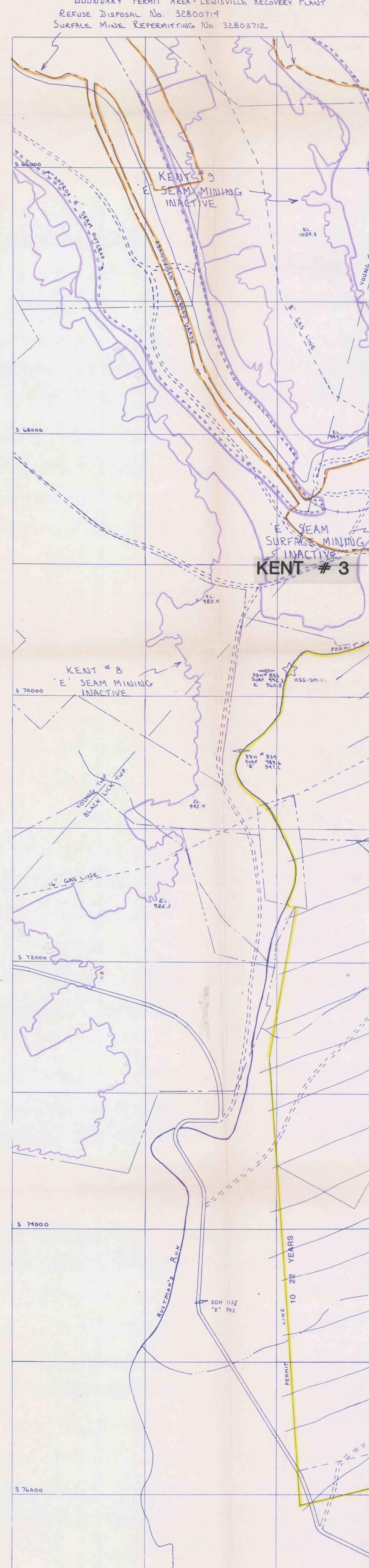

BOUNDARY PERMIT AREA-LEWISVILLE RECOVERY PLANT
 REUSE DISPOSAL NO. 32800714
 SURFACE MINE REPERMITTING NO. 32803712



LEGEND

(C)	ACTIVE GAS WELL	—	PERMIT BOUNDARY
(O)	INACTIVE GAS WELL	—	SUBSISTENCE CONTROL PLAN BOUNDARY
(W)	WATER WELL	—	NO MINING ZONE
(S)	SPRING	—	DEPTH OF COALS LINE
(F)	FLOW MEASUREMENT POINT	—	PRIOR DEEP AND SURFACE MINING
(R)	PERMANENT STREAM	—	PREDICTED AREA-BOUNDARY OF DRAIN
(I)	INTERMITTENT STREAM	—	MINE OPENINGS (TO BE REACHED)
(C)	PURIFICATION/COALING CANAL	—	DRAGGAGE (EARTH OR AIR)
(P)	POWER LINE (500 KVA or larger)	—	DOCK (SHALL BE REACHED)
(L)	COAL CONTAINMENT LINE	—	PROTECTED STRUCTURE
(H)	PAVE or LOW COAL LINE	—	UNPROTECTED STRUCTURE
(N)	NEW FURNACE LINE	—	DRILLING BUILT AFTER APRIL 1988
(S)	STATE ROAD	—	HAZARDOUS GROUNDWATER SAMPLE PT.
(U)	UNIMPROVED ROAD	—	HAZARDOUS GROUNDWATER MONITORING PT.
(M)	MAINE SURFACE OWNER	—	HAZARDOUS GROUNDWATER MONITORING PT.
(B)	BRIDGE	—	HAZARDOUS GROUNDWATER MONITORING PT.
(D)	DAVEY	—	HAZARDOUS GROUNDWATER MONITORING PT.
(R)	ROAD	—	HAZARDOUS GROUNDWATER MONITORING PT.
(S)	STREAM	—	HAZARDOUS GROUNDWATER MONITORING PT.
(T)	TOWNSHIP	—	HAZARDOUS GROUNDWATER MONITORING PT.
(C)	COUNCIL	—	HAZARDOUS GROUNDWATER MONITORING PT.
(S)	SETBACK	—	HAZARDOUS GROUNDWATER MONITORING PT.
(C)	COURTNEY	—	HAZARDOUS GROUNDWATER MONITORING PT.
(S)	SHAW	—	HAZARDOUS GROUNDWATER MONITORING PT.
(C)	COOPER	—	HAZARDOUS GROUNDWATER MONITORING PT.
(S)	SMITH	—	HAZARDOUS GROUNDWATER MONITORING PT.
(C)	COOPER	—	HAZARDOUS GROUNDWATER MONITORING PT.
(S)	SMITH	—	HAZARDOUS GROUNDWATER MONITORING PT.
(C)	COOPER	—	HAZARDOUS GROUNDWATER MONITORING PT.
(S)	SMITH	—	HAZARDOUS GROUNDWATER MONITORING PT.

HELIVETIA COAL COMPANY
 ENGINEERING / ENVIRONMENTAL COMPLIANCE DEPARTMENT

Operation: LUCERNE NO. 6 EXTENSION MINE Permit No: _____
 Township: CENTER & BLACKLICK County: INDIANA
 Coal Seam: UPPER FREEPORT Geologic Group: ALLEGHENY

EXHIBIT A - MINE DEVELOPMENT MAP

Date: 7-27-88 Revisions: _____ Approved By: _____ Date: 5-4-88 Scale: 1" = 400'

Drawn By: _____ Approved By / Date: _____ Drawing No: _____

1. THERE ARE NO IMPROVEMENTS EXCEPTED BY APRIL 1988 DEEDS.
 2. SURFACE PROPERTY LINES ARE SUPPLEMENTED BY COPY TO THE SUBSISTENCE MAP AND ARE NOT BASED ON ACTUAL SURVEY.
 3. ALL COALS TO BE MINED BY THIS MINE ARE OWNED BY HELIVETIA COAL COMPANY EXCEPT AS NOTED.
 4. NO AREA HAS BEEN BELIEVED UNLAWFULLY FORWHELD.
 5. NO MINE ADJACENTS HAVE BEEN CONTACTED.
 6. THERE ARE NO UNLAWFULLY BELIEVED AREAS TO BE AFFECTED BY SURFACE OPERATIONS AND FACILITIES.