

N 288,000

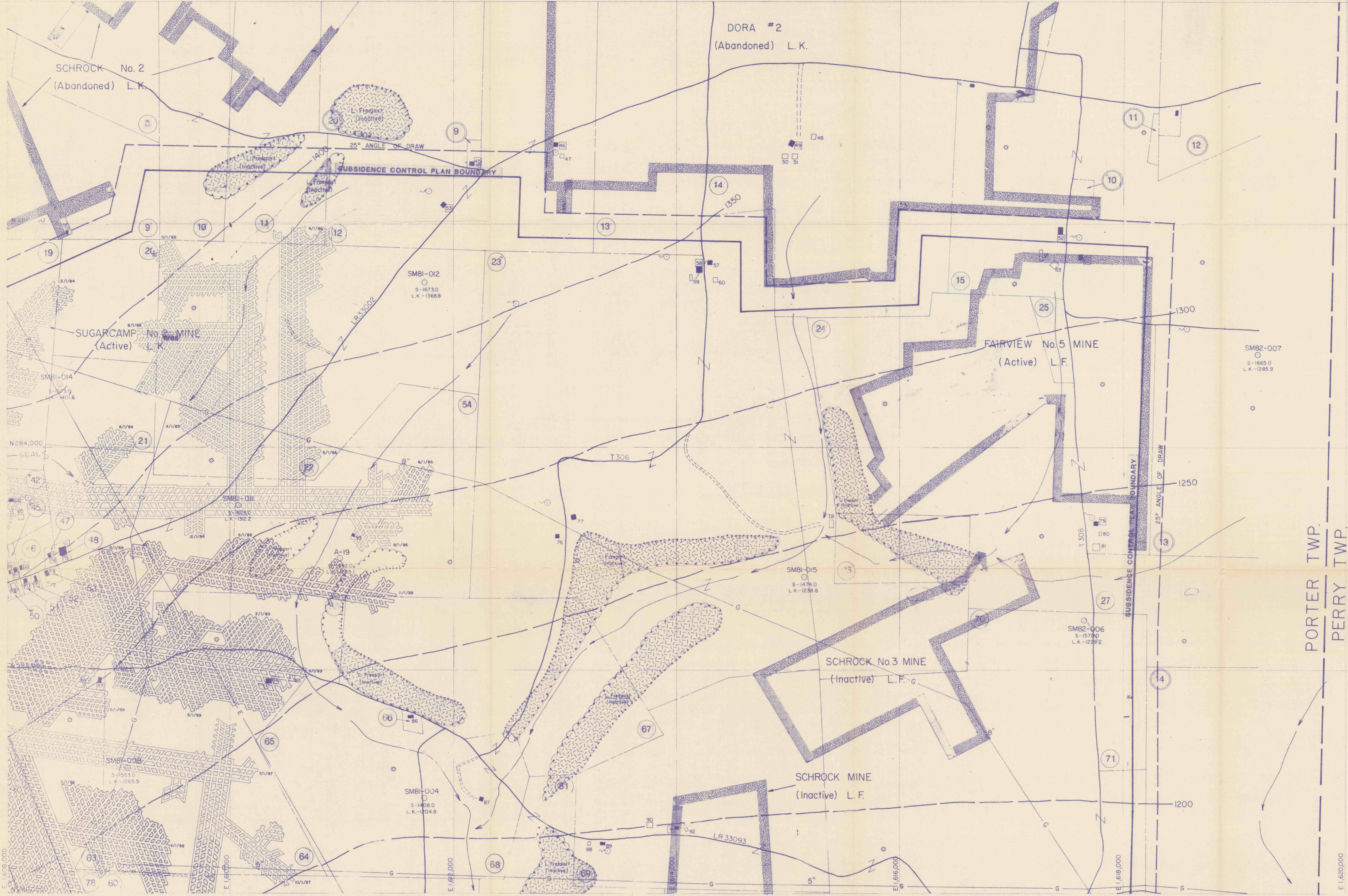

PORTER TWP.  
PERRY TWP.

FINAL MINE MAP

PORTER TWP., JEFFERSON CO. - 1,381 Acres

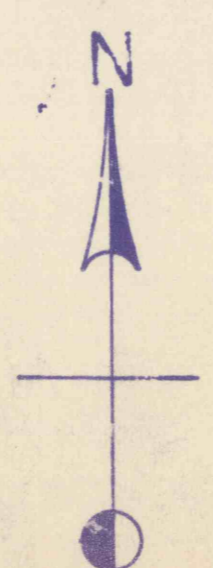

match to Sheet 4

Professional Engineer Seal for Joseph P. Kalynduk, Commonwealth of Pennsylvania, License No. PE 94323 E.

*Joseph P. Kalynduk*  
5-3-93

**Stanford**

**Doverspike Bros. Coal Co.**  
R.D. 4 Box 271 Pymatuning, Pa. 16787

**SUGARCAMP NO. 2**

SHEET No. 2 of 4 SCALE 1" = 400'

**EXHIBIT "A"**

<p>PERMIT AREA</p> <p>UNDERGROUND WORKINGS</p> <p>TOWNSHIP BOUNDARY</p> <p>COUNTY BOUNDARY</p> <p>TEST BOREHOLE</p> <p>CROP LINES</p> <p>COAL CONTOURS</p> <p>SURFACE WORKINGS</p> <p>MINE OPENINGS, Not Sealed</p> <p>MINE OPENINGS, Sealed</p> <p>PROPERTY LINES</p> <p>PRE 1966 DWELLINGS</p>	<p>MINING SEQUENCE 1-for-1-2</p> <p>POST 1966 DWELLINGS</p> <p>CEMETERIES</p> <p>STRUCTURES</p> <p>MAJOR ELECTRIC LINES</p> <p>PIPELINES</p> <p>GAS WELLS</p> <p>WATER WELLS</p> <p>STREAMS</p> <p>LAKES or PONDS</p> <p>SPRINGS</p> <p>WATER TREATMENT FACILITIES</p> <p>CONTIGUOUS PROPERTY</p>
--	---