

LEGEND

- PROPERTY LIMIT
- AREA TO BE MINED
- MINED OVER
- GRAVITY DRAINAGE
- SUNNYSIDE COAL CO. } ABANDONED
- HIGHLAND COAL CO. }
- ROCKY CREEK COAL CO. }

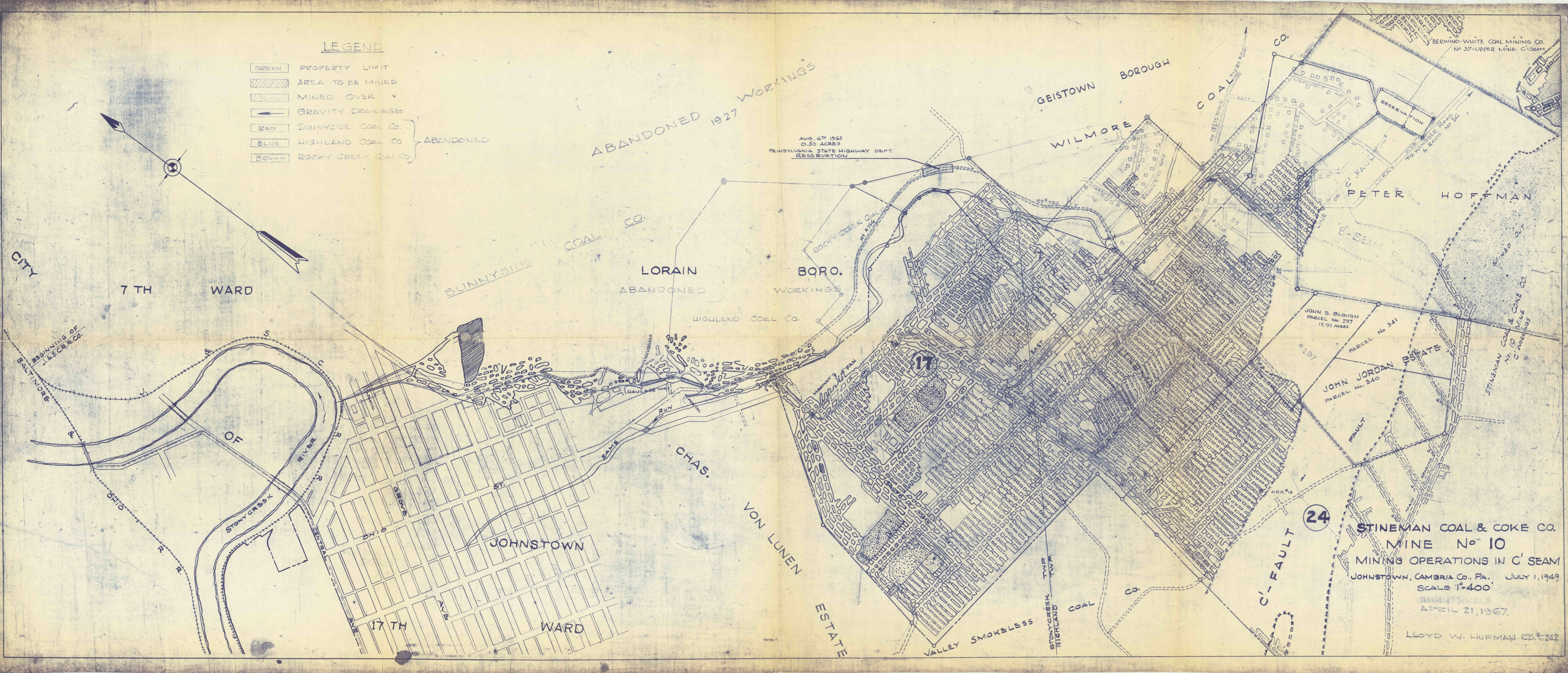
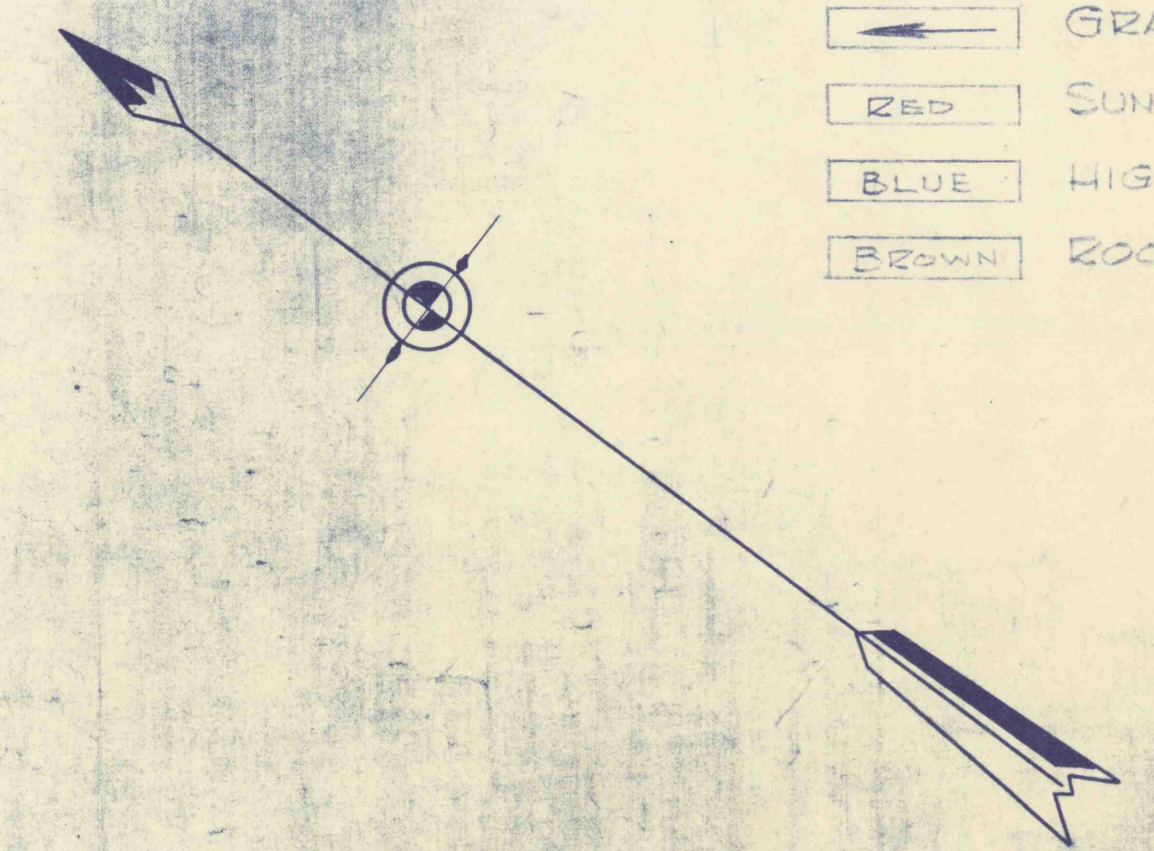

STINEMAN COAL & COKE CO.
MINE NO. 10
 MINING OPERATIONS IN C' SEAM
 JOHNSTOWN, CAMBRIA CO., PA. JULY 1, 1949
 SCALE 1"=400'
 APRIL 21, 1967.

LLOYD W. HUFMAN ES. 6242