

MAP OF PROPERTY
OF THE
HENRIETTE COAL MINING CO.
SHOWING ADJOINERS.

Scale: 1 inch = 400 feet

J. S. Sullyman & Co
Engineers

ADAMS TOWNSHIP, GAMBIA COUNTY, PENNA.

SEE SIMPLE OWNERSHIP OUTLINED IN YELLOW
GOAL OWNERSHIP OUTLINED IN RED

LEASED AREA OUTLINED IN PURPLE

GOAL MINED REMAINING UNMINED = 165,000 TONS

GOAL LEASED " " = 120,000 TONS

3' OR LOWER KITTANNING SEAM ONLY IS KNOWN TO BE WORKABLE
ON THIS PROPERTY - AVERAGE THICKNESS OF 3' SEAM - 3'-5'
3' SEAM DOES NOT OUTCROP ON PROPERTY.

MAGNETIC MERIDIAN OF 1895

BERMIND WHITE COAL MINING CO

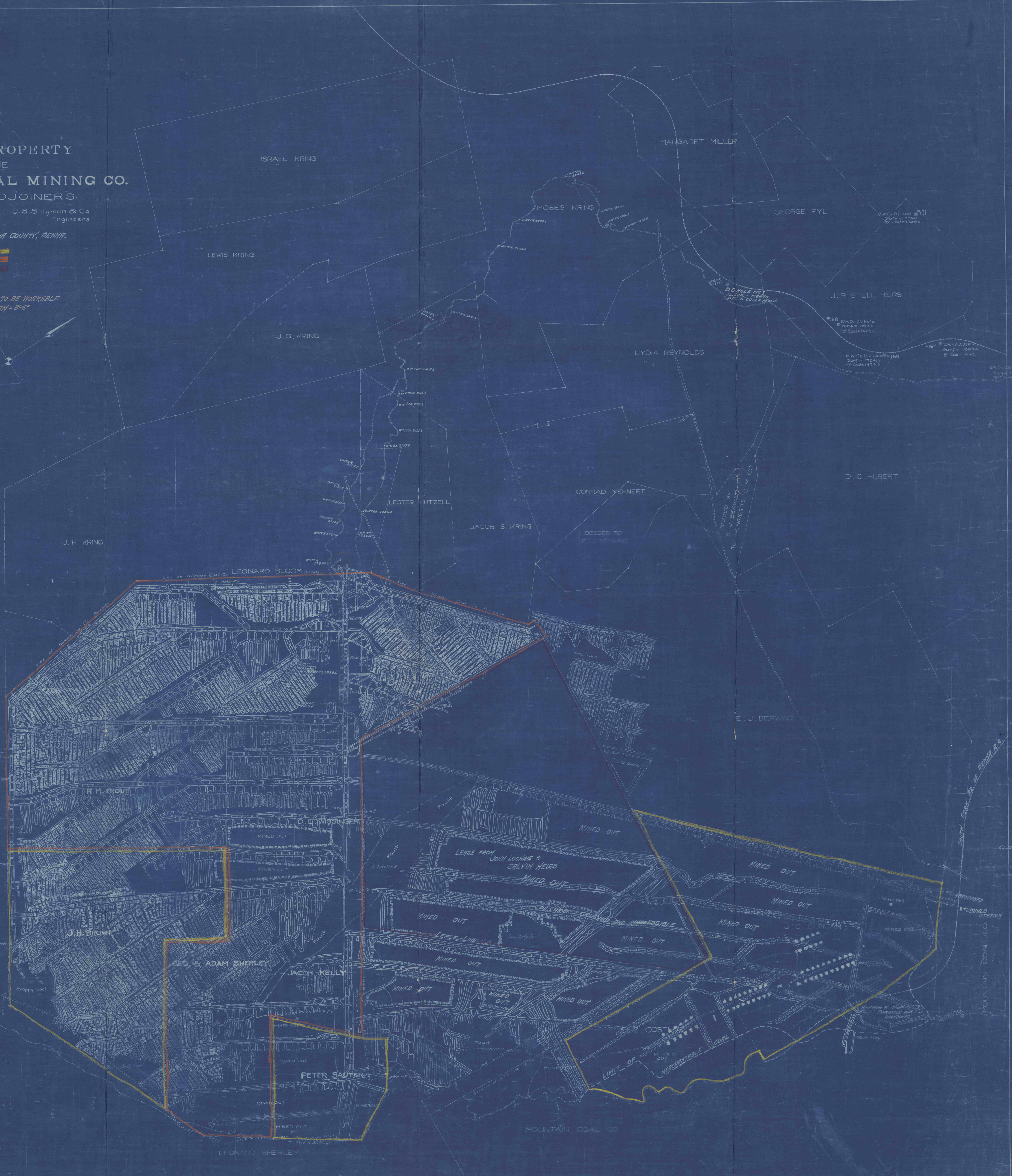

YELLOW RUN STATION
MOUNTAIN COAL CO