

KEY TO PREVIOUSLY MINED AREAS						
MAP KEY	TYPE	STATUS	OPERATOR	PERMIT NO.	DATE	COAL SEAM
A	SURFACE	ACTIVE	DOVERSPRINK BROS. COAL CO.	33830105	7/07	L.F.
B	SURFACE	INACTIVE	GLUE MINE CO., INC.	33820118	7/07	L.F., U.K., M.A.
C	SURFACE	INACTIVE	M.B. ENERGY, INC.	33820134	7/07	U.K., M.A.
D	SURFACE	INACTIVE	PARK COAL CO., INC.	33820114	7/07	L.K., M.A., U.K.
E	SURFACE	INACTIVE	PARK COAL CO., INC.	38758813	7/07	U.K.
F	SURFACE	INACTIVE	PARK COAL CO., INC.	38758813	7/07	L.K., M.A.
G	SURFACE	INACTIVE	CHARLES BETHAM	18579	7/07	L.K., M.A.
H	SURFACE	NOT ISSUED	VALLEY MINING	NOT ISSUED	7/07	L.F.
I	SURFACE	ABANDONED	HAMILTON MINING CO.	36260091	7/07	L.F.
J	SURFACE	ABANDONED	JOHN PHILLIPS	ABANDONED	7/07	L.F.
K	SURFACE	ABANDONED	GLEN IRVIN CORP.	38748940	7/07	L.F.
U	UNDERGROUND	INACTIVE	DOVERSPRINK BROS. COAL CO.	33841303	7/07	L.K.
V	UNDERGROUND	ABANDONED	W.P.A. 5-7-8	W.P.A.	7/07	U.K.
W	UNDERGROUND	ABANDONED	LANEY COAL MINING CO.	9011	7/07	L.F.
X	UNDERGROUND	ABANDONED	PERRY HILLS COAL CO.	W.P.A. 5-7-8	7/07	L.F.
Y	UNDERGROUND	NOT MINED	VALLEY MINING CO., INC.	3656031	7/07	L.F.
Z	UNDERGROUND	ABANDONED	PANTRY COAL CO.	W.P.A. 5-7-8	7/07	L.F.
M	SURFACE	ABANDONED	UNKNOWN	UNKNOWN	7/07	UNKNOWN

MINE OWNERSHIP			
COUNTY	PERMIT NO.	DATE	OWNER
JEFFERSON	33830105	7/07	DOVERSPRINK BROS. COAL CO.
JEFFERSON	33820118	7/07	GLUE MINE CO., INC.
JEFFERSON	33820134	7/07	M.B. ENERGY, INC.
JEFFERSON	33820114	7/07	PARK COAL CO., INC.
JEFFERSON	38758813	7/07	PARK COAL CO., INC.
JEFFERSON	18579	7/07	CHARLES BETHAM
JEFFERSON	36260091	7/07	HAMILTON MINING CO.
JEFFERSON	38748940	7/07	GLEN IRVIN CORP.
JEFFERSON	33841303	7/07	DOVERSPRINK BROS. COAL CO.
JEFFERSON	W.P.A.	7/07	W.P.A. 5-7-8
JEFFERSON	9011	7/07	LANEY COAL MINING CO.
JEFFERSON	W.P.A. 5-7-8	7/07	PERRY HILLS COAL CO.
JEFFERSON	3656031	7/07	VALLEY MINING CO., INC.
JEFFERSON	W.P.A. 5-7-8	7/07	PANTRY COAL CO.
JEFFERSON	UNKNOWN	7/07	UNKNOWN

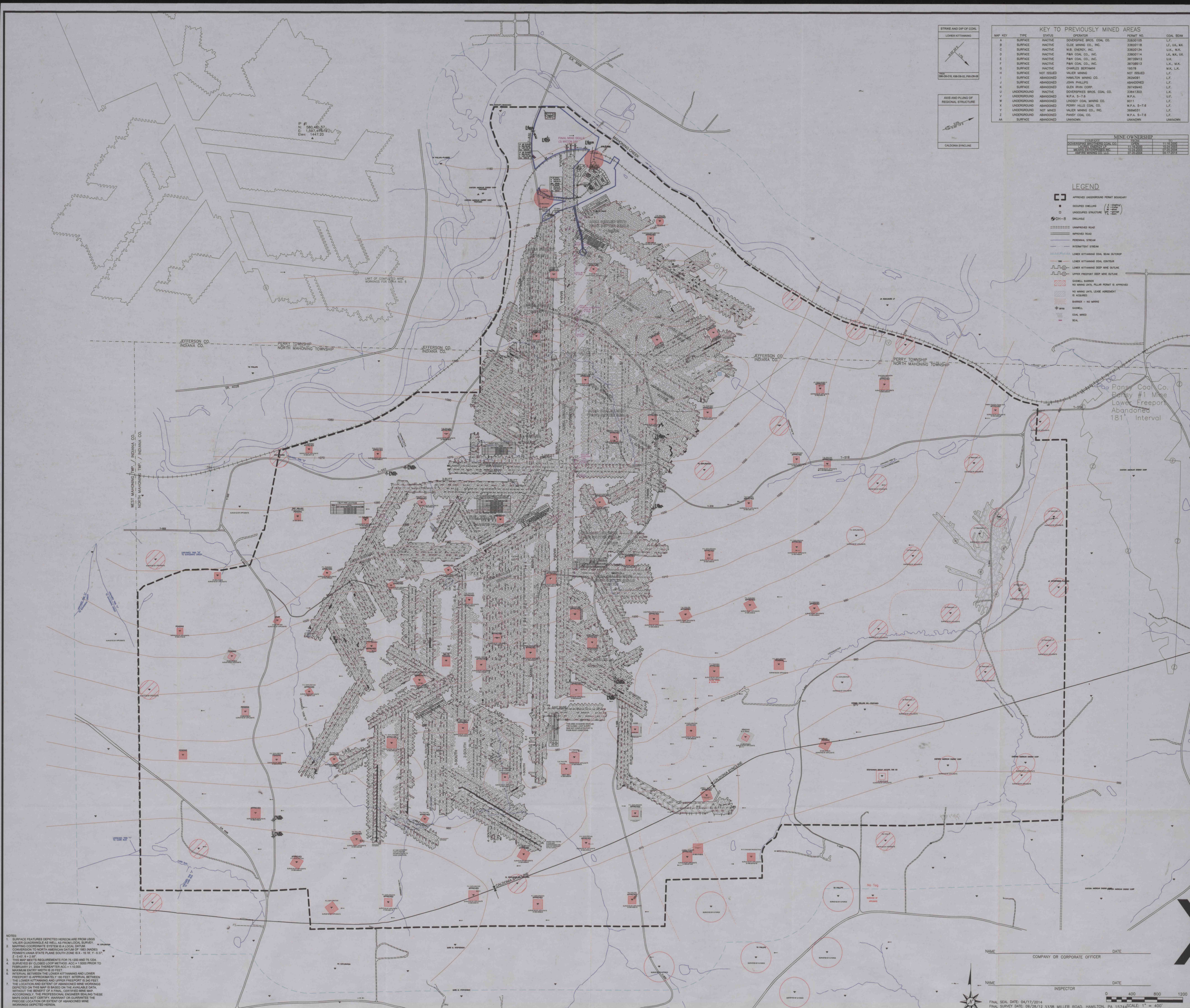
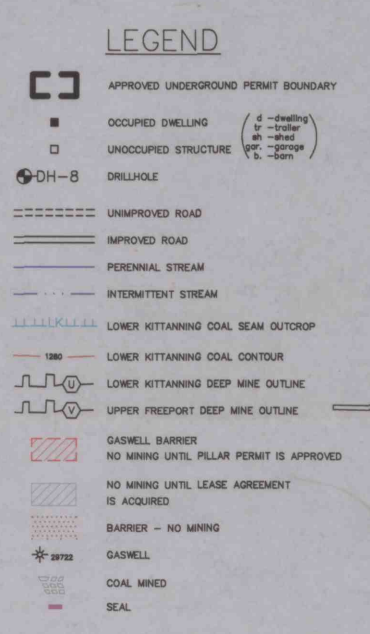

NOTES:
 1. SURFACE FEATURES DEPICTED HEREON ARE FROM USGS 7.5-MINUTE QUADRANGLES AS WELL AS FROM LOCAL SURVEY.
 2. MAPPING COORDINATE SYSTEM IS A LOCAL DATUM CONVERSION TO NORTH AMERICAN DATUM OF 1983 (NAD83) PENNSYLVANIA STATE PLANE SOUTH ZONE IS X = 15.16, Y = 6.37, Z = 2.43, R = 2.35.
 3. THIS MAP MEETS REQUIREMENTS FOR 7.5, 15.0 AND 7.5, 15.0.
 4. SURVEYED BY CLOSED LOOP METHOD, ACC. ± 1:5000 PRIOR TO FEBRUARY 21, 2014. THIS MEETS ACC. ± 1:10000.
 5. MAXIMUM ENTRY WIDTH IS 30 FEET.
 6. INTERVAL BETWEEN THE LOWER HITTING AND LOWER FREEPORT IS APPROXIMATELY 180 FEET. INTERVAL BETWEEN THE LOWER HITTING AND UPPER FREEPORT IS 180 FEET.
 7. THE LOCATION AND EXTENT OF ABANDONED MINE WORKINGS DEPICTED ON THIS MAP IS BASED ON THE AVAILABLE DATA. WITHOUT THE BENEFIT OF A FINAL CERTIFIED MINE MAP ACCORDINGLY, THE PROFESSIONAL ENGINEER SEALING THESE MAPS DOES NOT CERTIFY, WARRANT OR GUARANTEE THE PRECISE LOCATION OR EXTENT OF ABANDONED MINE WORKINGS DEPICTED HEREON.

MAP PREPARED BY:
Force
 Engineering Services, LLC
 1630 PHILADELPHIA STREET, INDIANA, PA 15701
 PHONE: (724) 901-8160 FAX: (724) 901-8888

DRAWN BY:
 NEG
 SCALE:
 1" = 400'
 DRAWING NO.
 1 OF 1

NAME _____ DATE _____
 COMPANY OR CORPORATE OFFICER

NAME _____ DATE _____
 INSPECTOR

0 400 800 1200
 SCALE: 1" = 400'

FINAL SEAL DATE: 04/17/2014
 FINAL SURVEY DATE: 08/28/12 3338 MILLER ROAD, HAMILTON, PA 15746

75.1204 FINAL MINE MAP
AMFIRE Mining Company, LLC
DORA 8 MINE
 CMAP 33871301 MSHA-DP 32-08704
 LOWER HITTING COAL SEAM
 NORTH MAHONING & PERRY TOWNSHIPS
 INDIANA & JEFFERSON COUNTY, PENNSYLVANIA

DATE
 05/06/2014